

**SQUIRREL RIVER PINES STATE NATURAL AREA
C11 STAND 1
PERPETUAL PINES - 41 ACRES
TOWN OF MINOCQUA T39N, R5E, SECTIONS 16 & 21**

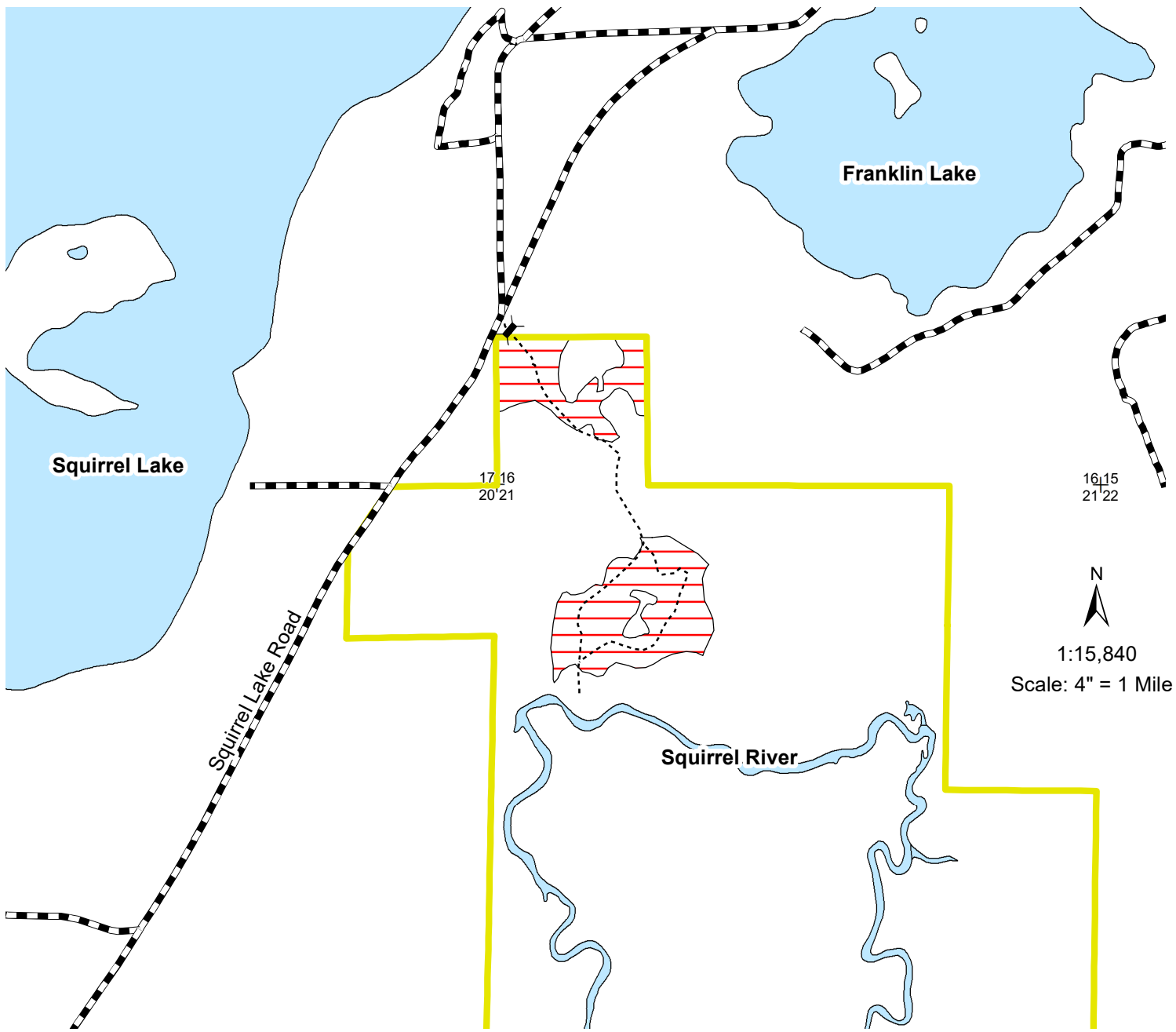

N
1:15,840
Scale: 4" = 1 Mile

- Legend**
- + Section Corner
 - ◆ Gates
 - ▭ Squirrel River Pines SNA
 - Town and County Roads
 - Woods Roads
 - ▨ C11 Stand 1
 - ▭ Lakes and Rivers

Compartment 11 Stand 1 (41 Acres) is a large sawlog size stand of red and white pine with an origin year of 1923. This stand will undergo a thinning and utilize gap creation to maintain the health and vigor of the remaining stems while also promoting regeneration.

A small (10 acre) growing season prescribed burn is anticipated to be conducted prior to harvest in the southern unit.