

# Northern Highland - American Legion State Forest

## C30 Stands 5, 24, 28 & 31

### South River 91 Acres

#### Town of Lake Tomahawk T38N, R7E, Sections 12, 13 & 24

#### NHAL - SF Master Plan Mgmt Area 6 - Oneida Sandy Plains - Forest Production

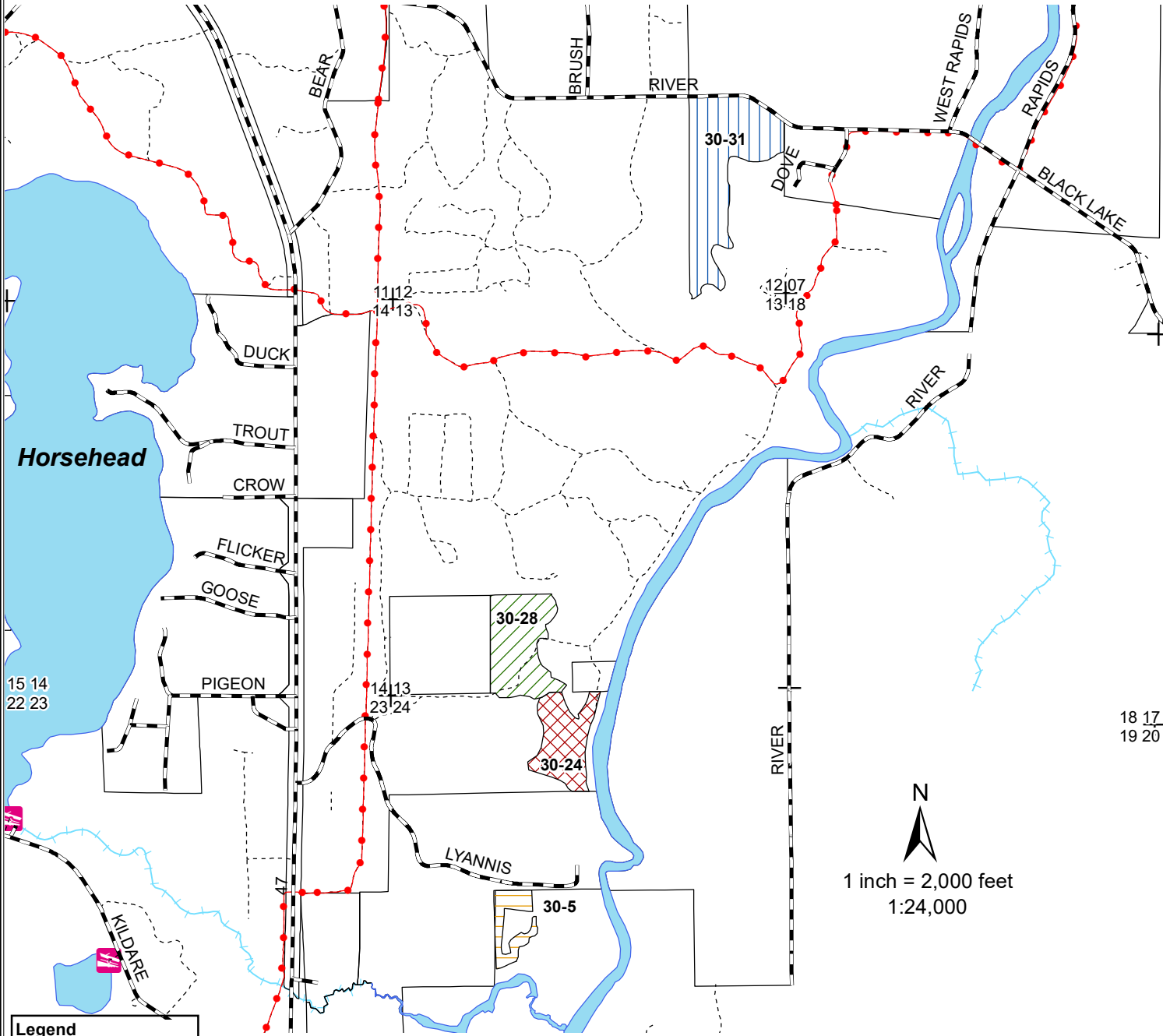

#### Legend

- ✚ Section Corner
- Boat Landing
- Town and County Roads
- Snowmobile Trails
- Woods Roads
- Rivers and Streams
- C30 Stand 5
- C30 Stand 24
- C30 Stand 28
- C30 Stand 31
- Lakes

#### Area 6: Oneida Sandy Plains - Forest Production

**C30 Stand 5 (7 Acres)** is a jack pine plantation with an origin year of 1968. This stand will be regenerated by utilizing a clearcut and replanting.

**C30 Stand 24 (17 Acres)** is a small sawlog size scrub oak stand that underwent a shelterwood harvest in 2016. During this entry the stand is scheduled for an overstory removal.

**C30 Stand 28 (25 Acres)** is an aspen stand with an origin year of 1978. This stand will be regenerated using a coppice with standards.

**C30 Stand 31 (42 Acres)** is an aspen stand with an origin year of 1980. This stand will be regenerated using a coppice with standards.