

**Northern Highland - American Legion State Forest  
C232H Stands 2, 3, 5, 6, 10 and 11  
Another Snort 189 Acres  
Town of Boulder Junction T42N, R6E, Section 31  
NHAL - SF Master Plan Mgmt Area 3 - Vilas Sandy Plains North - Forest Production**

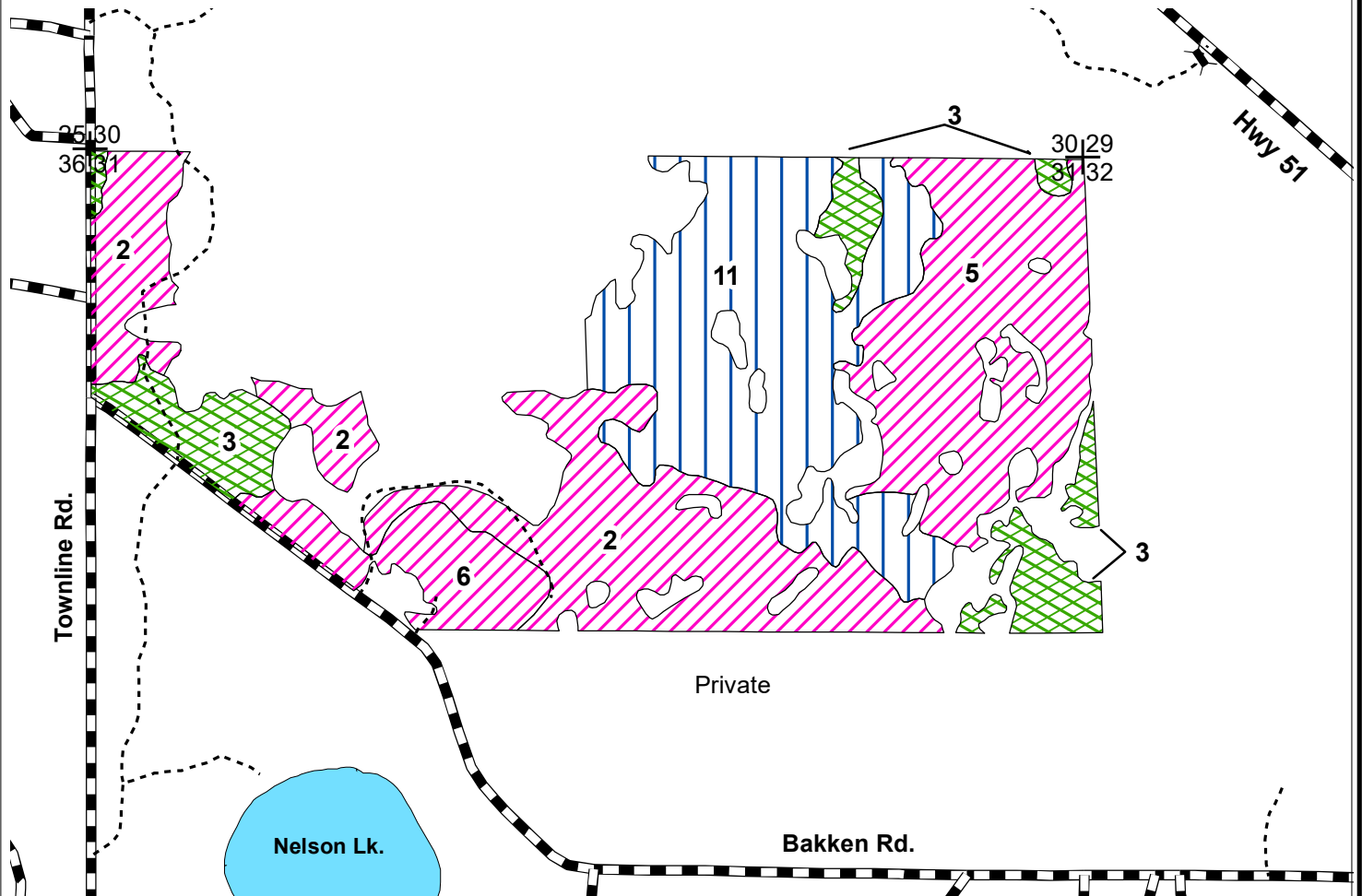

N  
  
 Scale: 4" = 1 Mile  
 1:15,840



Map produced by  
Joe Renik, 04/23

This map is not a survey  
of the actual boundary of  
any property this map depicts.

**Legend**

- Highways and Town Roads
- Woods Roads
- Section Corner
- Survey Marker
- Gates
- Lakes
- White Pine
- Red Pine
- Aspen

**C232 Stand 2 (53 acres) Red pine origin 1886.** This stand was last thinned in 1980 and has very little pine regeneration present. Prescription is to rotate the stand followed by planting red pine or red/white pine mix.

**C232 Stands 3 and 10 (22 acres) White pine origin 1904.** These variably stocked stands will be thinned to promote health and vigor of remaining mixed pine species.

**C232 Stand 5 (43 acres) Red pine origin 1965.** This is a partially failed plantation with aspen distributed throughout the stand. The stand will be thinned and aspen will be removed.

**C232 Stand 6 (14 acres) Red pine origin 1945.** This well stocked pine plantation will thinned for the third time.

**C232 Stands 11 (57 acres) Aspen origin 1980.** Originally part of a larger block of aspen, this poor quality aspen stand will be regenerated using a coppice with standards. This harvest will provide aspen age class diversity.