

Northern Highland - American Legion State Forest  
C235H Stands 1, 2, 8 & 12

Manitou Boomerang - 52 Acres

Town of Manitowish Waters T42N, R5E, Sections 1, 2 & 12

Town of Winchester T43N, R5E, Section 36

NHAL - SF Master Plan Mgmt Area 3 - Vilas Sandy Plains North - Forest Production

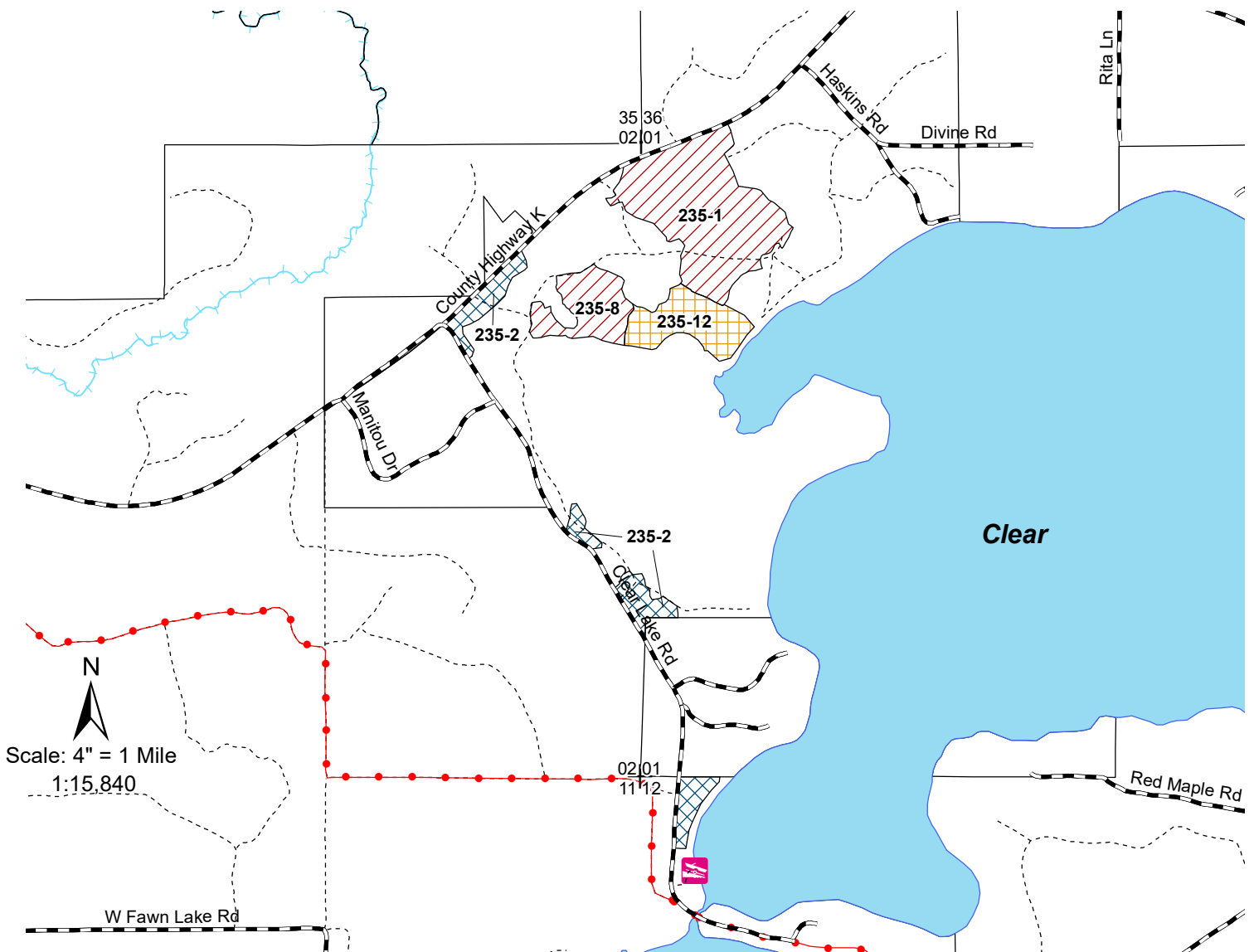

Scale: 4" = 1 Mile  
1:15,840

**Legend**

- ⊕ Section Corner
- Boat Landing
- Town and County Roads
- Snowmobile Trails
- Woods Roads
- ~ Rivers and Streams
- Lakes
- Stand 12 BW
- Stand 8 PR
- Stand 2 PW
- Stand 1 PR

**Area 3: Vilas Sandy Plains North**

**C235 Stand 1 (26 Acres)** is a small sawlog size red pine stand with an origin year of 1921. This stand is scheduled for a thinning to improve spacing and health of the remaining stems,

**C235 Stand 2 (10 acres)** is a large sawlog size white pine stand with an origin year of 1921. This stand is scheduled for a thinning to improve spacing and health of the remaining stems,

**C235 Stand 8 (8 Acres)** is a 29 year old red pine plantaiton that is scheduled to receive a thinning to improve spacing and vigor for the remaining stems.

**C235 Stand 12 (8 Acres)** is a white birch stand with a component of northern hardwoods. This stand is scheduled to undergo a seed tree harvest to regenerate the stand.