

**WISCONSIN
DEPARTMENT OF NATURAL RESOURCES
TIMBER SALE
TRACT 23-23 FERAL WOLF PINE
T38N R7E SECTIONS 24, 25, 26, 35 & 36
HARVEST ACRES: 115**

N
Scale: 4" = 1 Mile
1:15,840

Legend

-  Section Corner
-  Gates
-  Boat Landing
-  Canoe Campsite
-  Blue Line
-  Red Line
-  Pink Flag Line (if Needed)
-  Woods Roads
-  Snowmobile Trails
-  Highways and Town Roads
-  Conifer Saplings
-  Lowland Area/Swamp Conifer
-  Creek
-  Lakes

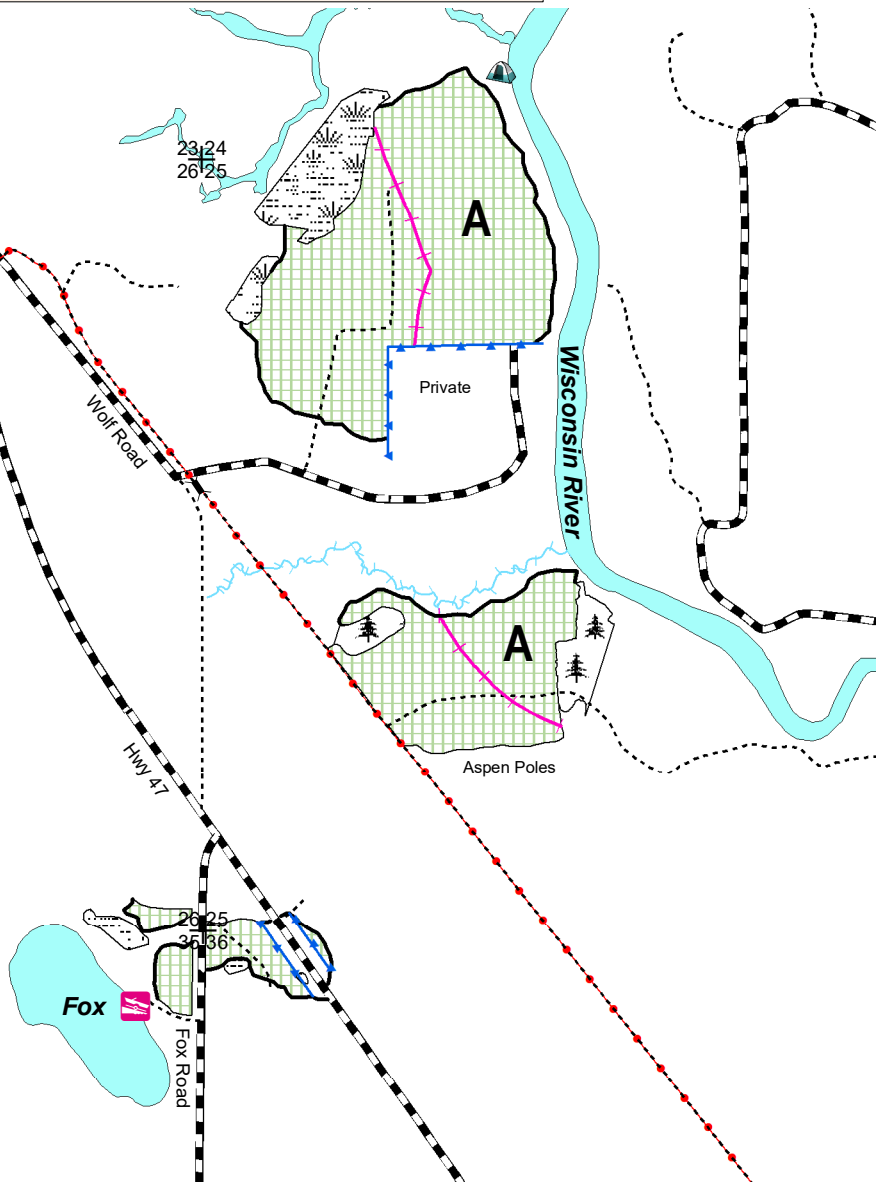

NOTE: WDOT ROW There is a potential of 220 tons, available by WDOT, adjacent to this sale. Contact Randy Frisch (715) 365-5748 or (715) 459-0567 Randal.Frisch@dot.wi.us

In ZONE A, all equipment use and operations is allowed September 15 - May 15.

 Pine Thinning Area (115 Acres): Cut all trees marked with orange paint.

All stands are within Mgmt. Area 6:
Oneida Sandy Plains - Forest Production Area

This map is not a survey of the actual boundary of any property this map depicts.

**Note: This is a LUMP SUM SALE.
Contract expires June 30, 2026**



Map produced by
Jim Wetterau, 02/24

NH-ALSF TRACT 23-23

Feral Wolf Pine

The cutting area is approximately 115 acres.

All trees that will yield one or more 100-inch sticks to the minimum top diameter will be cut and utilized.

Contract expires 06/30/2026

ESTIMATED VOLUME (TONS)

MINIMUM TOP DIAMETER

<u>SPECIES</u>	<u>4"</u>
White Pine ¹	210
Red Pine ²	2340
Spruce ³	200
Mixed Hardwood ⁴	15

Total Minimum Bid Value \$ 50,279.50

¹Volume includes 8 MBF of potential logs.

²Volume includes 169 MBF of potential logs.

³Volume includes 99% Norway spruce and 1% balsam fir. Volume includes 19 MBF of potential spruce logs.

⁴Volume includes 50% red maple, 30% red oak, 10% white birch and 10% aspen.

Total sale volume equates to 24.04 tons/acre or 10.84 cords/acre.

Special Conditions:

1. **LUMP SUM SALE.** One-third of the total lump sum bid value must be paid prior to starting. The remaining amounts will be paid as each third of the sale area is completed, with the final payment made before the last 1/3 of the acreage is harvested. All trees are to be pre-approved prior to cutting if not marked or designated to be cut. Any residual trees cut, pushed over or damaged are to be decked, scaled and billed for in addition to lump sum bid value. Any trees cut without approval will subject the contractor to penalties and fines.
2. Do not harvest or operate machinery within 15 feet of any wetland. All other low ground areas to be operated in during dry or frozen ground conditions to prevent rutting. Cutting must be concurrent for all species to be harvested.
3. Biomass harvesting is not allowed. Do not cut, knock down, or utilize any dead standing snags.
4. No tops or slash allowed in any grass opening or within any wetland. Slash must remain within the plantation area. Slash within 50 feet of the town roads, highways and snowmobile trail must be lopped and scattered within 2 feet of the ground and pulled back into the sale area at least 10 feet from the edge of the road right-of-way and the snowmobile trail.
5. Snowmobile trail must be kept free of debris, snow covered in winter, and always left in good condition for vehicle traffic. All woods roads must be repaired to pre-harvest conditions before the start of each snow season. All landings and any new woods roads must be approved prior to sale start up.
6. In ZONE A, all equipment use is allowed Sept. 15 – May 15. The administering Forester will ribbon area delineating Zone A, if necessary. All pine products cut between April 1 and September 1 must be removed from the sale area within three weeks from time of cutting. Pine products cut during the remainder of the year must be removed prior to April 1 of each year.
7. If the contract is to be worked on during multiple time periods a mid-contract "pull-off" inspection meeting will be required. One-week notice shall be given by the contractor prior to moving equipment off-site. During the "pull-off" inspection, provisions needing attention will be documented. The contractor at that time can decide to remedy them before pulling equipment off or rectify them when moving back onto the site. If the latter is chosen, documented items shall be addressed before harvesting can continue.

