

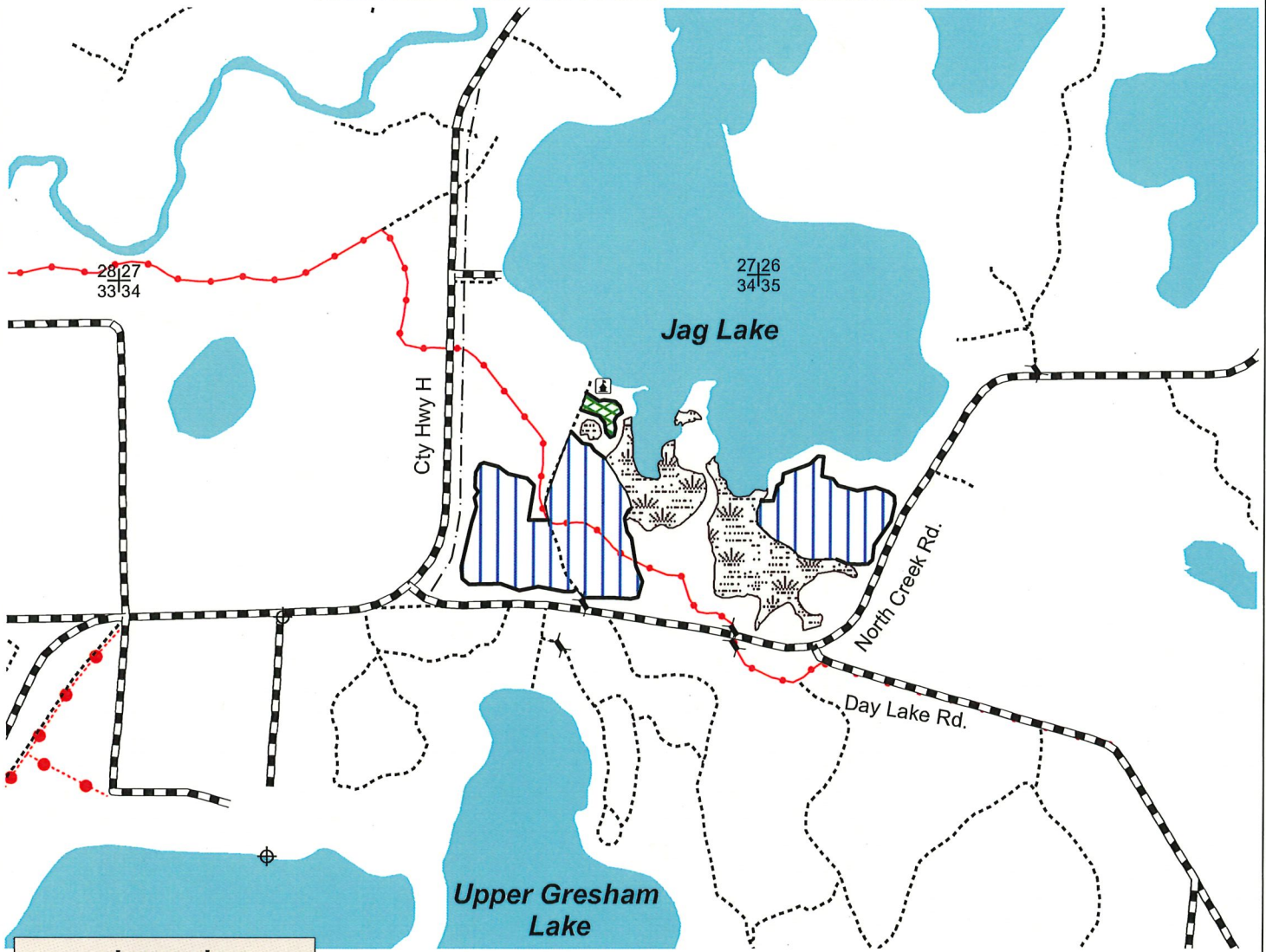

**WISCONSIN  
DEPARTMENT OF NATURAL RESOURCES  
TIMBER SALE  
TRACT 23-24 NOT ANOTHER JAG  
T42N R6E SECTIONS 34 and 35  
HARVEST ACRES - 44**



**Legend**

-  Muskeg
-  Paved Trail
-  Red Paint Line
-  Natural Boundary
-  Lakes
-  Snowmobile Trails
-  Woods Roads
-  Highways and Town Roads
-  Section Corner
-  Gates
-  FFA Camp

-  Aspen Coppice (42 Acres): Cut all aspen, oak and red maple larger than 1" DBH as well as white birch larger than 6" DBH and all orange marked pine.
-  Thinning (2 Acres): Cut all orange marked trees.

**Note: Harvesting, skidding and road construction allowed July 16th - April 14th due to risk of oak wilt.**



Scale: 4" = 1 Mile

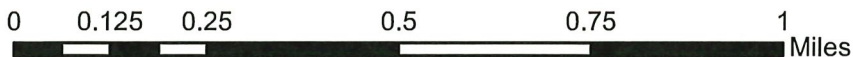

Map produced by  
Cody Starman, 5/24

This map is for informational purposes only and may not have been prepared for or to be suitable for legal, engineering or surveying purposes. The user is solely responsible for verifying the accuracy of information before using for any purpose. By using this product for any purpose user agrees to be bound by all disclaimers found here: <https://dnr.wisconsin.gov/legal>.

NH-ALSF TRACT NO. 23-24

Not Another Jag

The cutting area is approximately 44 acres.

All trees that will yield one or more 100-inch sticks to the minimum 4" top diameter will be cut and utilized.

Whole tree utilization is not allowed.

---

<u>SPECIES</u>	<u>ESTIMATED VOLUME (TONS)</u> <u>MINIMUM TOP DIAMETER</u>
Red Pine <sup>1</sup>	4" 250
Aspen	1650
Mx Hardwood <sup>2</sup>	525

**TOTAL MINIMUM BID VALUE \$27,055.00**

---

1. Approximately 65% Red Pine and 35% White Pine. Includes approximately 20 MBF of Red Pine sawlogs and 10 MBF of White Pine sawlogs.

2. Approximately 41% Red Oak, 37% Red Maple, and 22% White Birch.

Sale contains approximately 56 tons/acre or approximately 24 cords/acre.

Special Conditions:

1. **Seasonal Restriction:** Harvesting, skidding and road construction will only be allowed from July 16<sup>th</sup> to April 14<sup>th</sup> due risk to of oak wilt. Hauling and decking will only be allowed from September 16<sup>th</sup> to April 14<sup>th</sup> along the FFA camp road.
2. The snowmobile trail must be kept free of debris, snow covered in winter and always left in good condition for vehicle traffic. The trail must be repaired to pre-harvest condition prior to each snow season. Slash within 50 feet of the snowmobile trail and North Creek Rd must be lopped and scattered to within two feet of the ground and pulled back into the sale area at least 10 feet.
3. Cutting must be concurrent for all species to be harvested.
4. All landings and any new roads must be approved prior to sale start up. All woods roads must be cleared of debris and leveled upon completion of sale.
5. Do not harvest trees or operate equipment with 15 feet of any ephemeral pond. No slash or logging debris shall be deposited within ephemeral ponds.
6. All pine products cut between April 1 and September 1 must be removed from the sale area within three weeks from the time of cutting. Pine products cut during the remainder of the year must be removed prior to April 1 of each year.
7. Felling and skidding damage to residual trees must be avoided. Do not knock down or utilize any dead trees unless they pose a safety hazard.
8. If the contract is to be worked on during multiple time periods a mid-contract "pull-off" inspection meeting will be required. One-week notice shall be given by the contractor prior to moving equipment off-site. During the "pull-off" inspection provisions needing attention will be documented. The contractor at this time can decide to remedy them before pulling off or rectify them when moving back onto the site. If the latter is chosen documented items shall be addressed before harvesting can continue.

**Notice:** Completion of this form is mandatory. The Department will not recognize your bid unless you complete and submit this form. Personal information collected will be used for program administration and may be provided to requesters as required by Wisconsin's Public Records law [ss. 19.31-19.39, Wis. Stats.].

Date
------

Bidder Name
-------------

Street Address	City	State	ZIP Code
----------------	------	-------	----------

Property Name (if any) Northern Highland-American Legion	Timber Sale Name Not Another Jag	Tract Number 23-24
---	-------------------------------------	-----------------------

Date and Hour of Bid Opening November 6, 2024 1:30 pm Boulder Junction Community Center	Minimum Acceptable Bid (optional) \$27,055.00
--	--

Species-All bids including Lump Sum bids must be by species	Utilization Specifications (4 inch/Whole Tree/Logs)	Estimated Volume	Volume Units (tons/cords/mbf)	Price Bid Per Unit	Total Bid Value on Estimated Volume
red pine	4 inch	250	tons		
aspen	4 inch	1,650	tons		
mixed hardwood	4 inch	525	tons		

The award shall be based on this TOTAL BID AMOUNT:

**Performance Bond** Will be in the form of: (select one)

Personal Check
  Assurance Bond  
 Certified Check/Money Order
  Certificate of Deposit  
 Irrevocable Letter of Credit
  Assignment of Savings Account

I understand that any or all bids may be rejected and that consideration and awarding of a contract will be based upon my past performance and ability to complete contracts. **I also understand that if I am the winning bidder, I have 6 weeks from the date of the bid opening to submit an acceptable performance bond. I also understand that if I am awarded the contract and fail to execute it or work under it, I will be required to forfeit to the Department an amount equal to 10% of my total bid amount.** Failure to forfeit the 10% penalty will result in being considered ineligible to bid on any state timber sales for a two-year duration. In the event the highest bidder can not or will not sign the contract, the award may be made to the next highest qualified bid.

By checking this box, I certify that I hold a Wisconsin Master Logger Certification.

**Notice:** I understand:

Utilization specifications and estimated volumes are listed in the prospectus which is available upon request from the Department.

A copy of the standard timber sales contract which must be entered into is available upon request from the Department.

Signature of Bidder
Bidder's Name (Please Print or Type)
Phone Number (include area code)
Email Address