

**WISCONSIN
DEPARTMENT OF NATURAL RESOURCES
TIMBER SALE
TRACT 02-24 BAKKEN BUSINESS
T42N R6E SECTIONS 29, 30, 31 & 32
HARVEST ACRES - 264**

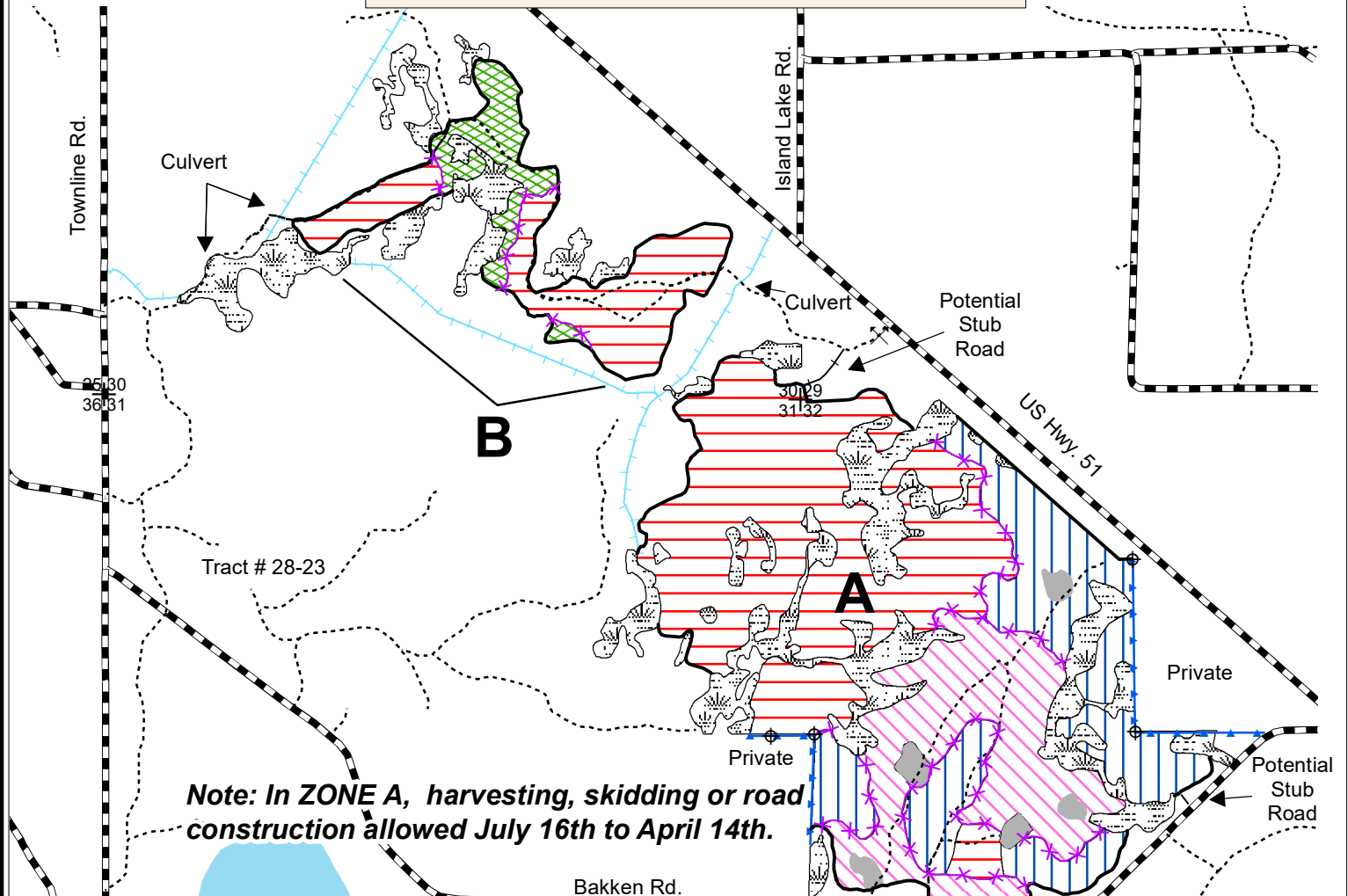

Note: In ZONE A, harvesting, skidding or road construction allowed July 16th to April 14th.

Legend

- Potential Stub Roads
- Red Paint Line
- Natural Boundary
- Purple Line
- Blue Line
- Woods Roads
- Highways and Town Roads
- Ephemeral Pond
- Grass Openings
- Ditches
- Berms
- Section Corner
- Survey Marker

- Aspen Coppice (61 Acres): Cut all aspen, oak, red maple, white birch and cherry larger than 1" DBH as well as orange marked pine.
- Seed Tree (14 Acres): Cut all black spruce, tamarack, white birch and red maple greater than 4" DBH **EXCEPT** trees marked with green paint.
- Pine Thinning (136 Acres): Cut red oak, red maple, white birch, cherry and aspen greater than 6" DBH as well as all orange marked trees.
- Pine Clearcut (53 Acres): Cut all trees larger than 1" DBH **EXCEPT** pine greater than 28" DBH.

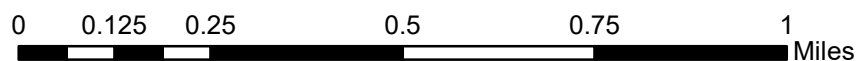

Scale: 4" = 1 Mile



Map produced by Joe Renik, 5/2024

This map is for informational purposes only and may not have been prepared for or to be suitable for legal, engineering or surveying purposes. The user is solely responsible for verifying the accuracy of information before using for any purpose. By using this product for any purpose user agrees to be bound by all disclaimers found here: <https://dnr.wisconsin.gov/legal>.

NH-ALSF TRACT NO. 02-24

Bakken Business

The cutting area is approximately 264 acres.

All trees that will yield one or more 100-inch sticks to the minimum 4" top diameter will be cut and utilized.

Whole tree utilization is allowed.

ESTIMATED VOLUME (TONS)
MINIMUM TOP DIAMETER

<u>SPECIES</u>	<u>4"</u>	<u>Whole Tree</u>
White Pine ¹	4100	N/A
Red Pine ²	4000	N/A
Spruce ³	410	N/A
Aspen	1850	2550
Oak	1000	1400
Mx Hardwood ⁴	1400	1950

TOTAL MINIMUM BID VALUE \$164,045.00

1 Includes approximately 538 MBF sawlogs

2 Approximately 98% red pine and 2% jack pine. Includes approximately 489 MBF sawlogs.

3 Approximately 62% black spruce, 33% tamarack and 5% balsam fir.

4 Approximately 35% white birch, 49% red maple, 15% black cherry and 1% hard maple.

Sale contains approximately 48.4 tons/acre or approximately 21.6 cords/acre.

Special Conditions:

1. **Seasonal Restriction:** Harvesting, skidding and road construction will only be allowed from July 16th to April 14th in **Zone A**.
2. Cutting must be concurrent for all species to be harvested.
3. All landings and any new roads must be approved prior to sale start up. No decking will be allowed along Bakken Rd without Town approval. All woods roads must be cleared of debris and leveled upon completion of sale.
4. Do not harvest trees or operate equipment with 15 feet of any ephemeral pond. No slash or logging debris shall be deposited within ephemeral ponds.
5. All pine products cut between April 1 and September 1 must be removed from the sale area within three weeks from the time of cutting. Pine products cut during the remainder of the year must be removed prior to April 1 of each year.
6. Felling and skidding damage to residual trees must be avoided. Do not knock down or utilize any dead trees unless they pose a safety hazard.
7. Slash throughout the of the sale must be evenly scattered and pulled back from town road right of ways. Trees felled across blue paint lines and red paint lines must be pulled back into the sale area prior to processing.
8. If the contract is to be worked on during multiple time periods a mid-contract "pull-off" inspection meeting will be required. One-week notice shall be given by the contractor prior to moving equipment off-site. During the "pull-off" inspection provisions needing attention will be documented. The contractor at this time can decide to remedy them before pulling off or rectify them when moving back onto the site. If the latter is chosen documented items shall be addressed before harvesting can continue.

Notice: Completion of this form is mandatory. The Department will not recognize your bid unless you complete and submit this form. Personal information collected will be used for program administration and may be provided to requesters as required by Wisconsin's Public Records law [ss. 19.31-19.39, Wis. Stats.].

Date

Bidder Name

Street Address	City	State	ZIP Code
----------------	------	-------	----------

Property Name (if any) Northern Highland-American Legions	Timber Sale Name Bakken Business	Tract Number 02-24
--	-------------------------------------	-----------------------

Date and Hour of Bid Opening November 6, 2024 1:30 pm Boulder Junction Community Center	Minimum Acceptable Bid (optional) \$164,045.00
--	---

Species-All bids including Lump Sum bids must be by species	Utilization Specifications (4 inch/Whole Tree/Logs)	Estimated Volume	Volume Units (tons/cords/mbf)	Price Bid Per Unit	Total Bid Value on Estimated Volume
White Pine	4 inch	4,100	tons		
Red Pine	4 inch	4,000	tons		
Spruce	4 inch	410	tons		
Aspen	4 inch/Whole Tree		tons		
Oak	4 inch/Whole Tree		tons		
Mixed Hardwood	4 inch/Whole Tree		tons		

The award shall be based on this TOTAL BID AMOUNT:

Performance Bond Will be in the form of: (select one)

Personal Check
 Assurance Bond
 Certified Check/Money Order
 Certificate of Deposit
 Irrevocable Letter of Credit
 Assignment of Savings Account

I understand that any or all bids may be rejected and that consideration and awarding of a contract will be based upon my past performance and ability to complete contracts. **I also understand that if I am the winning bidder, I have 6 weeks from the date of the bid opening to submit an acceptable performance bond. I also understand that if I am awarded the contract and fail to execute it or work under it, I will be required to forfeit to the Department an amount equal to 10% of my total bid amount.** Failure to forfeit the 10% penalty will result in being considered ineligible to bid on any state timber sales for a two-year duration. In the event the highest bidder can not or will not sign the contract, the award may be made to the next highest qualified bid.

By checking this box, I certify that I hold a Wisconsin Master Logger Certification.

Notice: I understand:

Utilization specifications and estimated volumes are listed in the prospectus which is available upon request from the Department.

A copy of the standard timber sales contract which must be entered into is available upon request from the Department.

Signature of Bidder
Bidder's Name (Please Print or Type)
Phone Number (include area code)
Email Address