

**Wisconsin Department of Natural Resources
 Timber Sale
 Tract 3-22 Witches Hardwood
 T40N, R7E, Sections 3 & 10
 Harvest Acres - 33**

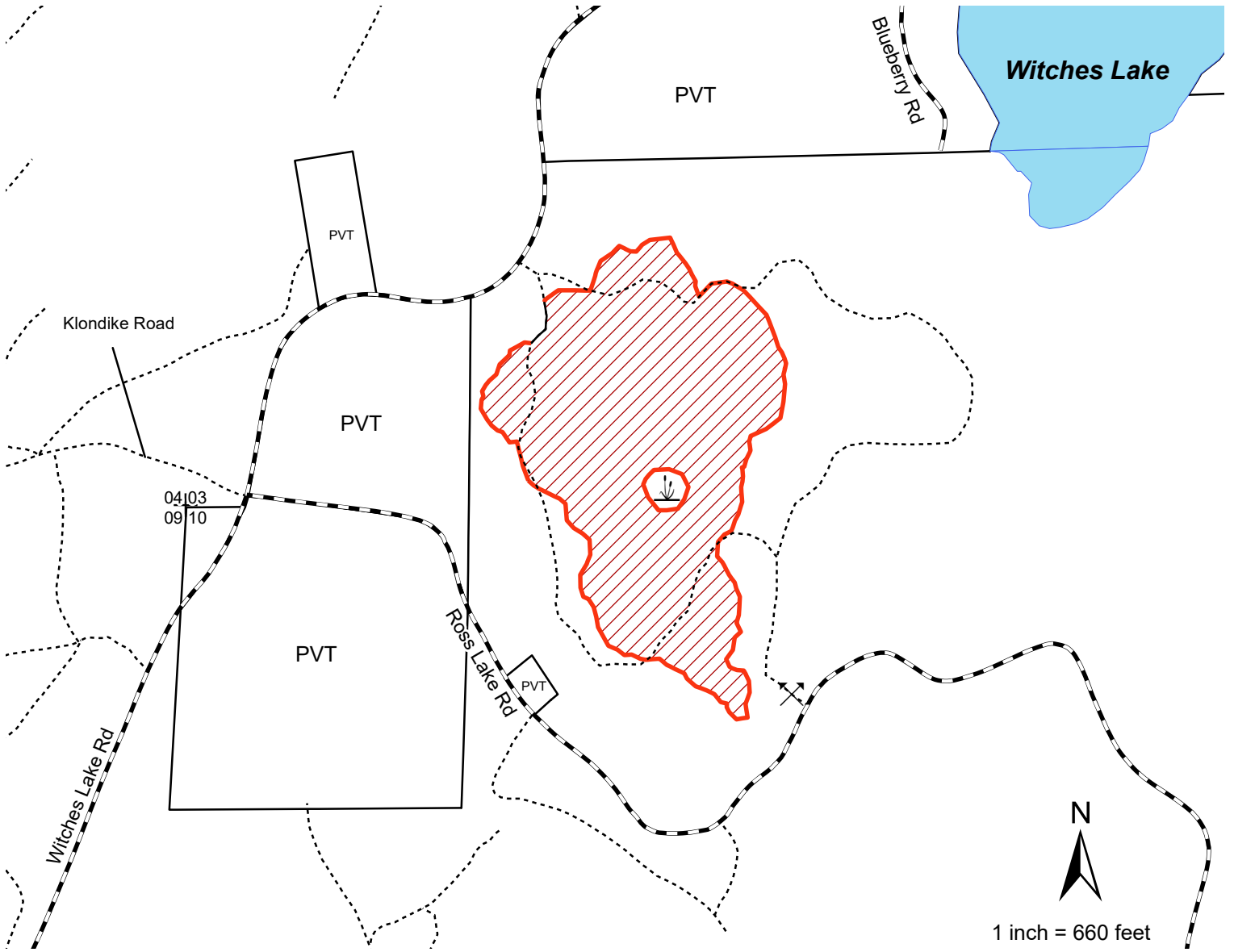

Legend

- Section Corner
- Berms
- Keg
- Town and County Roads
- Woods Roads
- Red Line
- Harvest Area
- Lakes

Harvest Area (33 acres) Cut all aspen and ironwood >2" DBH, merchantable balsam and orange marked trees.

***No harvesting, skidding, or road building will be allowed between April 15th and July 15th due to oak wilt restrictions.**

NHAL STATE FOREST TRACT NO. 3-22
Witches Hardwood

Vilas County

Town 40 North, Range 7 East (Town of Arbor Vitae)

Section 3 – SWSE, SESW

Section 10 – NENW

No bid bond is required.

The cutting area is approximately 33 acres.

All trees that will yield one or more 100-inch sticks to the minimum top diameter chosen by the bidder will be cut and utilized.

Whole tree harvest is allowed on this timber sale

ESTIMATED VOLUME (TONS)
MINIMUM TOP DIAMETER

<u>Species</u>	<u>4"</u>	<u>Whole Tree</u>
Balsam Fir ³	95	110
Oak ²	325	400
Mixed Hardwood ¹	525	675

Total Minimum Bid Value: \$4,779.00

¹ Approximately 39% hard maple, 31% red maple, 21% aspen, 7% ironwood, and 2% white birch. Includes 4 MBF of potential maple sawlogs. (Wt. conv. 2.407 tons/cord)

² Includes 20 MBF of potential oak sawlogs.

³ Approximately 62% balsam fir and 38% white pine. Includes 3 MBF potential white pine sawlogs. (Wt. conv. 2.115 tons/cord)

Note: Total sale volume equates to 35.8 tons/acre or 14.4 cords/acre based upon whole tree volumes.

Special Conditions:

1. **Seasonal Restriction:** No cutting, skidding, or road building from April 15th to July 15th due to the risk of oak wilt.
2. Cutting must be concurrent for all species, including 1-5" dbh trees where designated.
3. Do not cut, knock down or utilize any dead trees unless they pose a safety hazard to the operator.
4. Whole tree utilization or biomass harvesting is allowed. 1 in every 10 tops must remain evenly scattered throughout the sale area.
5. No hauling of loaded trucks is permitted on Witches Lake Road or the paved portion of Ross Lake Road due to Town of Arbor Vitae weight limits. Loaded trucks must utilize woods roads (some road construction will be required) to access the gravel portion of Ross Lake Road and County HWY C.
6. All pine products cut between April 1 and September 1 must be removed from the sale area within three weeks from time of cutting. Pine products cut during the remainder of the year must be removed prior to April 1 of each year.