

**WISCONSIN DEPARTMENT OF NATURAL RESOURCES  
TIMBER SALE  
TRACT 14-22 OLD RAIL SNOW TRAIL  
T-42-N R-6-E SECTION 24  
T-42-N R-7-E SECTION 19  
HARVEST ACRES - 171**

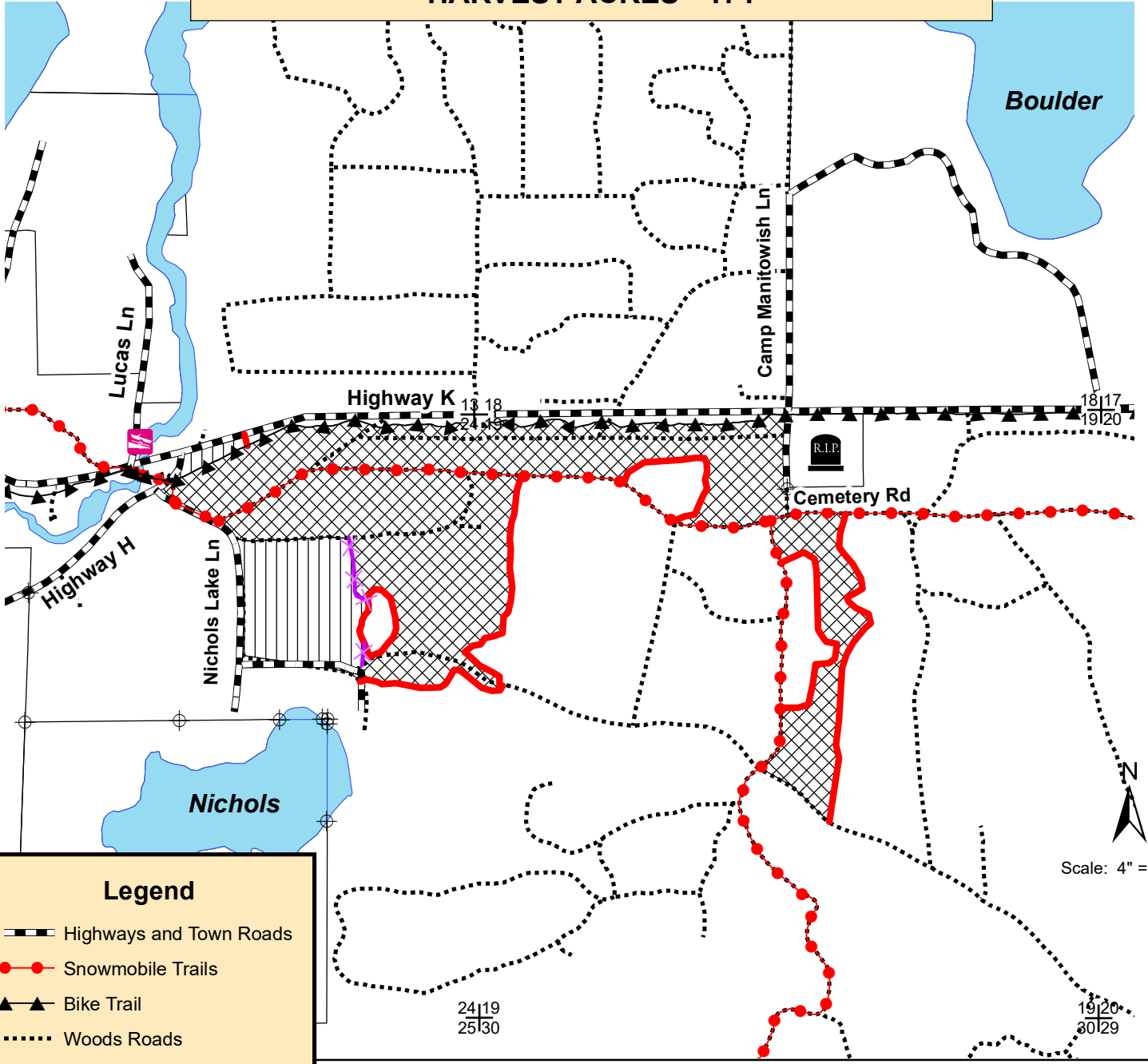

N  
Scale: 4" = 1 Mile

**Legend**

- Highways and Town Roads
- Snowmobile Trails
- Bike Trail
- Woods Roads
- Blue Paint Line
- Purple Paint Line
- Red Paint Line
- Section Corner
- Survey Marker
- Cemetery
- Boat Landing

- Red Pine Area: Cut all trees marked with orange paint
- Jack Pine Area: Cut all jack pine 1 inch and greater in diameter and trees marked with orange paint

Map produced by  
Jon Leith, 5/22

This map is not a survey of the actual boundary of any property this map depicts.

**This sale is located within Area 3: Vilas Sandy Plains North (Forest Production)**

NHALTRACT NO. 14-22  
Old Rail Snow Trail

Vilas County

Town 42 North, Range 6 East (Boulder Junction Township)

Section 24 – NE1/4

Town 42 North, Range 7 East (Boulder Junction Township)

Section 19 – W1/2NE1/4, NW1/4, N1/2SW1/4, NWSE

No bid bond is required.

The cutting area is approximately 171 acres.

All trees that will yield one or more 100-inch sticks to a 4” top diameter will be cut and utilized.

Whole tree utilization is NOT allowed.

---

ESTIMATED VOLUME (TONS)  
MINIMUM TOP DIAMETER

<u>SPECIES</u>	<u>4”</u>
Red Pine <sup>1</sup>	4750
Jack Pine	1000

**Total Minimum Bid Value: \$81,550.00**

---

<sup>1</sup> Approximately 99% red pine and 1% white pine (Wt. conv. 2.249 tons/cd). Includes the potential for approx. 580 MBF of red pine sawtimber  
Note: Total sale volume equates to 33.6 tons/acre or 15.1 cords/acre.

Special Conditions:

1. All pine products cut between April 1 and September 1 must be removed from the sale area within three weeks from time of cutting. Pine products cut during the remainder of the year must be removed prior to April 1 of each year.
2. Cutting must be concurrent for all species. Do not damage residual trees.
3. Do not cut, knock down or utilize any dead trees, unless they pose a hazard to operator safety.
4. Slash within 50 feet of all town roads and recreational trails must be lopped and/or scattered to lie within two feet of the ground and be pulled back 10’ behind the tree line concurrently with cutting.
5. All landings and any new woods roads must be approved prior to sale start up.
6. All roads and landings must be returned to pre-harvest conditions or better.