

**WISCONSIN
DEPARTMENT OF NATURAL RESOURCES
TIMBER SALE
TRACT 035-23W L and Abe
T36N R6E SECTIONS 9, 10, & 16
HARVEST ACRES - 65**

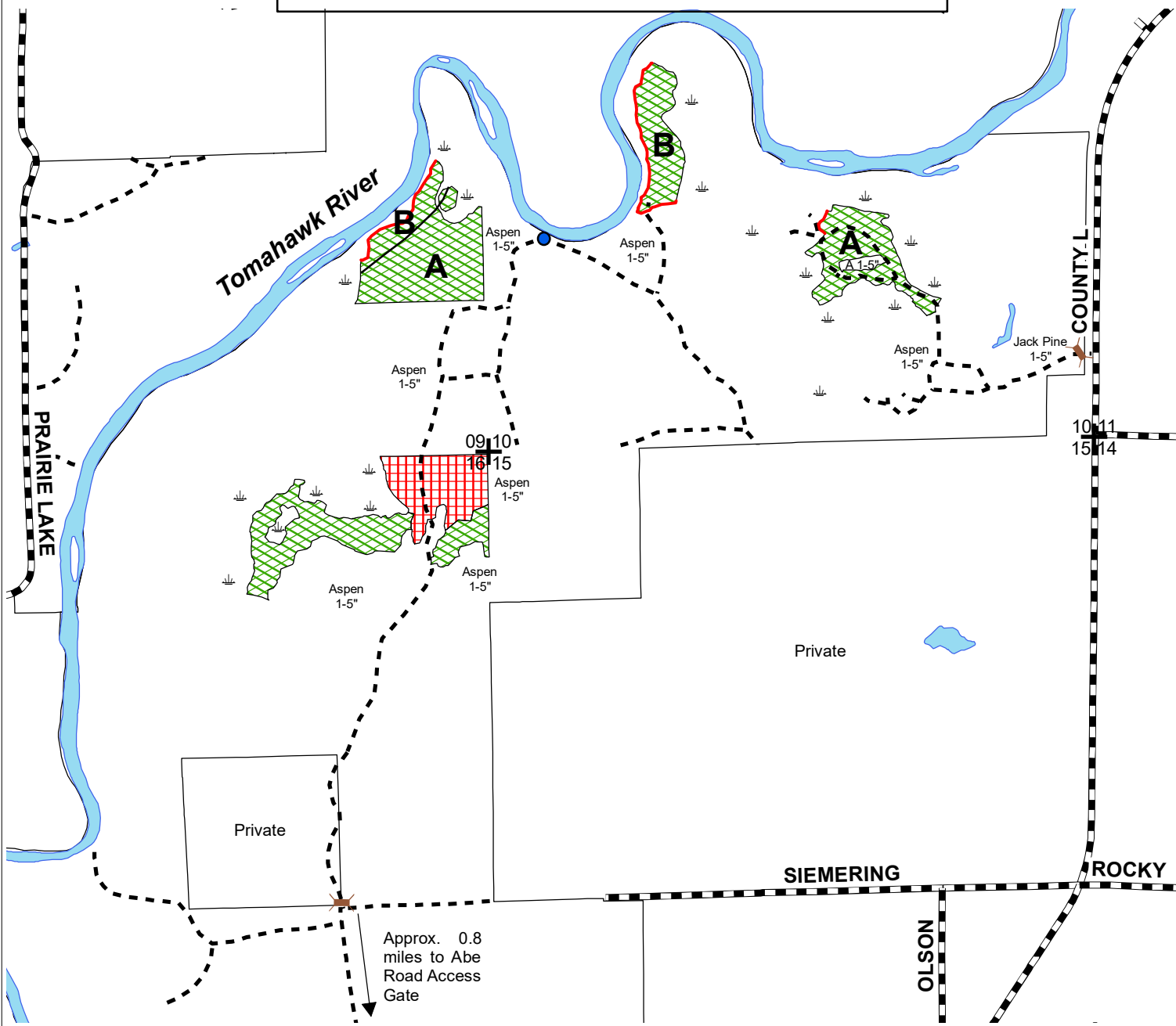

Legend

- Red Line
- Gates
- Culvert
- Section Corners
- Woods Roads
- Town/County Roads
- Lakes/Rivers
- Wetland

- Aspen Area (54 acres): Cut all aspen, white birch, maple, balsam fir, jack pine, and orange marked trees. Cut all 1-5" aspen and maple concurrently. Do NOT cut any green marked trees.
- Red Pine Thinning (11 acres): Cut same as above.

Zone A (26 acres): Logging operations can only occur from Sept. 16 - May 14.
Zone B (12 acres): Logging operations can only occur from Nov. 1 - March 14.
Zones A & B: Daylight working hours only.

This sale is located within the Forested Backlands Forest Production Area, Lower River Pines Native Community, and the River Scenic Management Area



4" = 1 mile
1:15,840



Map produced by
Adam Wallace, 10/22

This map is not a survey of the actual boundary of any property this map depicts.

WILLOW FLOWAGE TRACT NO. 035-23W

L and Abe

Oneida County

Town 36 North, Range 6 East (Nokomis Township)

Section 9 – NESE

Section 10 – NESW, SENW, W1/2SE

Section 16 – N1/2NE

No bid bond is required.

The cutting area is approximately 65 acres.

All trees that will yield one or more 100-inch sticks to a 4” top diameter will be cut and utilized.

ESTIMATED VOLUME (TONS)
MINIMUM TOP DIAMETER

<u>SPECIES</u>	<u>4”</u>
Red Pine ¹	100
Jack Pine ²	330
Aspen	1650
Mixed Hardwood ³	290

Total Minimum Bid Value: \$21,419.00

¹ Approximately 74% red pine, 26% white pine. Includes 11 MBF red pine and 2 MBF white pine sawtimber. (Wt. conv. 2.209 tons/cd)

² Approximately 98% jack pine, 2% balsam fir (Wt. conv. 2.125 tons/cd)

³ Approximately 50% red maple, 49% white birch, 1% oak. (Wt. conv. 2.339 tons/cd)

Note: Total sale volume equates to 37 tons/acre or 16 cords/acre.

Special Conditions:

1. All pine products cut between April 1 and September 1 must be removed from the sale area within three weeks from time of cutting. Pine products cut during the remainder of the year must be removed prior to April 1 of each year.
2. Cutting must be concurrent for all species. Do not damage residual trees.
3. Do not cut, knock down or utilize any dead trees, except they may be cut down along roadways where they pose a safety hazard.
4. Slash within 50 feet of all roads, trails, and waterbodies must be lopped and/or scattered to lie within two feet of the ground and be pulled back 10’ behind the tree line concurrently with cutting. No slash allowed across any red lines, or within any wetland or waterbody.
5. Whole tree utilization or biomass harvesting is not allowed.
6. Follow WI BMP’s for water quality at all times. Avoid wetlands as much as possible and only operate within them during very dry times with timber matting or under frozen ground conditions.
7. Landings and any new logging roads generally must be 200’ or greater from the Tomahawk River. Roads and landings must be approved by the Willow Flowage Property Manager in advance.
8. Logging operations in Zone A(approx. 26 acres) will only be allowed from September 16 to May 14. Logging operations in Zone B(approx. 12 acres) will only be allowed from November 1 to March 14. Logging operations must occur during daylight hours in Zones A & B to avoid disturbing nearby campers.
9. Logging access into the sale from Abe Road through private property has been verbally granted. This access road must remain in good drivable condition for passenger vehicles at all times. No access through the private property will be allowed during the gun deer season. Contact the Willow Flowage Property Manager in advance for access through the gates.