

**Tract 8-24 (Long Spoon) – Flambeau River State Forest**

Parts of: S1/2 NW, S1/2 NE, NESE, SW1/4 Sec. 6, T 38N-R3W, Town of Winter, Sawyer County



**Selection Area (95 acres)** – Bounded by red paint and blue paint. Harvest all orange marked trees. Sever all orange marked unmerchantable stems. Leave all snags. *Protect existing regeneration.*



**Black Ash/Red Maple Coppice Area (16 acres)** – Bounded by red paint. Cut all trees greater than 2” except for: 1) cedar, 2) hemlock, 3) white pine, 4) oak, 5) yellow birch, and 6) snags.



**Aspen Coppice Area (5 acres)** – Bounded by red paint. Cut all trees greater than 2” except for: 1) hemlock, 2) white pine, 3) oak, and 4) snags.

Total Acres: 116

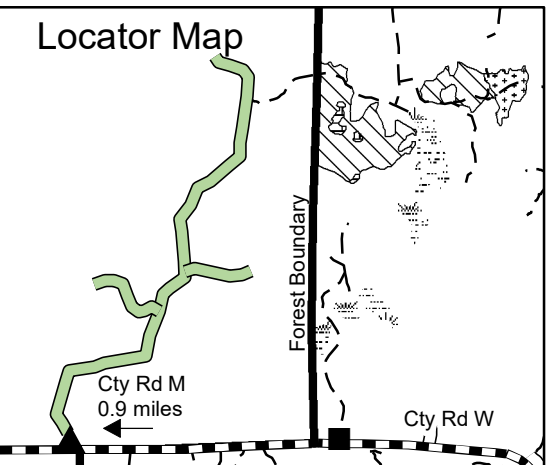
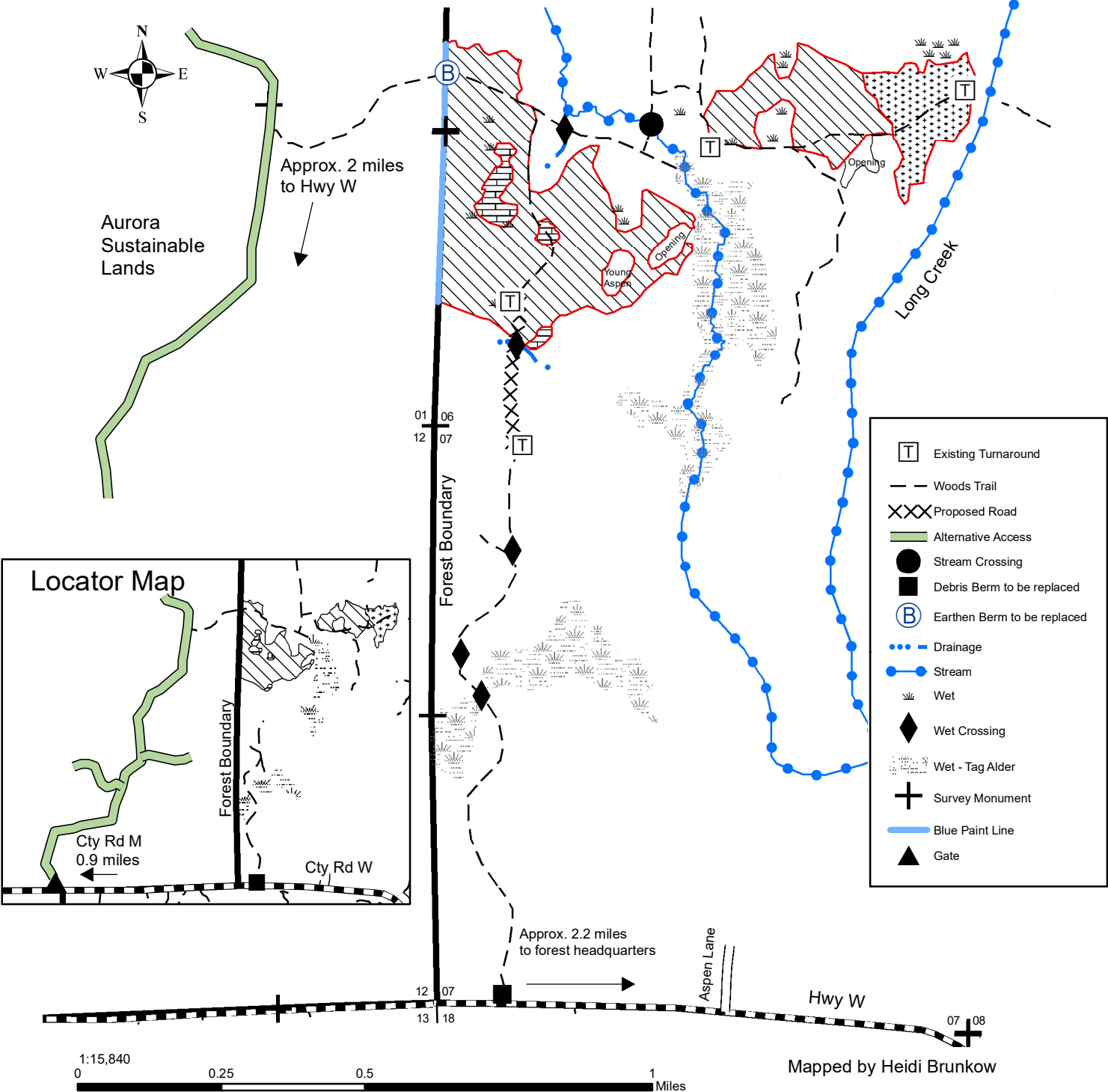

Mapped by Heidi Brunkow

This map is for informational purposes only and may have not been prepared for or be suitable for legal, engineering or surveying purposes. The user is solely responsible for verifying the accuracy of information before using for any purpose. By using this product for any purpose user agrees to be bound by all disclaimers found here: <https://dnr.wisconsin.gov/legal>.