

Tract 4-24 (You Rang?) - Flambeau River State Forest

Parts of: SW NW, NW SW Sec 25, E1/2 NW, W1/2 NE Sec 26 T38N R3W, Town of Winter, Sawyer County

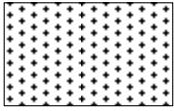

1:15,840



Larch Area (43 acres): No boundary paint. Harvest all trees within the European Larch plantation greater than 1."

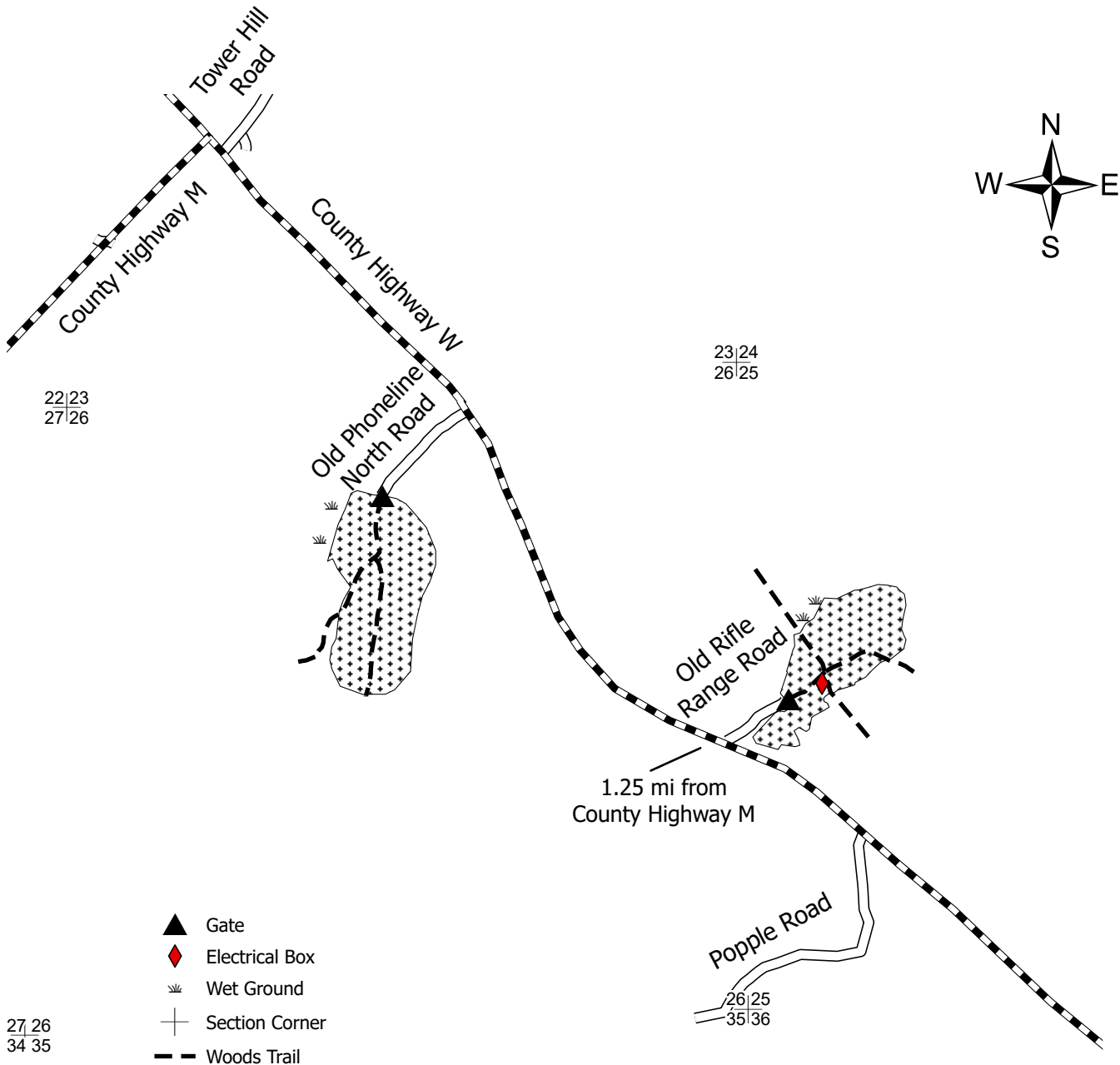

27|26
34|35

- ▲ Gate
- ◆ Electrical Box
- ☩ Wet Ground
- ⊕ Section Corner
- - Woods Trail

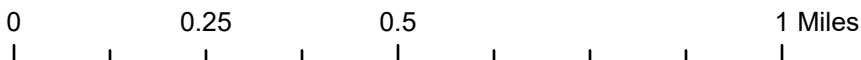

Mapped by
Taylor Lockwood