

Tract 13-22 (Foxhole) - Flambeau River State Forest

Parts of: SE 1/4 Sec 23 T37N R3W Sawyer County

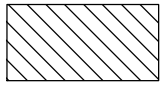

Selection Area (40 acres)- Bounded by red paint. Harvest all orange marked trees and all ironwood. Sever all orange marked unmerchantable stems. Cut only marked aspen.

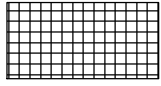

Purple Area (8 purple gaps, 2 acres)- Bounded by purple paint. Cut all trees greater than 1" except 1) hemlock, 2) pine, and 3) oak.



Overstory Removal Area (2 acres)- Bounded by green paint. Harvest all trees greater than 2" except 1) hemlock, 2) pine, and 3) oak. Protect as much regeneration as possible.

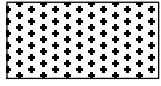

Coppice Area (22 acres)- Bounded by yellow paint. Cut all trees greater than 1" except 1) hemlock, 2) pine, 3) oak, 4) cedar, and 5) green marked trees.

67 total acres

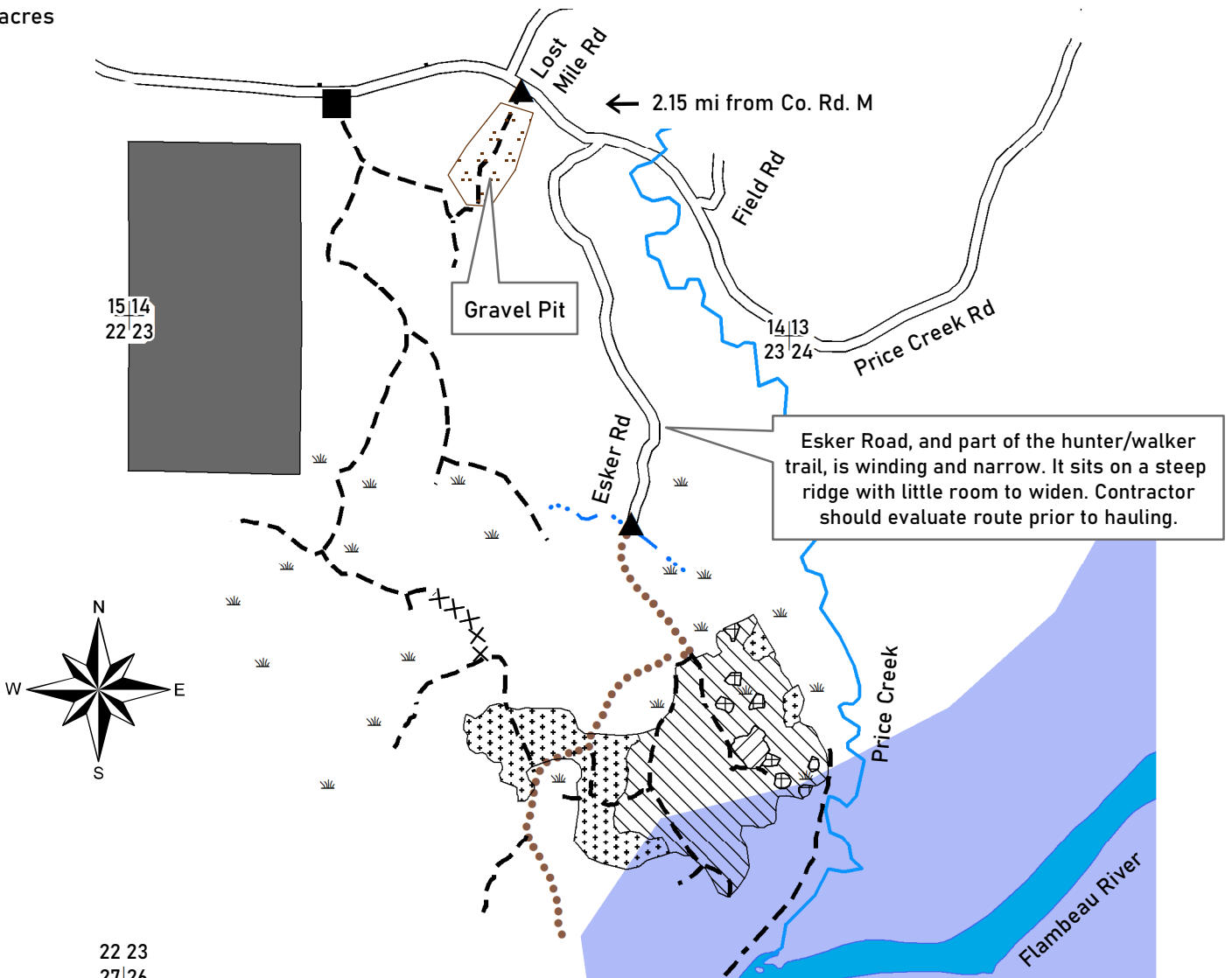

Esker Road, and part of the hunter/walker trail, is winding and narrow. It sits on a steep ridge with little room to widen. Contractor should evaluate route prior to hauling.

22 23
27|26

- ▲ Gate
- Existing Berm
- ☼ Wet Area
- ⊕ Section Corner
- ⋯ Drainage
- Private Property
- Scenic Management Area (Harvest Oct 15- Mar 31)
- XXXX Proposed Road
- Hunter-walker Trail
- Woods Trail
- Road

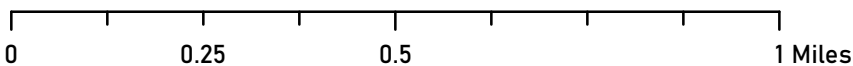

Mapped by Taylor Lockwood
This map is not a survey of the actual boundary of any property this map depicts