

Tract 6-23 (Short Round Sal) - Flambeau River State Forest

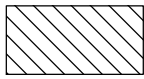

1:15,840

Parts of: W $\frac{1}{2}$ NW $\frac{1}{4}$ Sec 2, SE $\frac{1}{4}$ NE $\frac{1}{4}$ Sec 3 T36N-R4W Rusk County,
E $\frac{1}{2}$ SE $\frac{1}{4}$ Sec 34, S $\frac{1}{2}$ SW $\frac{1}{4}$ Sec 35 T37N-R4W, Sawyer County



Selection Areas (40 acres) – Bounded by red and blue paint. Harvest all orange marked trees within the designated boundaries. Sever all orange marked unmerchantable stems. Cut all merchantable ironwood.

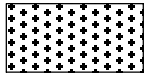

Red Maple Coppice Area (1 acres) – Bounded by yellow paint. Cut all trees greater than 2" except: 1) hemlock, 2) white pine, 3) red pine, 4) oak, and 5) X marked trees.

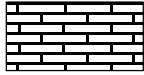

Purple Areas (4 acres) – Bounded by purple paint. Cut all trees greater than 4" except: 1) oak, and 2) purple X marked trees. Cut all ironwood and musclewood.



Tamarack/Black Spruce Strip Cuts (3 acres) – Cut all trees within 50 feet of each side of orange marked center line except: 1) hemlock, and 2) white pine. Cut all orange marked trees.

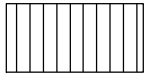

Tamarack/Black Spruce Seed Tree Area (3 acres) – Bounded by green paint. Harvest all merchantable trees, except: 1) hemlock, 2) white pine, and 3) green marked X trees.

Total acres: 51

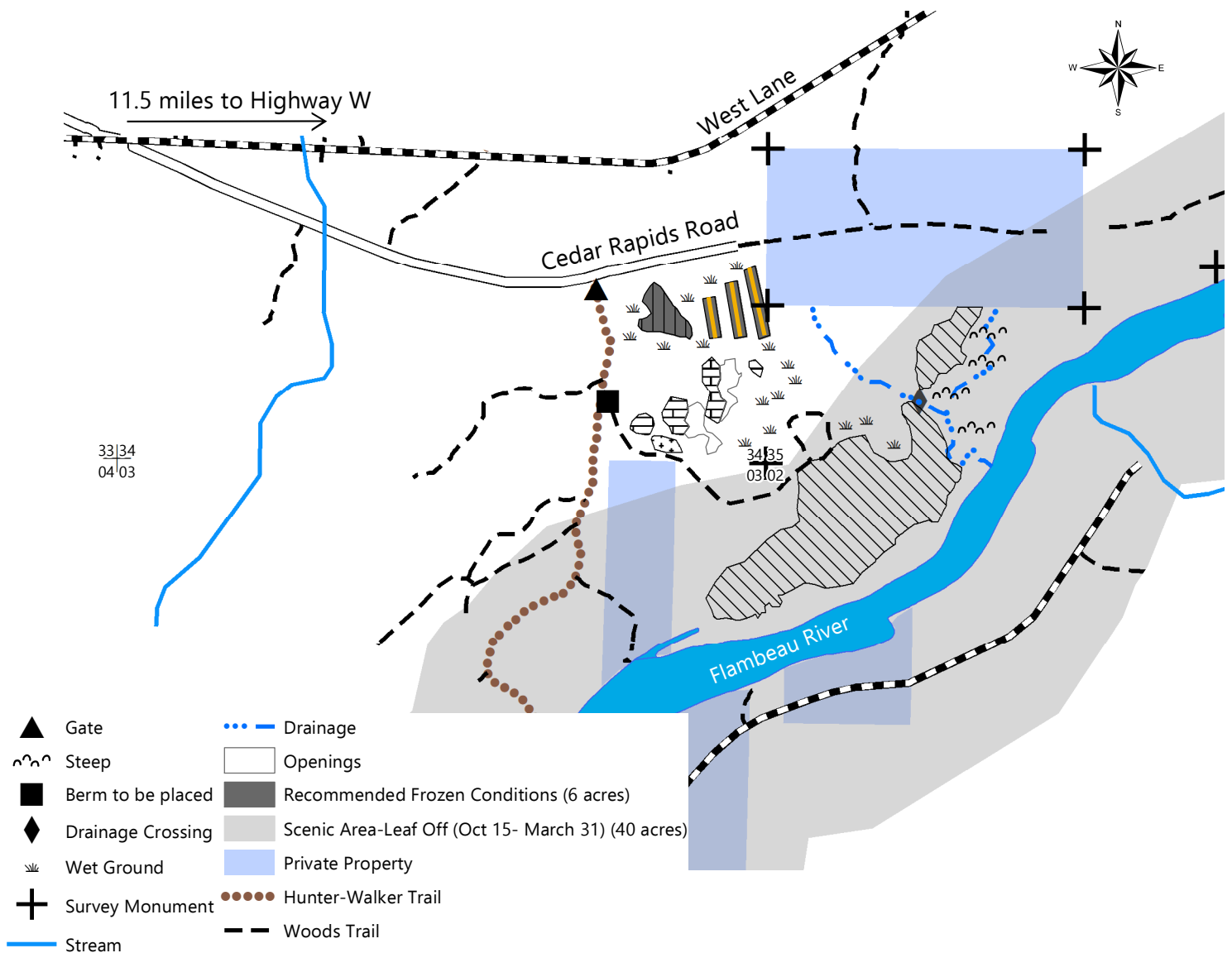

Mapped by Taylor Lockwood

This map is not a survey of any property this map depicts