

Tract 5-22 (Nevermore)- Flambeau River State Forest

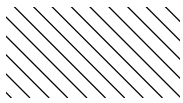

Parts of: SW¼ SE¼, SE¼ SW¼ Section 4, and W½ NE¼, NW¼ Section 9 T38N R3W



Selection Area (17 acres)- Bounded by red paint and woods trail. Harvest all orange marked trees and all merchantable ironwood within the designated boundaries. Sever all orange marked unmerchantable stems. Do not cut snags or cull trees.

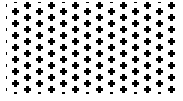

Coppice Area (75 acres)- Bounded by yellow paint. Cut all trees greater than 1" **except for**: 1) white pine, 2) hemlock, 3) cedar, and 4) oak

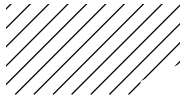

Plantation Thinning (8 acres)- Bounded by red paint. Harvest all trees marked with orange paint. Cut only **marked** aspen.

Total Acreage: 100

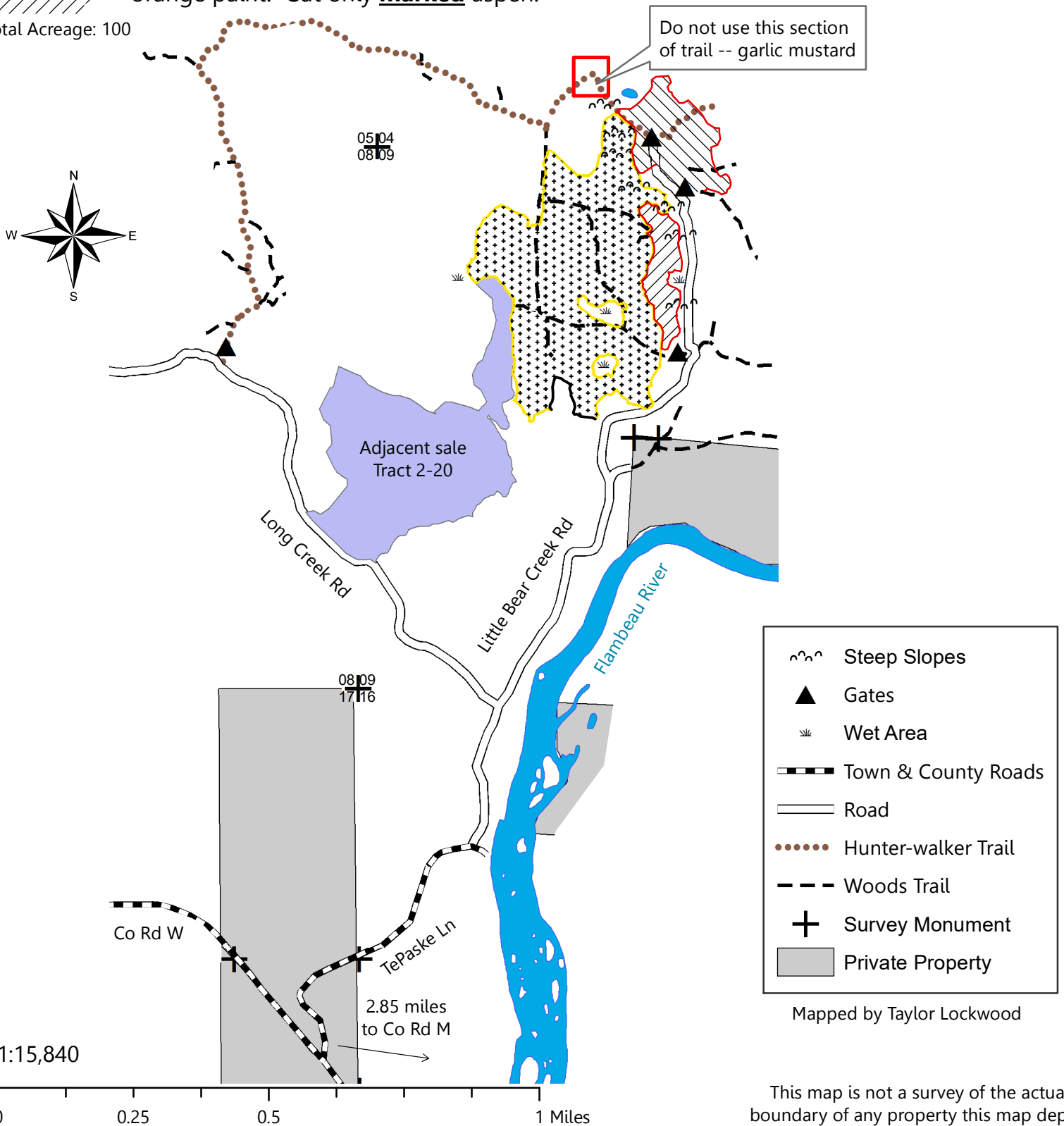

This map is not a survey of the actual boundary of any property this map depicts