

# Brule River State Forest

Sale Name: <b>Minnuesing Acreage</b>			Tract Number: 16-19	Estimated Volumes: TONS				
Twp: 46N	Range: 11W	Section: 21	Compartment: 16	Species	TONS	TONS		
Township: Bennett			Stand: 3,6,9		4" Top	Whole Tree	Ave DBH	
Soil: Sand/Loam	Topography: Rolling		Acres: 62	Aspen	3500	NA	10	
Seasonal Restrictions: Dry or Frozen conditions Oak Wilt restriction: No Harvesting April 15-July 15.					White Birch	750	NA	9
					Balsam Fir	225	NA	8
				Minimum Bid	<b>\$44,568</b>			

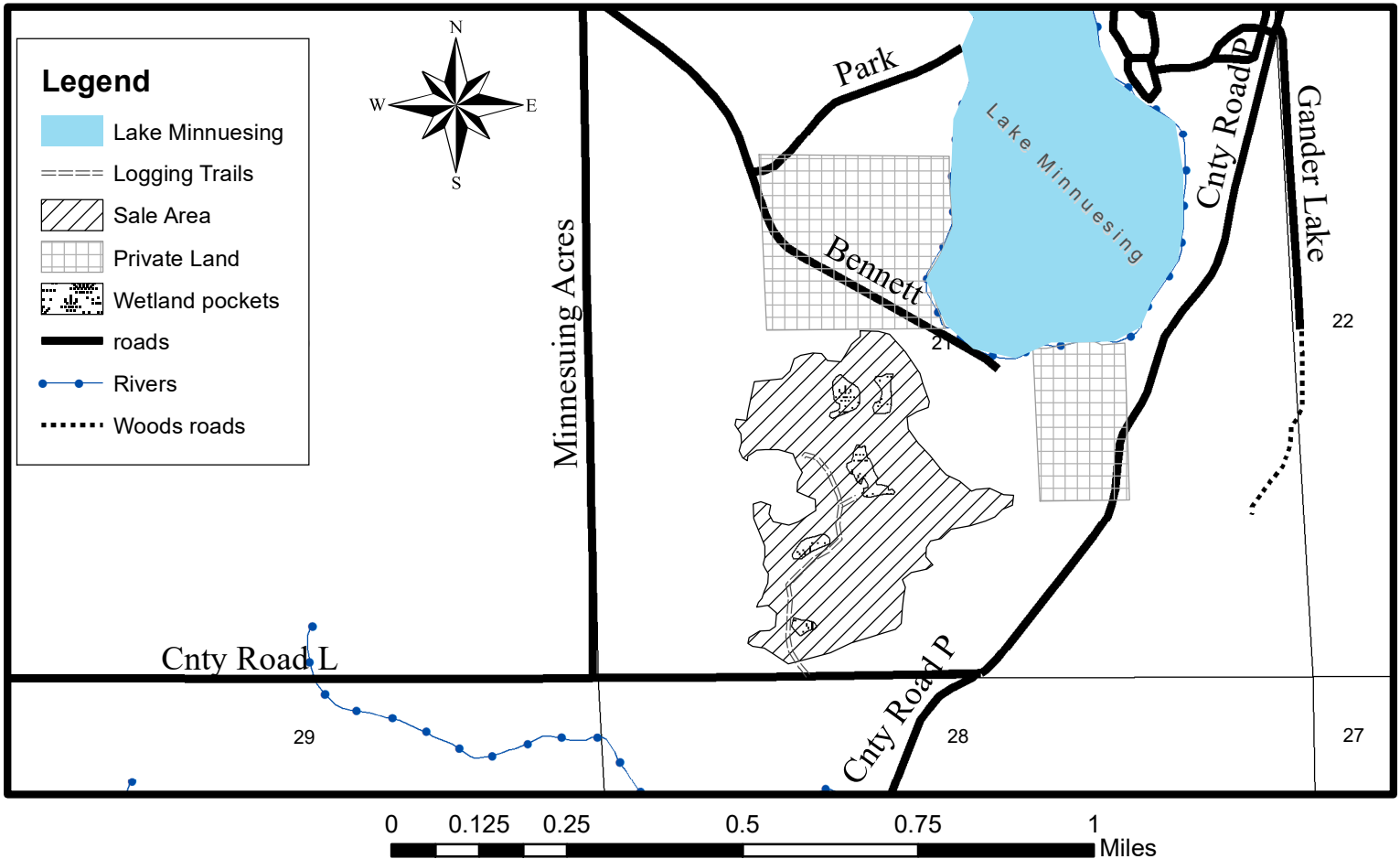

1. Sale boundaries marked in red paint or blue paint. Blue paint indicates private land boundary and shall not be crossed.

2. Cut all aspen, and white birch that are 2 inches DBH or greater. Cut all balsam fir that are 6 inches DBH or larger. Leave all other trees uncut and undamaged. Do not fell or leave slash into wetland openings or open grassy areas. Avoid equipment operation within any wetland areas. To prevent transmission of oak wilt, no harvesting activity April 15-July 15.

3. Utilize all trees which contain one or more 100" stick to a 4-inch top diameter. Slash height must not exceed 3 feet.

4. Access for sale shall be from Hwy L to the south of sale area utilizing logging trail that will need improvement. Contact state forest staff for access. New road and/or landing construction must be approved by property manager or contract administrator.

\*\*\*\* This map is not a survey of the actual boundary of any property this map depicts.