

# Brule River State Forest

Sale Name: <b>Running Roost</b>			Tract Number: 1-23	Estimated Volumes: TONS			
Twp: 46N	Range: 11W	Section: 27,28,33,34	Compartment: 14,18	Species	TONS	TONS	
Township: Bennett			Stand: 7,16,22,5		4" Top	Whole Tree	Ave DBH
Soil: Sand	Topography: Flat		Acres: 76	Red Pine	2400	NA	9-16
Red pine volume includes 1% jack pine. 2 <sup>nd</sup> thin ave cut DBH 9" 3 <sup>rd</sup> thin ave cut DBH 13" Regen cut ave DBH 16"				Minimum Bid <b>\$31,200</b>			

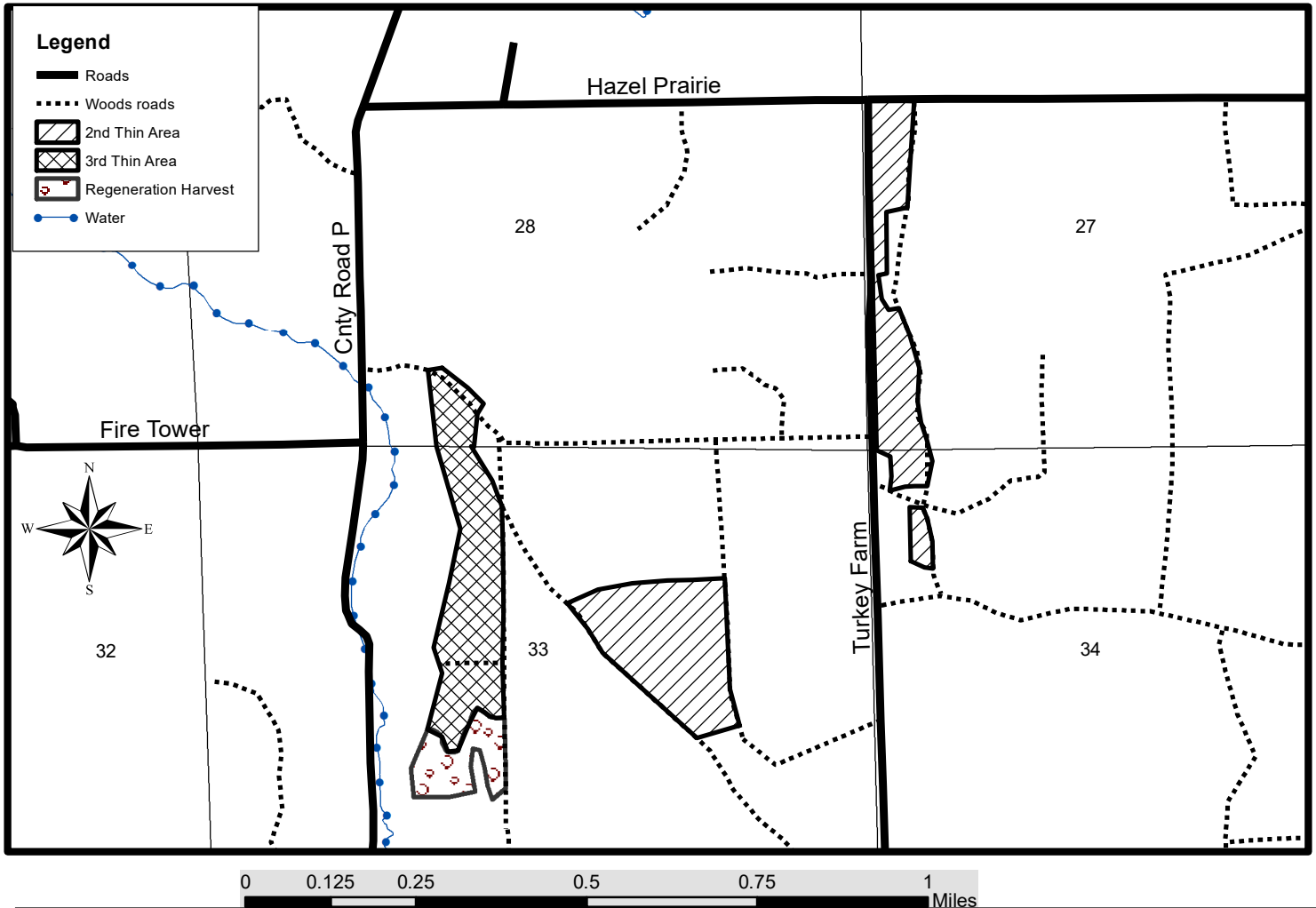

1. Sale boundaries marked in red paint, or are bounded by obvious roads or cover type changes.

2. Thinning Areas: Cut all trees marked in orange paint. Cut all merchantable sized jack pine.

Regeneration Harvest: Cut all trees 2 inch DBH and larger.

For all areas utilize all cut trees which contain one or more 100" stick to a 4-inch top diameter. Slash height must not exceed 3 feet.

3. Between May 15 and August 15, cut pine products must be hauled within 2 weeks of cutting to prevent bark beetle infestation.

4. New road and/or landing construction must be approved by property manager or contract administrator.

\*\*\*\* This map is not a survey of the actual boundary of any property this map depicts.