

# Pattison State Park

Sale Name: <b>Pattison State Park</b>			Tract Number: 1-23	Estimated Volumes: TONS			
Twp: 48N	Range: 12W	Section: 29	Compartment: 1 & 311	Species	TONS 4" Top	TONS Whole Tree	Average DBH
Township: Superior			Stand: 18 & 44	Aspen	670	960	8
Soil: Clay	Topography: Flat / Gentle Rolling		Acres: 12.5	Balsam Fir	55	130	6
Seasonal Restrictions: ***Frozen ground only*** ***November 15 – March 15***					<b>Minimum Bid: \$4,026</b>		

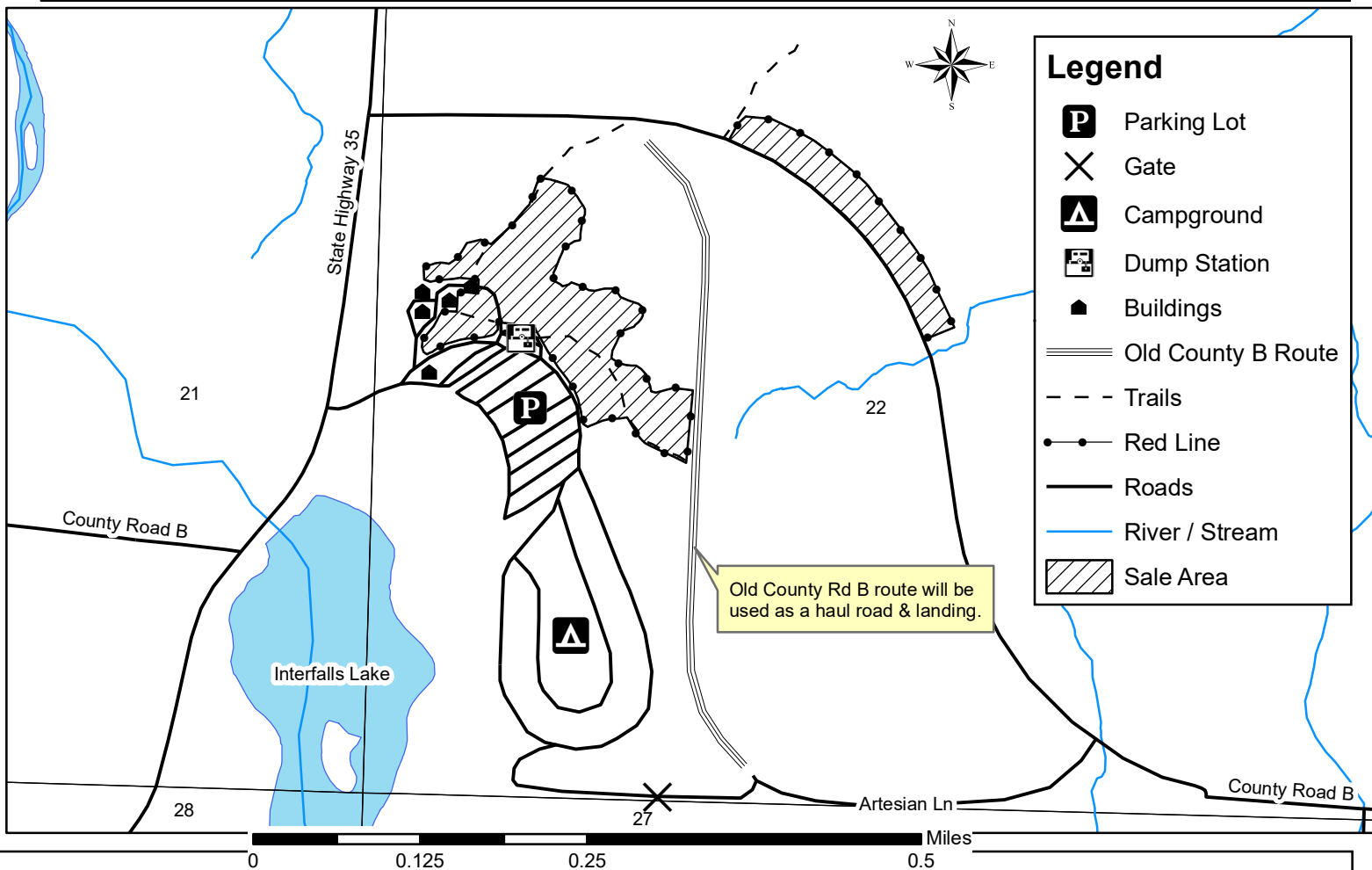

1. Sale boundaries are marked in red paint or bounded by obvious trails or roads.
2. Cut all aspen and balsam fir which contain one or more 100-inch stick to a 4-inch top diameter. Leave all other trees uncut and undamaged.
3. Slash height must not exceed 2 feet.
4. **Harvesting restricted to frozen ground conditions from November 15 – March 15.**
5. New road and/or landing construction must be approved by property manager or contract administrator. The main haul road and landings will be located on the old County Rd B corridor to the east of the timber sale. Access will be from the end of Artesian Ln; a berm will have to be removed and reinstalled.
6. No trees shall be felled onto park roads. No equipment shall be operated on park roads with exception of the forestry garage driveway.
7. Extra care should be taken when harvesting around park building and utilities to avoid damage. Utilities will be marked with flagging.
8. A more detailed map of the area surrounding park buildings can be requested from DNR Forester Jessica Krusensterna (715) 817-8423

\*\*\*\*Map is not a survey of the actual boundary of any property the map depicts\*\*\*\*