



Wisconsin Department of Natural Resources

C-Side Release Harvest -- South Shore Lake Superior FA

Forester: Joseph LeBouton 715-209-2149		Compartment: 3		Stand: 7		Tract Number: 406-01-22 Contract Number:
Twp: 49N	Range: 5W	Sec: 27	Township: Washburn	County: Bayfield		
Topography: level		Reforestation Code: Natural regen		Soil: Sand and clay		Acres: 15

Estimated Volumes				MBF	*Approximately 12% hard maple and 12% basswood; Average 9" dbh **Average 16" diameter + Average 8" diameter
Species	Whole Tree (Tons)	4" Roundwood (Tons)			
Red maple*	X	435	X		FROZEN SEASON ONLY, as determined by timber sale administrator. LOGGING AHEAD signs needed on Hwy C during active harvest operations that utilize the highway and may not be left up overnight.
Aspen**	X	260	X		
Balsam fir+	X	240	X		

MINIMUM BID: \$3069.00

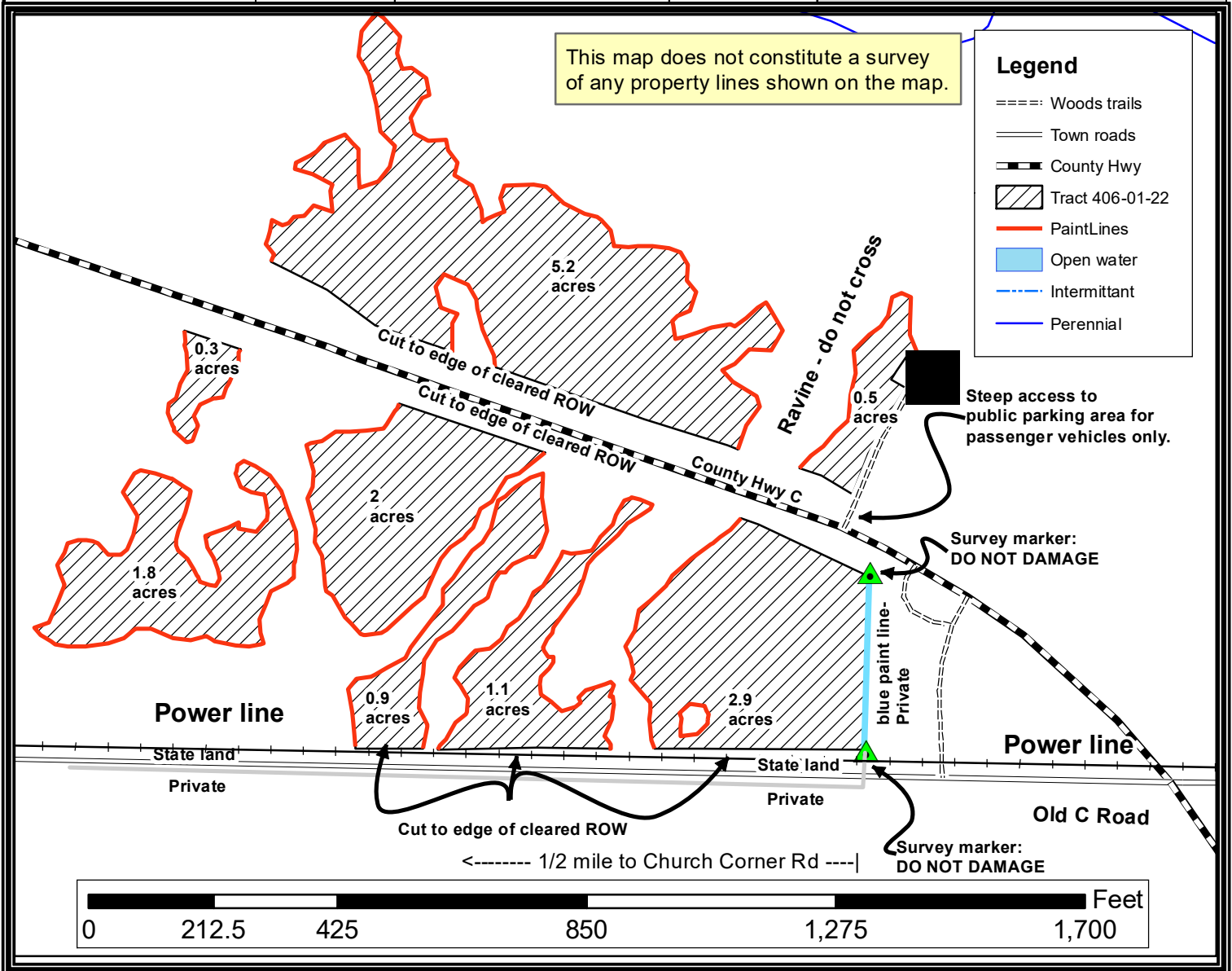

TRACT 406-01-22 – HARVEST REQUIREMENTS

The following terms and conditions supplement those provided in the Timber Sale Contract.

A. HARVEST REQUIREMENTS

1. HARVEST all trees 2 inches in diameter and above, EXCEPT:
2. DO NOT HARVEST OR DAMAGE red oak, hemlock, red pine, white pine, yellow birch, and white cedar (approximately 26 sq.ft./acre basal area residual.)
3. Leave all snags unless they pose a safety hazard to logging operations.

B. OPERATIONAL REQUIREMENTS and SEASONAL RESTRICTIONS:

1. The sale shall be harvested in frozen season only, as determined by the timber sale administrator, due to sand mantled red clay soils with high risk of rutting and erosion.
2. Sale boundaries are the blue-painted private property line to the east; Old C Road to the south, and red paint lines as shown on map.
3. Tops must be scattered throughout the sale and may not be left on landings.

C. ACCESS AND ROADS:

1. County Highway C is the primary access route for this sale. Contractor will work with Bayfield County Highway Department for necessary Temporary Driveway permits to cross highway ditches.
2. Old C Road provides access to the southern units of sale. Contractor will work with the Town of Washburn for necessary permits.
3. A power line parallels the north side of Old C Road along the entire southern boundary of timber sale area. Appropriate precautions must be taken.
4. Unharvested areas may be crossed for access to each unit with specific permission from sale administrator. Crossings must be protected using tree tops, timber mats, or other means to avoid rutting, as determined by sale administrator.
5. Timber mats are available for temporary use at no charge for use crossing Highway C ditches and other uses on this sale. Contractor would need to pick up timber mats at the Brule Ranger Station and would need to return the timber mats to the Brule Ranger Station at the completion of harvest operations.
6. This contract requires authorization from the timber sale administrator for all road/landing construction. Any roads, skid trails, and landings must be closed when sale is finished.
7. Decking of wood along town roads will not be allowed without permission from the timber sale administrator.

D. OTHER:

1. To comply with Best Management Practices for Invasive Species: Prior to moving equipment onto or off the sale area, scrape or brush soil and debris from exterior surfaces to the extent practical.
2. Do not damage survey monumentation.

