

Brule River State Forest

Sale Name: Triple A			Tract Number: 2-18	Estimated Volumes: TONS																								
Twp: 49N	Range: 10-11W	Section: 18,19,13,24	Compartment: 72,77	<table border="1"> <thead> <tr> <th rowspan="2">Species</th> <th colspan="2">TONS</th> <th rowspan="2">Ave DBH</th> </tr> <tr> <th>4" Top</th> <th>Whole Tree</th> </tr> </thead> <tbody> <tr> <td>Aspen</td> <td>975</td> <td>1400</td> <td>9</td> </tr> <tr> <td>Balsam Fir</td> <td>240</td> <td>350</td> <td>9</td> </tr> <tr> <td>MX</td> <td>1100</td> <td>1550</td> <td>9</td> </tr> <tr> <td>Minimum Bid</td> <td colspan="2">\$11,202</td> <td></td> </tr> </tbody> </table>			Species	TONS		Ave DBH	4" Top	Whole Tree	Aspen	975	1400	9	Balsam Fir	240	350	9	MX	1100	1550	9	Minimum Bid	\$11,202		
Species	TONS		Ave DBH																									
	4" Top	Whole Tree																										
Aspen	975	1400	9																									
Balsam Fir	240	350	9																									
MX	1100	1550	9																									
Minimum Bid	\$11,202																											
Township: Cloverland			Stand: 20,24,25,9,16																									
Soil: Clay	Topography: Flat/Rolling		Acres: 81																									
Seasonal Restrictions: Cutting /Hauling operations on very dry or frozen ground only. MX volume is 72% ash, 22% birch, and 6% maple. Fir volume is 62% spruce, 38% fir.																												

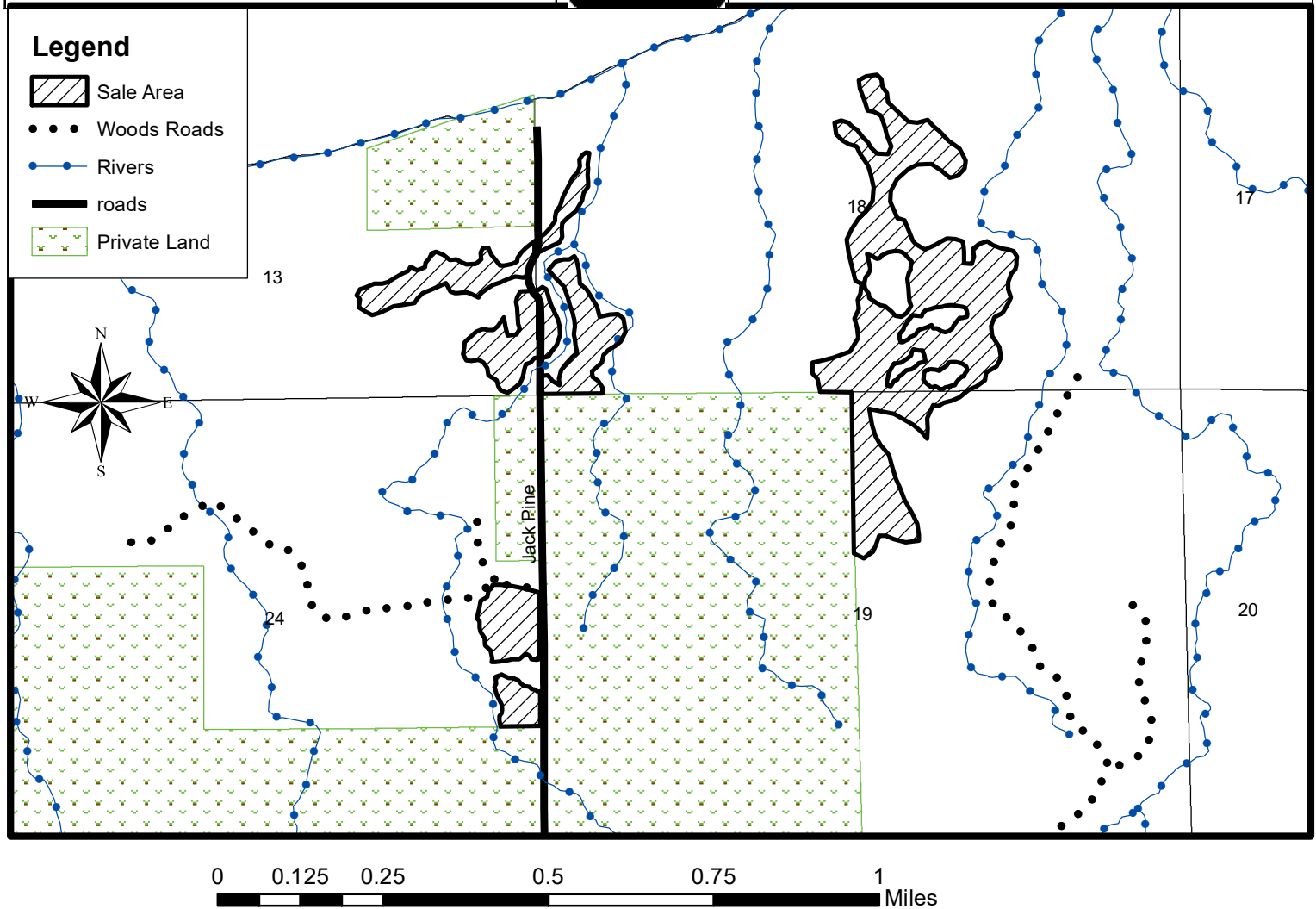

Cutting Specifications:

1. Sale boundaries marked in red or blue paint or bounded by obvious roads. Blue paint indicates private land and shall not be crossed.
2. Cut all maple, aspen, birch, and ash over 2" in diameter. Cut all spruce and fir which will make one or more 100" stick to a 4 inch top diameter. Leave all snags that do not pose a safety risk.
3. Utilize all cut trees which contain one or more 100" stick to a 4 inch top diameter. Slash height must not exceed 2 feet and must be lopped and scattered concurrent with harvest.
4. Care must be taken to avoid rutting. Dry or frozen conditions. Drainage crossings will be done only if frozen and with use of timber mats to avoid rutting. Timber mats available at Brule DNR office and must be transported and installed by contractor.
5. Access across private land may be available and must be arranged by the contractor.
6. Landings and roads must be approved by sale administrator.

*This map is not a survey of the actual boundary of any property this map depicts.