

# Brule River State Forest

Sale Name: <b>Partridge Patches</b>			Tract Number: 3-19	Estimated Volumes: TONS			
Twp: 47-48N	Range: 10W	Section: 2,3,34	Compartment: 55,57,58	Species	TONS	TONS	Ave DBH
Township: Brule			Stand: 19,16,16		Whole Tree	4 inch top	
Soil: Sand/Clay	Topography: Flat/rolling		Acres: 121	Aspen	10200	7400	8
Seasonal Restrictions: Dry or Frozen conditions needed. MX is 65% maple, 22% basswood, 10% ash, and 3% misc.				MX	700	500	8
				FIR	150	80	6
				Minimum Bid	<b>\$84,096</b>		

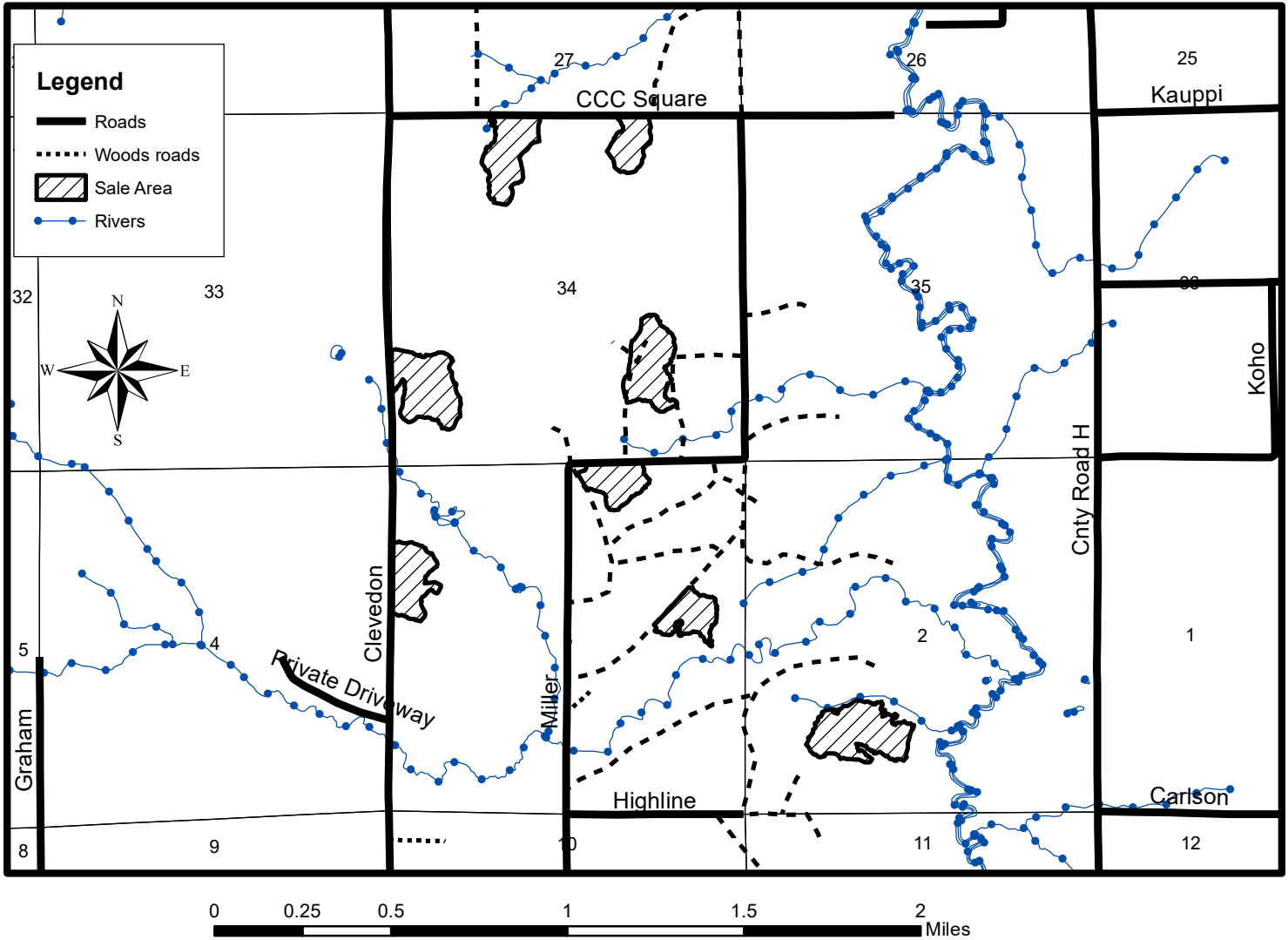

1. Sale boundaries marked in red paint or bounded by roads.

2. Cut all ash, white birch, aspen, maple, basswood, and fir that are 2 inches or greater DBH. Leave all other trees uncut and undamaged.

3. Minimum Utilization: Utilize all cut trees which contain one or more 100 inch stick to a 4 inch minimum top diameter. Slash height may not exceed 3 feet.

4. New road or landing construction must be approved by sale administrator. Town of Brule must be notified of any new road entrances and roadside decking.

\*\* This map is not a survey of the actual boundary of any property this map depicts.