

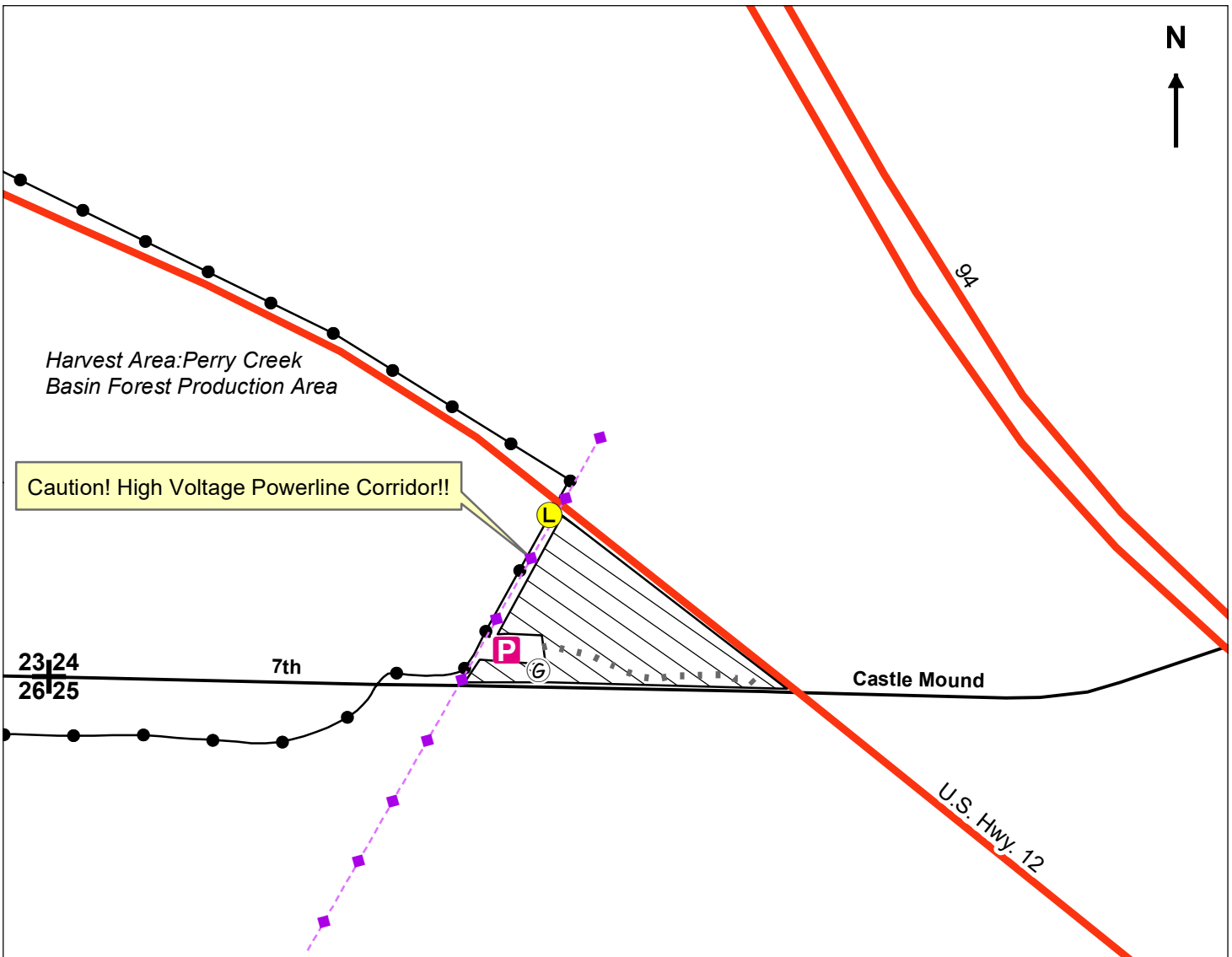

BLACK RIVER STATE FOREST  
 TIMBER SALE MAP  
 T21N-R 4W Section 24  
 TRACT # 22-25 Castle Mound Corner







Latitude: 44.278023  
 Longitude: -90.813684

9 Acres  
 Scale 8"=1 mile



**All parts of the sale require HRD treatment of pine stumps unless cut between Dec. 1 and March 31.**

 Regeneration harvest: Harvest all trees greater than 2" diameter at breast height. 9 acres.  
 Place logging slash on old ATV trail to deter vehicle use. Do not place logging slash in parking lot.

-  Proposed Landing - using ATV trail /powerline ROW
-  Overhead Powerline
-  Old ATV trail
-  ATV/Snowmobile Trail
-  Section Corner
-  Parking Lot
-  Gate

Sale Established  
 by Jennifer Boice  
 715-586-7111

This map is for informational purposes only and may not have been prepared for or be suitable for legal, engineering or surveying purposes. The user is solely responsible for verifying the accuracy of information before using for any purpose. By using this product for any purpose user agrees to be bound by all disclaimers found here: <https://dnr.wisconsin.gov/legal>.