

# Tank Creek Fisheries Area Timber Sale Map

T22N-R05W Sec. 26  
Tract #2-25 Landlocked Liquidation

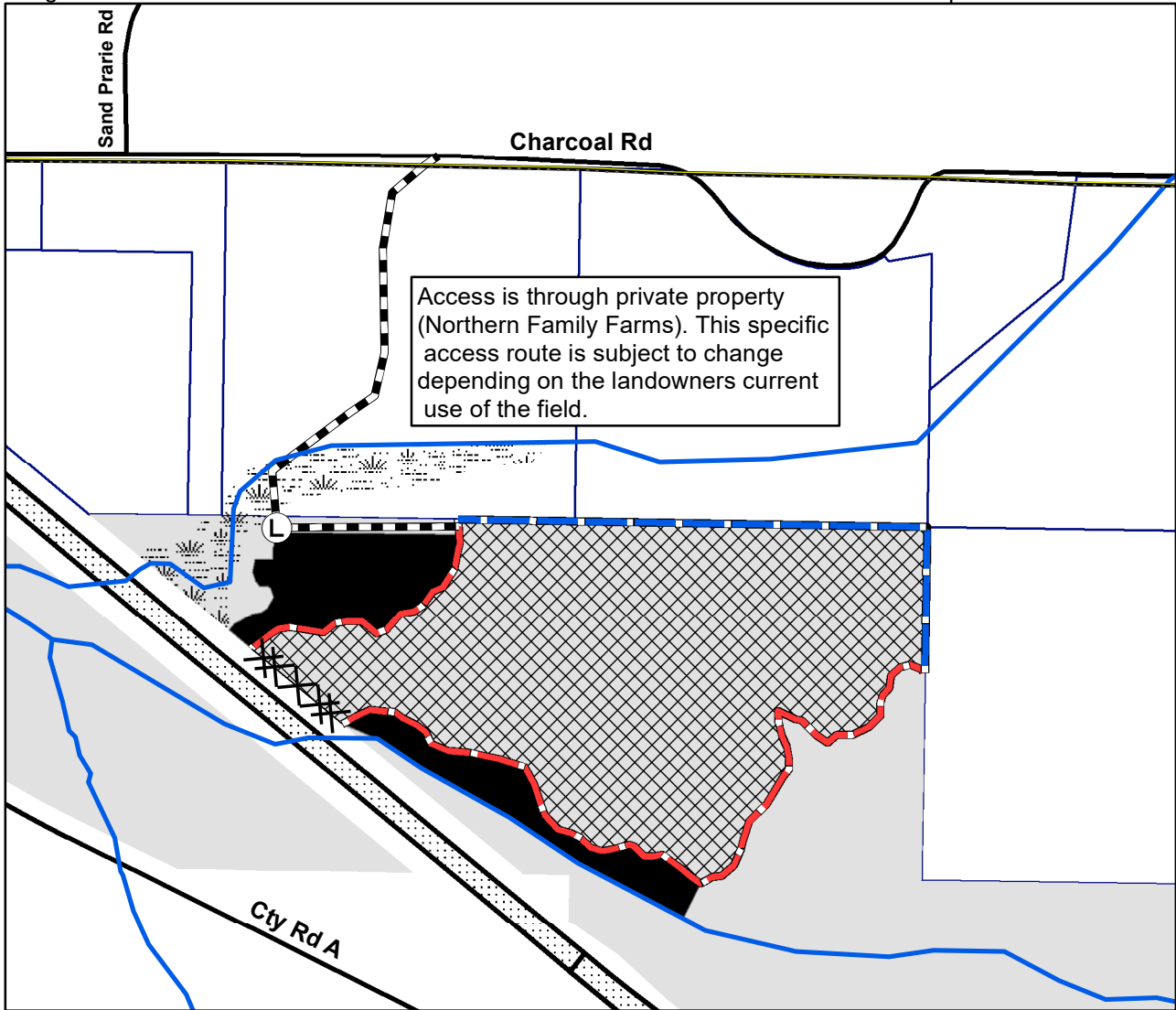

Latitude: 44.3602802  
Longitude: -90.9584840

Sale size: 46 Acres  
Map Scale: 1" = 1/8 mile

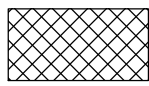

**This sale must occur on frozen ground only, due to access through a low ground area.**

 Regeneration Harvest: Cut all trees greater than 2" dbh except trees marked with purple paint and snags.

- |  |   |   |
|--|---|---|
|  Proposed Landing |  Sale Access     |  Roads                         |
|  Powerline        |  Wet Ground      |  RMZ and Retention (9.5 acres) |
|  Stream           |  Blue Paint Line |  State Property                |
|  Fence/Mowed ROW  |  Red Paint Line  |  I-94                          |

Sale Established by Nick Urich (715) 896-0536

This map is for informational purposes only and may not have been prepared for or be suitable for legal, engineering or surveying purposes. The user is solely responsible for verifying the accuracy of information before using for any purpose. By using this product for any purpose user agrees to be bound by all disclaimers found here: <https://dnr.wisconsin.gov/legal>.

