



Good Neighbor Authority
Wisconsin Department of Natural Resources
Washburn Ranger District
Chequamegon-Nicolet National Forest
Bayfield County, WI

Cherryville Pine

Tract # 8001-01-23

Acres: 321

Number of Zones: 2

Township/Range/Section:

T48N R6W Sec 31

T48N R7W Sec 25, 26, 36

DNR Contact & Lead Forester: Larin Krautkramer - (715) 781-5149

East Zone

(C146-S8, C153-23, and C153-S24)

— Boundaries are marked in **orange**.

 **Marked Thinning (176 Acres):** Cut all trees marked in **blue**.

 **Row thinning (46 Acres):** Cut every third row of red pine. At the beginning and end of each row, trees are marked with three **blue** slashes. Confidence trees in each row are marked with verticle **blue** lines.

Certain areas contain trees marked to cut in-between rows. Cut trees are marked in **blue**.

**Cut all aspen 2 inches and larger in all stands.*

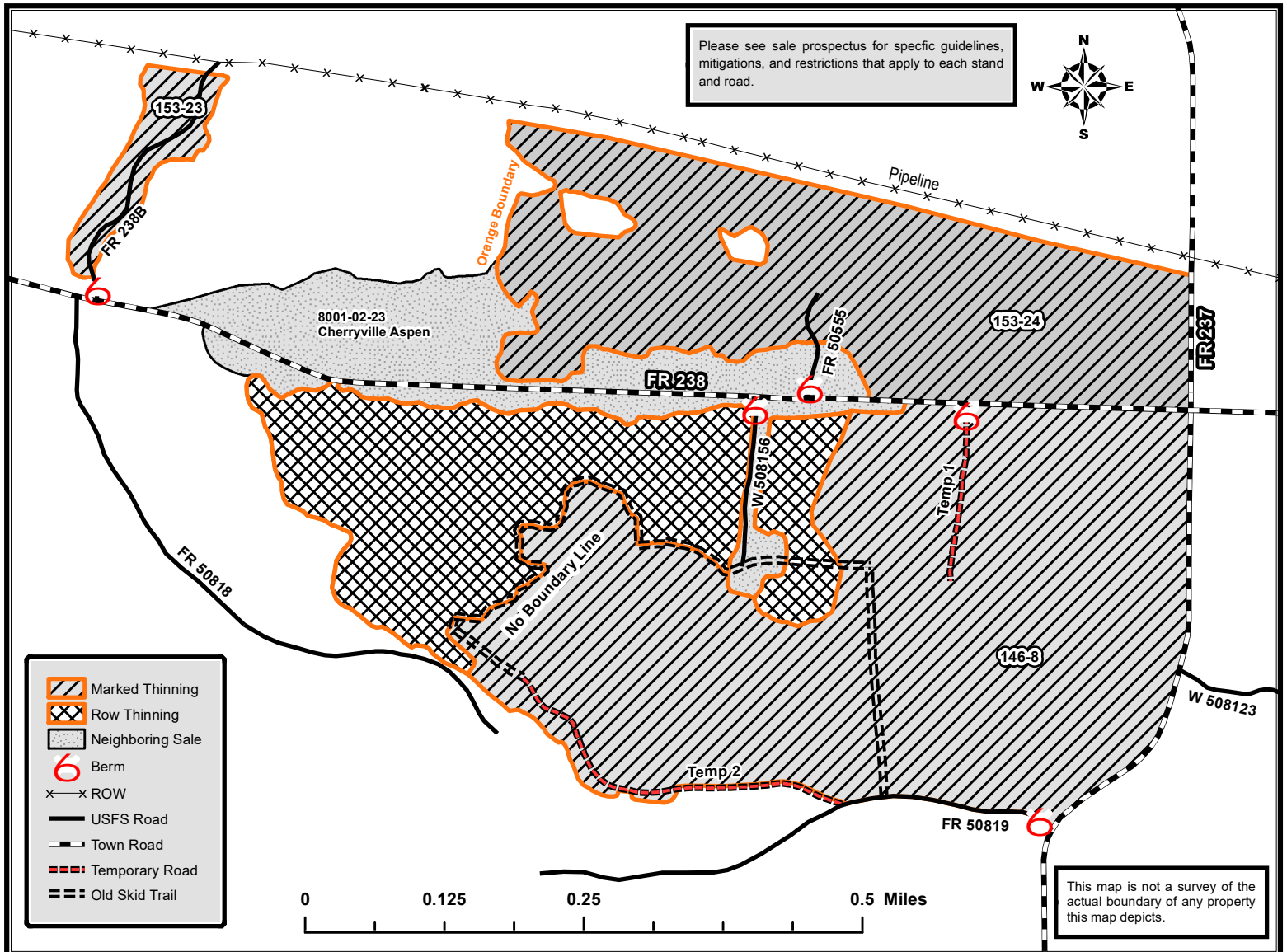



Good Neighbor Authority
Wisconsin Department of Natural Resources
Washburn Ranger District
Chequamegon-Nicolet National Forest
Bayfield County, WI

Cherryville Pine

Tract # 8001-01-23
 Acres: 321
 Number of Zones: 2
 Township/Range/Section:
 T48N R6W Sec 31
 T48N R7W Sec 25, 26, 36

DNR Contact & Lead Forester: Larin Krautkramer - (715) 781-5149

West Zone

(C153-S14, C153-S20, C153-S22, and C227-S43)

- Boundaries are marked in **orange**.
- Row thinning (13 Acres):** Logger select. Cut every third row of red pine.
- Marked Thinning (86 Acres):** Cut all trees marked in **blue**.

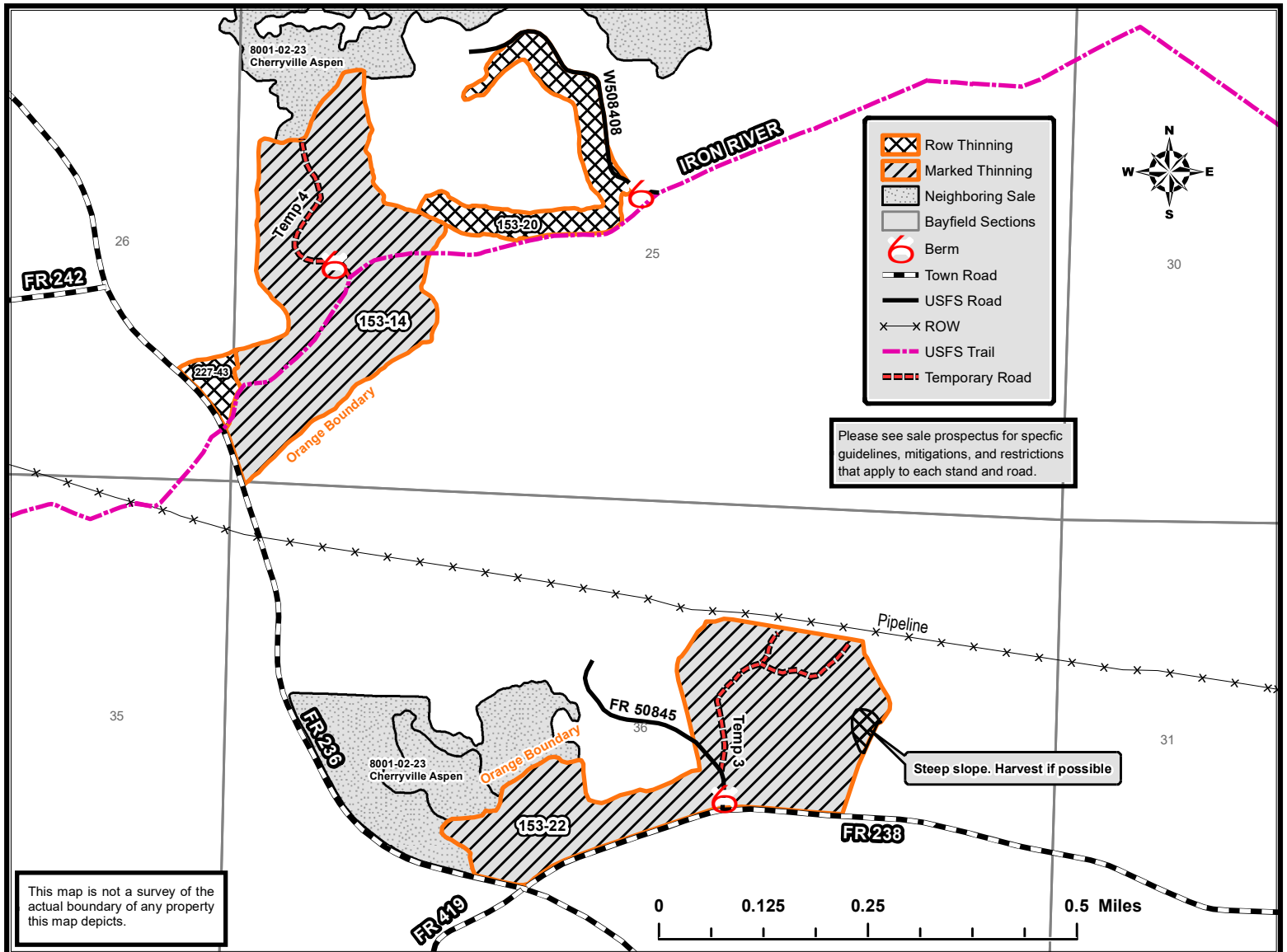



Good Neighbor Authority
Wisconsin Department of Natural Resources
 Chequamegon-Nicolet National Forest
 Washburn Ranger District

“Cherryville Pine”
Sale Area: 321 Acres
Tract # 8001-01-23

Location: Township of Barksdale / Bayfield County, Wisconsin

Comp-Stand	Town	Range	Section	Acres
146-8	48N	6W	31	154
153-24	48N	6W	31	62
153-22	48N	7W	36	44
153-14	48N	7W	25	42
153-20	48N	7W	25	11
153-23	48N	6W,7W	31,36	6
227-43	48N	7W	26	2

SPECIES	VOLUME
Red Pine	4000 CDS
Aspen	450 CDS
Jack Pine	200 CDS
Red Maple	30 CDS

Minimum Acceptable Bid: \$162,075.00

- Red pine conversion rate will be 2.250 tons per cord.
- Jack pine conversion rate will be 2.125 tons per cord.
- Red maple conversion rate will be 2.275 tons per cord.
- Aspen conversion rate will be 2.250 tons per cord.

*Red pine total contains approximately 1,200 mbf.

*Red maple total contains approximately 10% white birch.

Harvest Requirements

*Cutting prescriptions are listed on the sale map.



Design Features and Mitigation Measures

The following requirements apply to all stands:

- Do not harvest trees or operate equipment across orange paint line.
- The harvesting of any portion of a tree that lies outside the physical ownership of the Forest Service will not be allowed. Trees lying across the property line must be bucked at the ownership line and all portions of the tree that reside on the private side of the line must be left in place. Conversely, the remaining portion of the tree that lies within the physical ownership of the Forest Service may be harvested and utilized.
- Use of heavy equipment during excessively wet weather will be limited. This will be controlled during project administration. Season of operation would be year-round on this site.
- Discourage the spread of non-native invasive species, especially spotted knapweed, and the common buckthorn through proper cleaning of logging equipment before entering and leaving the sale area.
- Reserve all snags unless they pose a safety concern. A maximum of 10 snags per acre is desired.
- All pine products cut between May 1 and September 1 must be removed from the sale area within three weeks from time of cutting. Pine products cut during the remainder of the year must be removed prior to May 1 of each year.
- Chequamegon-Nicolet Forest Plan requires that all native surfaced approaches to paved or graveled roads have 100 ft. of gravel, 6 in. deep and 12 ft. wide put down when used during non-frozen conditions.
- All landings and skid trails will be blocked to vehicular access and possibly re-seeded at the conclusion of use if needed.
- Purchaser required to post signs on USFS roads alerting recreationalists of thinning activities.
- All road maintenance and rehabilitation post-harvest is the purchaser's responsibility. A sample contract including road maintenance specifications can be obtained by request.
- The location and clearing widths of all Temporary Roads shall be agreed to in writing before construction is started. "Temporary Roads" are roads other than Specified Roads that are constructed by Purchaser for the purpose of harvesting included timber.
- Temporary Roads shall have the road base constructed to a width of 12 feet or narrower, and with vegetative clearing of trees and brush not to exceed a width of 25 feet. Exceptions to the 12-foot maximum width of the road base may be granted by the sale administrator. Exceptions would typically be granted for sections of temporary roads where tight turns, curves, and terrain create a need so that trucks and equipment can be operated safely.
- All Temporary Roads and other Roads noted in prescription for use in sale will be closed from working when sale is completed. Due to excessive ATV use and "sand country" the Washburn District utilizes logging slash/stumps/debris for 100 feet beyond the berm. GNA sales will need to be consistent with current Washburn District Forest Service practice.
- Road maintenance and restrictions details are listed in the timber sale contract. Please contact a forester listed on the sale map for more information.

The following are stand specific slash requirements:

- All slash 100 feet from the edge of all roads and trails should not exceed 2 feet in height.
- All slash must be removed within 10 feet from any private boundary or recreational trail.
- Visible portions of timber harvesting, or other vegetation removal areas should receive the primary emphasis for slash treatment.

The following are specific road and trail requirements:

Iron River Trail:

- No hauling activities allowed during spring closure (March 15 – April 30th), on weekends or holidays (weekends are Friday 6 pm through Sunday at midnight; holidays include Memorial Day, 4th of July, Labor Day, Thanksgiving, Christmas Eve, Christmas, New Year's Eve & New Year's).



- If the trail is closed during logging operations, decks and landings can be placed on the trail bed. Where groomed trails are utilized for haul routes for winter operations, a mat of hard packed snow will be maintained on the trail at all times, except on short segments of steep (>15%) slopes. When possible, reroute the snowmobiles and/or ATVs during active sale operations to avoid user conflicts.
- For trails that remain open while being used for haul routes, signs notifying trail users to slow down and be aware of logging ahead will be posted on each end of the trail where timber harvest and hauling activities are occurring. Caution signs will also need to be placed at major intersections of roads that provide access to recreation sites or other trails. Timber activities occurring adjacent to motorized trails that are open for use during the logging operations will locate decks perpendicular to the trail in a way to prevent loading on the trail if possible.
- Skidding or forwarding will not be allowed on designated snowmobile/ATV trails, except to cross at right angles at designated crossings. In general, where trails are utilized for logging operations, the existing trail widths (tread width) will be maintained to a maximum of 12 feet wide.

Additional Requirements

- Cooperate with purchaser of neighboring sale “Cherryville Aspen” on timing of harvest to avoid conflict. Timely harvesting and road construction/maintenance will be needed between the two sales. A Dual Use Maintenance Agreement for USFS System Roads will need to be completed.
- Sale will be billed using mill ticket system.
- No bid bond required, a performance bond of 15% of the total sale bid value will be required.
- 3-year contract period. **Contract ending date of June 30, 2026.**
- **NO SALE MAY BEGIN WITHOUT PRIOR NOTIFICATION AND AN ON-SITE MEETING WITH A WISCONSIN DNR SALE ADMINISTRATOR.**

Larin Krautkramer
National Forest Liaison - Washburn District
Washburn Ranger Station 203 E Bayfield St.
Washburn, WI 54891
715-781-5149
larin.krautkramer@wisconsin.gov

Note: In order to fill and save this form electronically, it must be opened using Adobe Reader or Acrobat software. Save a copy of the file, open Adobe Reader, select File > Open and browse for the file you saved.

State of Wisconsin
Department of Natural Resources
dnr.wi.gov

Timber Sale Bid
Form 2400-049 (R 07/22)

Notice: Completion of this form is mandatory. The Department will not recognize your bid unless you complete and submit this form. Personal information collected will be used for program administration and may be provided to requesters as required by Wisconsin's Public Records law [ss. 19.31-19.39, Wis. Stats.].

Date

Bidder Name

Street Address	City	State	ZIP Code
----------------	------	-------	----------

Property Name (if any) CNNF - Washburn Ranger District	Timber Sale Name Cherryville Pine	Tract Number 8001-01-23
---	--------------------------------------	----------------------------

Date and Hour of Bid Opening May 3, 2023 @1:30 PM	Minimum Acceptable Bid (optional) \$162,075.00
--	---

Species-All bids including Lump Sum bids must be by species	Utilization Specifications (4 inch/Whole Tree/Logs)	Estimated Volume	Volume Units (tons/cords/mbf)	Price Bid Per Unit	Total Bid Value on Estimated Volume
Red Pine	4 in	4,000	Cords		
Aspen	4 in	450	Cords		
Jack Pine	4 in	200	Cords		
Red Maple	4 in	30	Cords		

The award shall be based on this TOTAL BID AMOUNT:

Performance Bond

Will be in the form of: (select one)

- | | |
|--|---|
| <input type="radio"/> Personal Check | <input type="radio"/> Assurance Bond |
| <input type="radio"/> Certified Check/Money Order | <input type="radio"/> Certificate of Deposit |
| <input type="radio"/> Irrevocable Letter of Credit | <input type="radio"/> Assignment of Savings Account |

I understand that any or all bids may be rejected and that consideration and awarding of a contract will be based upon my past performance and ability to complete contracts. **I also understand that if I am the winning bidder, I have 6 weeks from the date of the bid opening to submit an acceptable performance bond. I also understand that if I am awarded the contract and fail to execute it or work under it, I will be required to forfeit to the Department an amount equal to 10% of my total bid amount.** Failure to forfeit the 10% penalty will result in being considered ineligible to bid on any state timber sales for a two-year duration. In the event the highest bidder can not or will not sign the contract, the award may be made to the next highest qualified bid.

By checking this box, I certify that I hold a Wisconsin Master Logger Certification.

Notice: I understand:

Utilization specifications and estimated volumes are listed in the prospectus which is available upon request from the Department.

A copy of the standard timber sales contract which must be entered into is available upon request from the Department.

Signature of Bidder
Bidder's Name (Please Print or Type)
Phone Number (include area code)
Email Address

**DUAL USE MAINTENANCE AGREEMENT
 FOR USFS SYSTEM ROADS FOR TIMBER
 HARVEST PURPOSES**

Per the State of Wisconsin GNA Timber sale contract, section 18 part 8, when two or more commercial users are simultaneously using the same road, the commercial users will develop maintenance responsibilities and arrangements for accomplishing the work. The Seller (WI DNR and USFS) must agree to this plan. If the commercial users cannot agree on maintenance responsibilities, the Seller shall resolve the differences.

Contract A No: 8001-01-23 Cherryville Pine

Contract B: No: 8001-02-23 Cherryville Aspen

Purchaser A: #####

Purchaser B: #####

Purchaser A and Purchaser B agree to develop a maintenance plan for the roads listed below:

Per the contract, all roads and trails must follow the specifications and restrictions listed.

Purchaser A and B shall maintain roads, commensurate with Purchaser's use. Roads must be left in as good or better condition than existed prior to harvest. Performance of road maintenance work by Purchaser may be required prior to, during, or after each period of use. The timing of work accomplishment shall be based on Purchaser's operating schedule and road conditions. Specific required road maintenance specifications are included below.

Purchaser shall maintain roads in accordance with the following Contract Road Maintenance Requirements Summary:

Road	Termini		Miles	Timing: - Pre-haul - During - Post haul	Applicable Road Maintenance Specifications							
	From	To			8110	8420	8620					
FR 50555	FR 238	End of Use	.05	All	X	X	X					
FR 50845	FR 238	End of Use	.25	All	X	X	X					
W508156	FR 238	End of Use	.15	All	X	X	X					
W508408	Iron River Trail	End of Use	.35	All	X	X	X					
Iron River Trail	FR 236	W508158	.67	All	X	X						

Specification No.	Specification Title
T-8110	Maintenance Blading/Grading
T-8420	Cutting Roadway Vegetation
T-8620	Miscellaneous Maintenance

T-8110: Maintenance Blading/Grading is keeping an aggregate surfaced Roadbed in a condition to facilitate traffic and provide proper drainage. It includes maintaining the Crown, Inslope or Outslope of the Traveled Way, Turnouts, and Shoulder; repairing Berms; blending approach road intersections; and cleaning Drainage Dips and Lead-off Ditches.

T-8420: This work includes removal of brush, trees and other vegetative growth from within the clearing limits. This may include brush mowing of shoulders to prevent larger growth which would inhibit travel in the future.

T-8620: Maintenance of miscellaneous structures includes cattle guards, gates (this includes all types of closure devices such as logs, rocks, dirt berms, dirt and slash berms, metal gates, etc), signs, and other similar structures that have been previously installed to insure safe and efficient operation of the road.

Each person signing this Agreement personally warrants and represents that he or she is authorized to agree to this Agreement

By: _____ Date: _____

Purchaser A

By: _____ Date: _____

Purchaser B

By: _____ Date: _____
Wisconsin DNR/GNA Representative

By: _____ Date: _____
USFS Representative