



Good Neighbor Authority Sale Area Map
Wisconsin Department of Natural Resources

Southern Elk West Sale 8001-01-20

Chequamegon-Nicolet National Forest

Section 30 and 31 of T38N-R3E in Price County, WI

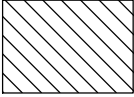

Single Tree Selection Area (137 acres)- Bounded by orange paint ,FR503D, and FR 503. Harvest all 1) blue marked trees, 2) aspen, 3) ironwood, 4) balsam fir with 1 or more sticks. Leave, do not cut 1) snags, 2) cull trees, 3) trees marked with orange paint. **Canopy gaps(4 acres)**- Bounded with purple paint. Harvest all trees greater than 2” **except for:** 1) purple marked trees, 2) oak 6” or less, 3) elm, 4) yellow birch, 5) white birch, 6) hemlock, 7) white pine, 8) butternut.

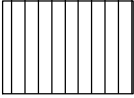

Red Maple/Aspen Area (105 acres)- Bounded by orange paint and FR 503. Harvest all trees greater than 2” **except for:** 1) orange marked trees, 2) oak 6” or less, 3) hemlock, 4) yellow birch, 5) butternut, 6) white pine, 7) white birch. Leave all standing snags and den trees. *(Intent is to harvest overstory trees and save as much regeneration as possible.)*

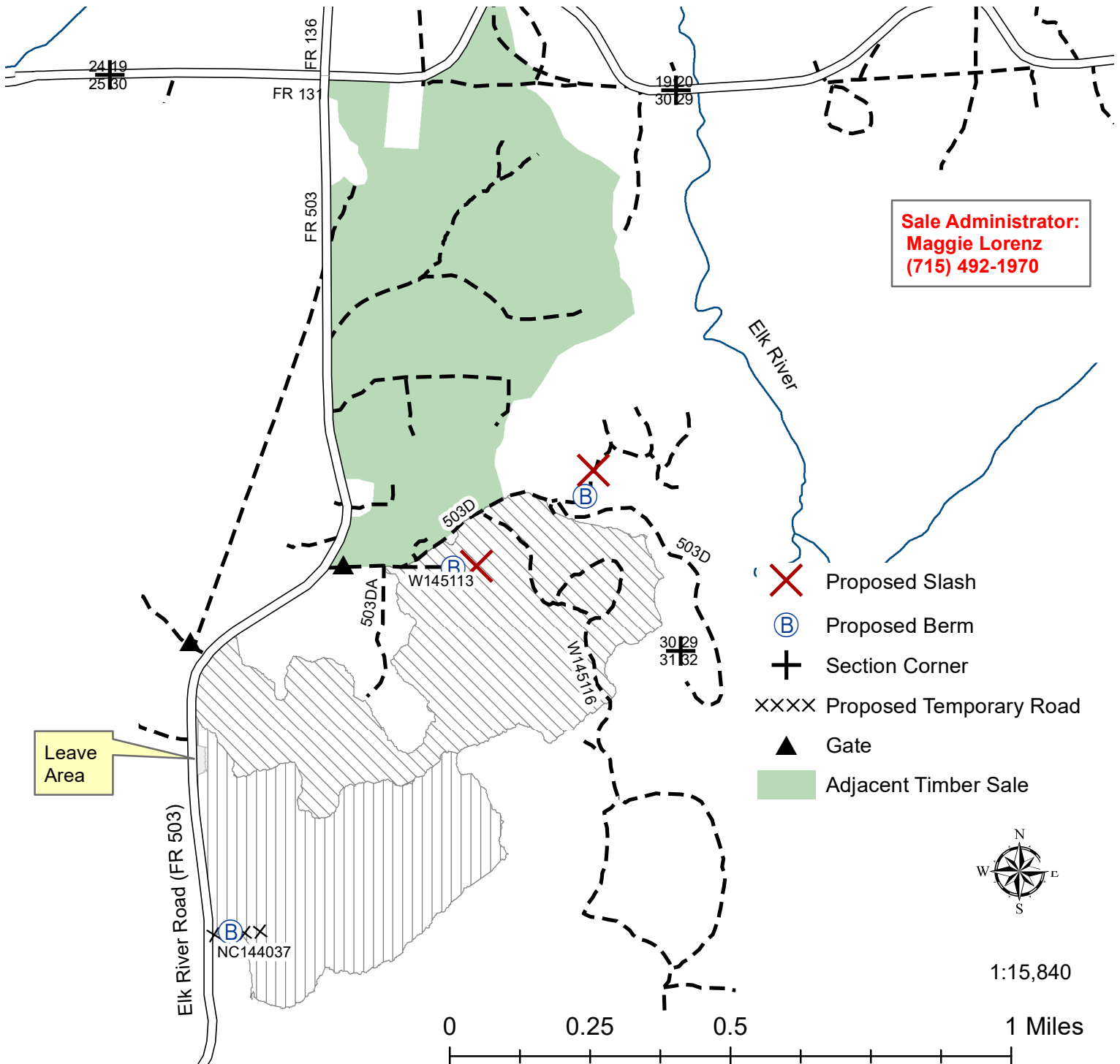

Sale Administrator:
Maggie Lorenz
(715) 492-1970

- Proposed Slash
- Proposed Berm
- Section Corner
- Proposed Temporary Road
- Gate
- Adjacent Timber Sale



1:15,840

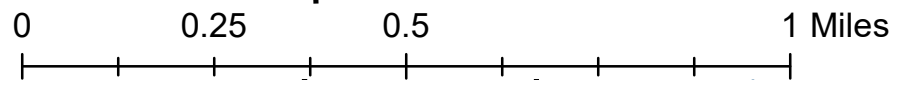



**Good Neighbor Authority Prospectus
Southern Elk West Sale
Medford-Park Falls Ranger District
Chequamegon-Nicolet National Forest
TRACT 8001-01-20**

Locations: Section 30 and 31 of T38N-R3 E in Price County, Wisconsin.

Sale Area: 246 acres

<u>SPECIES</u>	<u>VOLUME</u>	<u>ADVERTISED VALUE*</u>
MIXED HARDWOOD ¹	9750 TONS	\$8.60/TON
BASSWOOD ²	390 TONS	\$6.90/TON
ASPEN	1450 TONS	\$7.80/TON
SPRUCE ³	100 TONS	\$5.60/TON
OAK ⁴	370 TONS	\$13.00/TON

Minimum Acceptable Bid: \$103,221.00

¹Mixed hardwood consists of approximately 17% hard maple, 45% red maple, 37% ash, 1% ironwood, white birch, and elm combined. Includes 148 MBF Ash, 15 MBF Red Maple, and 15 MBF Hard Maple.

²Basswood volume includes 22 MBF basswood.

³Spruce volume includes 60% white spruce and 40% balsam fir.

⁴Oak volume includes 18 MBF red oak.

*Other species not mentioned will be charged at the mixed hardwood price.

*Species/product bids may be less than advertised value, but more than \$0.00 and bids must meet or exceed the total minimum bid of **\$ 103,221.00.**

*Conversion rates utilized: MX-2.34, Basswood-1.925, Aspen-2.250, Spruce-2.000, Oak-2.750, Balsam Fir-2.125

Paint Color Scheme:

- **Orange:** Stand boundary and leave trees. Do not cut any orange marked trees.
- **Blue:** Cut trees.
- **Purple:** Canopy gap boundary and leave trees. Do not cut any purple marked trees.

Seasonal Restrictions:

- Harvesting operations are limited to **frozen only.**

Harvest Requirements:

- Harvest boundaries include: orange paint line, Forest Service Roads, town road.
- Sale will be mill scale using a 30-day billing period.
- No bid bond required. A performance bond of 15% of the total sale value will be required. Contract length will be approximately **3 years.**
- No machine operation is allowed outside of orange boundary paint line.
- Equipment must be cleaned and inspected by DNR Staff before entering and leaving the sale area to prevent the introduction/spread of invasive species.
- Logging Operations Ahead (DOT approved) are required to be placed on FR 503 and FR 131 Sheep Ranch Road during harvest and hauling operations.

Slash Requirements:

- All slash that is 150 feet from FR503 shall have slash reduced to within 24” of the ground.

Road/Trail Requirements:

- Skidding is not allowed on FR503 or FR131.
- Contractor is responsible for attaining decking permission along roads maintained by township. Landings should be located 100 feet from collector road. Decking locations will be discussed at pre-sale meeting.
- Any non-frozen hauling will require approaches to be graveled, 100 feet by 12 feet and 6 inches deep. Forest Service will supply gravel at their pit. Culverts and fill or timber mats may be required to access portions of the sale. Culverts and mats are the responsibility of the contractor. Fill will be provided from a Forest Service pit.

Additional Requirements:

- NO SALE MAY BEGIN WITHOUT PRIOR NOTIFICATION AND ON-SITE MEETING WITH A WISCONSIN DNR SALE ADMINISTRATOR.
- Keep all logging debris and machine operations within sale boundaries.
- Leave all standing snag and den trees that do not pose a safety hazard.
- Gate shall remain closed and locked during non-working hours.
- Any new temporary roads or turn-arounds will need approval by the timber sale administrator.
- Temporary Roads shall have the road base constructed to a width of 12 feet or narrower, and with vegetative clearing of trees and brush not to exceed a width of 25 feet. Exceptions to the 12 foot maximum width of the road base may be granted by the sale administrator. Exceptions would typically be granted for sections of temporary roads where tight turns, curves, and terrain create a need so that trucks and equipment can be operated safely.
- The main haul road, 503D is used for multiple sales, it is the responsibility of the contractors of sales to determine the logistics for hauling and/or road repair.
- If roads that are marked with “Proposed Berm” and or “Proposed Slash” symbol on the map are utilized than they must be closed with a logging debris berm and shall be slashed behind berm. The intent is to render road inaccessible by reclaiming the first 300 feet. Berms, boulders, downed trees, logging debris, and slash shall be used. Berm height will be 4-5 feet high. Berm material can be: soil or rocks (large boulders unable to move with manpower or truck) as well as slash and/or stumps piled within temporary road beginning at the location of where berm will be established. Do not dig a depression that will collect and hold water when constructing berms.
- All road maintenance and post-harvest rehabilitation will be the purchaser’s responsibility. A sample contract including road maintenance specifications can be obtained by request from the contact below:

Maggie Lorenz- National Forest Liaison Forester
Park Falls DNR Service Center
875 S. 4th Ave.
Park Falls, WI 54552
715-492-1970
Margaret.Lorenz@wisconsin.gov