

Good Neighbor Authority Sale Area Map

Wisconsin Department of Natural Resources

Catch Up West Sale
 Eagle River-Florence Ranger District
 Chequamegon-Nicolet National Forest
 T42N-R11E, Sec 15, 22, 23
 Vilas County
 Tract Number: 8002-108-20

Legend	
	Gates
	Section Corner
	Lowland
	Red Line
	Orange Sale Boundary Line
	Undefined Road
	USFS Roads
	USFS Snowmobile Trails
	Birch/Fir Inclusion Area
	Highways and Town Roads
	Lakes and Open Water
	Streams

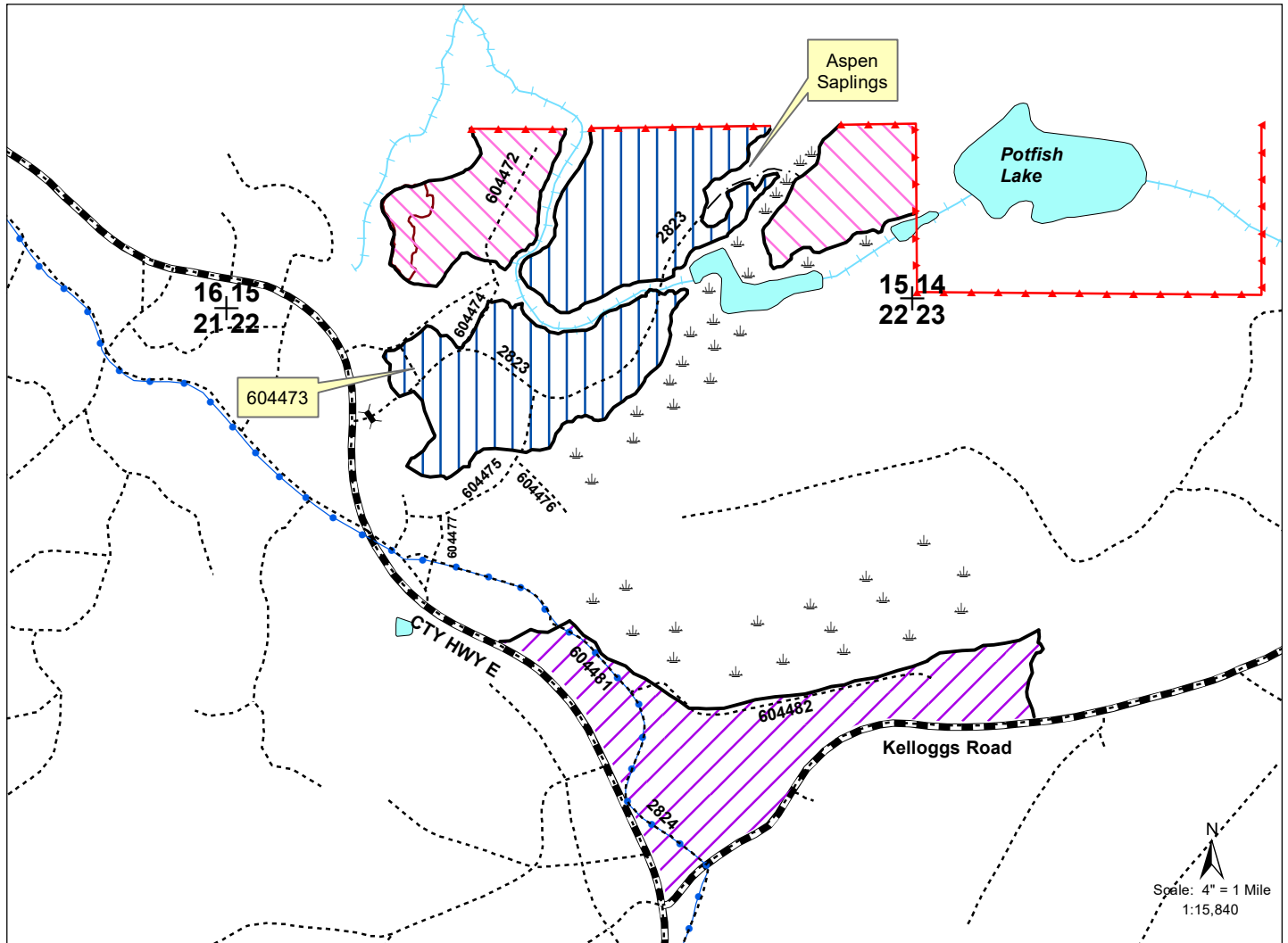

Stands 2157-1, 2157-20: Northern Hardwood Selection Harvest (42 acres): Cut all merchantable ironwood, balsam fir and all blue marked trees. Cut all trees greater than 1 inch inside purple painted gaps including purple painted trees. Do NOT cut any hemlock and white pine.



Stands 2157-3, 2157-9 - Selection Harvest Area (78 Acres): Cut all merchantable ironwood, balsam fir, aspen and all blue marked trees. Cut all greater than 1 inch inside purple painted gaps including purple painted trees. Do NOT cut any hemlock.



Stands 2155-5, 2155-7, 2157-16, 2157-17, 2157-25 - Selection Harvest Area (65 Acres): Cut all merchantable ironwood, white birch, balsam fir, aspen and all blue marked trees. Cut all greater than 1 inch inside purple painted gaps including purple painted trees.

ALL STANDS: Leave blue and purple paint marks visible on the stump. Harvesting may occur during frozen ground conditions or during dry, firm conditions with prior approval. Harvesting may NOT occur from March 15 to July 15

ROAD RESTRICTIONS APPLY. See prospectus for restrictions and definitions.



Map produced by
 Paul Stearns 02/24/2020



Good Neighbor Authority
Wisconsin Department of Natural Resources
 Eagle River/Florence Ranger District
 Chequamegon-Nicolet National Forest

Catch Up West - Prospectus
Tract #: 8002-108-20

Location: Vilas County, WI

Town	Range	Section	Description
42N	11E	15	SESE, SWSE, SESW, SWSW
42N	11E	22	NENW, SENW, NWNE, SWNE
42N	11E	22	NWSE, NESE, SWNE, NESW
42N	11E	23	NWSW

Estimated Volumes and Values:

SPECIES	Cords	MBF
Mixed Hardwood ^{1,2}	1550	15
Hard Maple		180
Basswood		65
Fir ³	45	
TOTALS	1595 Cords	260 MBF

Minimum Acceptable Bid: \$72,761.50

MX Pulp¹: Approximately 76% hard maple, 9% basswood, 6% yellow birch, 3% soft maple, 2% aspen, 2% white birch, <1% oak, ash, black cherry and ironwood (weight conversion factor = 2.443 tons/cd).

MX Logs²: Approximately 47% yellow birch (7 MBF), 20% soft maple (3 MBF), 13% red oak (2 MBF), 7% black ash (1 MBF), 7% black cherry (1 MBF), 6% white birch (<1 MBF).

F³: Approximately 91% balsam fir, 9% white spruce (weight conversion factor = 2.113 tons/cd).

Vilas County base stumpage rates used for product values (converted from tons pricing in Timber Sale HB.)

General Harvest Information:

- Mill Scale Sale.
- No bid bond required. A performance bond of 15% of the total sale bid value required.
- The cutting area is approximately 185 acres.
- The contract period is **2 YEARS**.
- **Harvesting or other site-disturbing activities may not occur from March 15 to July 15.**
- Cutting areas bounded by **ORANGE** paint and established roads. See sale maps for details.
- Canopy gap areas designated by **PURPLE** paint; cut all trees 1" inch or greater in diameter within canopy gap areas including purple painted trees.
- Leave purple and blue paint marks visible on the stump.
- Do not harvest trees, drop slash, or operate equipment across orange paint line.
- Damage to any residual trees will not be tolerated.
- Utilization to at least a 4-inch top.
- Harvesting in cutting areas (stands) must be completed prior to moving to another cutting area. All species within area must be cut concurrently.

Cutting Prescription:

Stands 2157-1, 2157-20: Northern Hardwood Selection Harvest (42 acres)

- Cut all merchantable ironwood, balsam fir and all blue marked trees.
- Cut all trees greater than 1 inch inside purple painted gaps including purple painted trees.
- Do NOT cut any hemlock and white pine.

Stands 2157-3, 2157-9: Northern Hardwood Selection Harvest (78 acres)

- Cut all merchantable ironwood, balsam fir, aspen and all blue marked trees.
- Cut all trees greater than 1 inch inside purple painted gaps including purple painted trees.
- Do NOT cut any hemlock.

Stands 2155-5, 2155-7, 2157-16, 2157-17, 2157-25: Northern Hardwood Selection Harvest (65 acres)

- Cut all merchantable ironwood, white birch, balsam fir, aspen and all blue marked trees.
- Cut all trees greater than 1 inch inside purple painted gaps including purple painted trees.

Special Conditions:

- **NO SALE MAY BEGIN WITHOUT PRIOR NOTIFICATION AND AN ON-SITE MEETING WITH A WISCONSIN DNR SALE ADMINISTRATOR.**
- **SEASONAL RESTRICTIONS:**
 - **ALL STANDS: Harvesting may occur during frozen conditions or during dry, firm conditions *with prior approval*. Harvesting or other site-disturbing activities may not occur from March 15 to July 15.**
- Equipment must be cleaned before entering and leaving sale area to prevent the introduction and spread of invasive species.
- In all harvest areas, reserve standing snags that do not pose a safety risk.
- Slash must be kept less than or equal to 24" throughout and pulled 10' from roads, trails and private property lines. All slash must always be kept clear of travel ways and out of wetlands and riparian areas.
- Safety signs are required on public trails (Snowmobile Trail #33275/ FRD602281/ 2824) and roads entering active harvest areas.
- Chequamegon-Nicolet Forest Plan requires that all native surfaced approaches to paved or graveled roads have 100 ft. of gravel, 6 in. deep, 12 ft. wide put down when used during non-frozen conditions.
- Purchaser is responsible to obtain written permission from local town to deck wood on town roads. Decking locations will be determined at pre-sale meeting.
- Any new temporary roads or turn-arounds will need approval by the timber sale administrator.
- The location and clearing widths of all Temporary Roads shall be agreed to in writing before construction is started. "Temporary Roads" are roads other than Specified Roads that are constructed by Purchaser for the purpose of harvesting included timber.
- Temporary Road 604482 will be closed prior to sale completion with berms. Upon sale completion roads shall be closed by construction of two mounds at approximately 75-foot intervals with scattered slash and logging debris between the mounds. Mounds shall be at least four feet in height and shall be made with dirt mixed with rocks, stumps, logs, root-wads, or slash and shall be constructed without creating a defined trench. All other forest roads shall remain open to vehicle travel.
- Temporary Roads shall have the road base constructed to a width of 12 feet or narrower, and with vegetative clearing of tree and brush not to exceed a width of 25 feet. Exceptions to the 12-foot maximum width of the road base may be granted by the sale administrator. Exceptions would typically be granted for sections of temporary roads where tight turns, curves, and terrain create a need so that trucks and equipment can be operated safely.
- All road maintenance and rehabilitation post-harvest is the purchaser's responsibility. A sample contract including specific road maintenance specifications can be obtained by request. Contact DNR Forester Kelsey Dencker at (715) 216-0286 for more information.

Road Restrictions List:

Road Number	Road Name	Termini		Map Legend	Description of Restrictions
		From	To		
604472	FDR604472	604474	End of Use	R	1. Used only during surface firm or frozen conditions.
604473	FRD604473	604472	604474	R	1. Used only during surface firm or frozen conditions.
604474	FRD604474	604472	2823 Snap Road	R	1. Used only during surface firm or frozen conditions.
2823	2823 Snap Road	CTY HWY E	End of Use	R	1. Used only during surface firm or frozen conditions.
604475	FRD604475	2823	Orange Line	R	1. Used only during surface firm or frozen conditions.
604482	FRD604482	604481	End of Use	R	1. Used only during surface firm or frozen conditions.
604481	FRD604481	604482	Orange Line	R	1. Used only during surface firm or frozen conditions. 2. Hauling is prohibited on the Snowmobile Trails on Federal Holidays, weekends starting noon on Friday, through midnight Sunday, and also between Christmas Day and New Year's Day. At all times during the snowmobile season, keep at least 4" of packed snow on the trail. Keep trail clearing (10' from the edge of the trail) cleared of debris resulting from purchaser's operations as work progresses. Do not deck wood on inside curves, where it could obscure oncoming traffic.
2824	2824	604481	2564 Kelloggs Road	R, A	1. Used only during surface firm or frozen conditions. 2. Hauling is prohibited on the Snowmobile Trails on Federal Holidays, weekends starting noon on Friday, through midnight Sunday, and also between Christmas Day and New Year's Day. At all times during the snowmobile season, keep at least 4" of packed snow on the trail. Keep trail clearing (10' from the edge of the trail) cleared of debris resulting from purchaser's operations as work progresses. Do not deck wood on inside curves, where it could obscure oncoming traffic.
604472	FRD604472	CTY HWY E	604474	P	Prohibited
604475	FRD604475	Orange Line	604477	P	Prohibited

Road Maintenance Requirements Summary:

Purchaser shall maintain roads, commensurate with Purchaser's use. Roads must be left in as good or better condition than existed prior to harvest. Performance of road maintenance work by Purchaser may be required prior to, during, or after each period of use. The timing of work accomplishment shall be based on Purchaser's operating schedule and road conditions. Specific required road maintenance specifications are included below.

Purchaser shall maintain roads in accordance with the following Contract Road Maintenance Requirements Summary:

Road	Termini		Miles	Timing: Pre-haul During Post haul	Applicable Road Maintenance Specifications		
	From	To			8110	8420	8130
604472	604474	End of Use	0.2	All above	X	X	
604473	604472	607747	0.1	All above	X	X	
604474	604472	2823	0.1	All above	X	X	
2823	CTY HWY E	End of Use	0.7	All above	X	X	
604473	604472	2823	0.1	All above	X	X	
6044753	2823	Orange Line	0.1	All above	X	X	
604482	604481	End of Use	0.5	All above	X	X	
604481	604482	Orange Line	0.15	All above	X	X	
2824	604481	Kellogs Rd	0.3	All above	X	X	
2564	CTY HWY E	Orange Line	0.7	All above	X	X	

Specification No.	Specification Title
T-8110	Maintenance Blading/Grading
T-8420	Cutting Roadway Vegetation

T-8110: Maintenance Blading/Grading is keeping an aggregate surfaced Roadbed in a condition to facilitate traffic and provide proper drainage. It includes maintaining the Crown, Inslope or Outslope of the Traveled Way, Turnouts, and Shoulder; repairing Berms; blending approach road intersections; and cleaning Drainage Dips and Lead-off Ditches.

T-8420: This work includes removal of brush, trees and other vegetative growth from within the clearing limits. This may include brush mowing of shoulders to prevent larger growth which would inhibit travel in the future.