

Good Neighbor Authority Sale Area Map Wisconsin Department of Natural Resources



Tahkodah Lake Sale
Washburn Ranger District
Chequamegon-Nicolet National Forest
T44N R7W Section 34
Bayfield County
Tract 8001-07-17



South Lake Owen Dr.

South Lake Owen Dr.



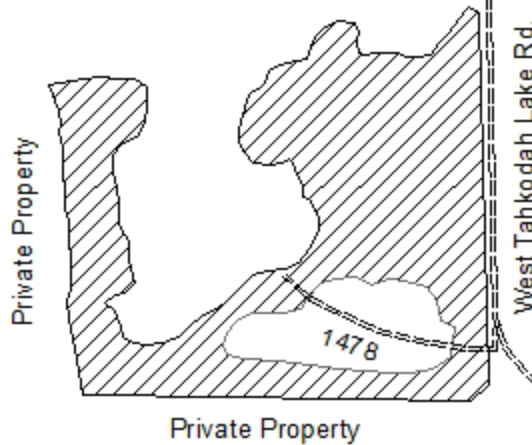

Pioneer Rd.



 Red Pine Thinning (19 acres): Cut all trees marked in Blue Paint.

Sale boundaries are painted in Orange.

Legend

-  Red Pine Thinning
-  Roads
-  Quarter Corner
-  Tahkodah Lake

0 0.05 0.1 0.2 Miles



34 34
+
3 3

Lake Tahkodah

Sale Prepared by:
David Todus
Sawyer County Forester



Good Neighbor Authority Timber Sale

Tahkodah Lake Sale

Washburn Ranger District

Chequamegon-Nicolet National Forest

Tract #. 8001-07-17

Location:

Town	Range	Section	Description
44N	7W	34	NESW

Sale Area: 19 Acres

SPECIES	VOLUME	Advertised Price	TOTAL
Red Pine	335 Cords	\$44.60/cord	\$14,941.00
White Pine	10 Cords	\$40.40/cord	\$404.00

- Red Pine/White Pine volume is advertised as mixed product, and will be sold and scaled as cordwood.
- Red Pine mixed product is estimated 55MBF based on 8" small end DIB and 205 cords pulpwood.
- White Pine mixed product is estimated at 2MBF based on 8" small end DIB and 5 cords pulpwood.

Minimum Acceptable Bid: \$15,345.00

Harvest Requirements: Red Pine Thinning: (19 acres) Cut all trees marked in Blue Paint.

Sale boundaries are painted in orange.

Additional Requirements:

- Sale may be cut all season, but cut pine may not be kept on site for more than 21 days from May 1st through Aug. 31st.
- Biomass harvesting is restricted. Leave all tops and limbs < 4" diameter from all trees.
- All slash must be kept clear of travel ways at all times, and out of wetlands and riparian areas. Slash heights need to be 2ft or less within 100ft. of West Tahkodah Lake Rd. Complete slash removal within 10ft adjacent to private property boundaries.
- Known areas with weed infestation will be flagged by sale administrator and avoided during operations.
- Sale will be mill scaled sale and billed using the mill ticket system.
- No bid bond required, a performance bond of 15% of the total sale bid value will be required. 2 year contract period.
- Reserve all snags that do not pose a safety risk.
- Equipment must be inspected by sale administrator and clean of dirt and debris before entering sale area.
- Safety signs are required on public trails and roads entering active harvest areas.

Road and Skid Trails:

- Forest plan requires that all native surfaced approaches to paved or graveled roads have 100' of gravel put down 6 inches thick and 12' wide when used during non-frozen conditions.
- All landings and skid trails will be blocked to vehicular access and possibly re-seeded at the conclusion of use if needed.
- Temporary Roads shall have the road base constructed to a width of 12 feet or narrower, and with vegetative clearing of trees and brush not to exceed a width of 25 feet. Exceptions to the 12 foot maximum width of the road base may be granted by the sale administrator. Exceptions would typically be granted for sections of temporary roads where tight turns, curves, and terrain create a need so that trucks and equipment can be operated safely. Road ID 1478 must be restored to pre-sale condition or better.
- All road maintenance and rehabilitation post-harvest is the purchaser's responsibility. A sample contract including road maintenance specifications can be obtained by request. Contact County Forester David Todus at the Sawyer County Forestry Dept. at (715)634-4846 for more information.