

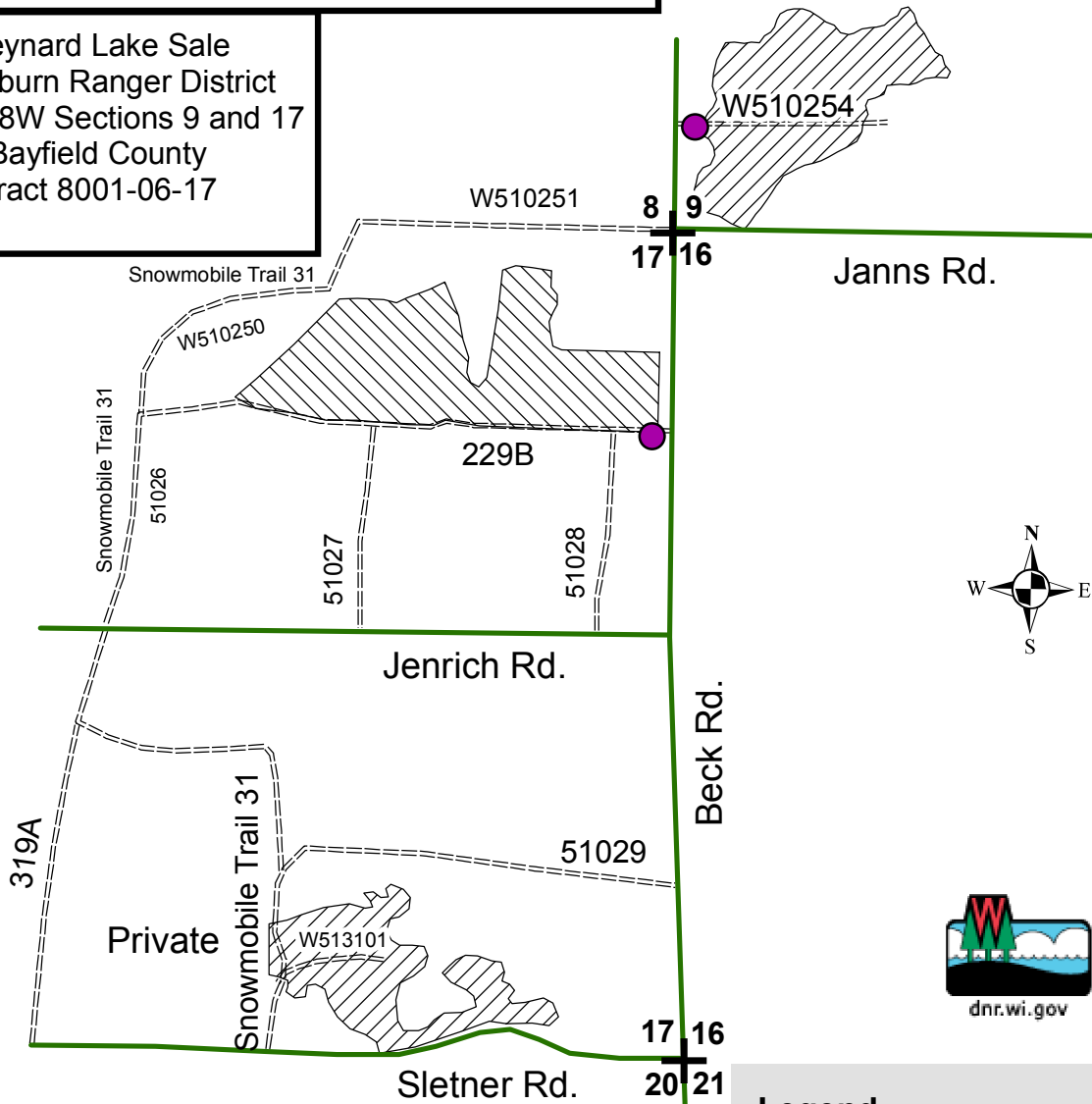

Good Neighbor Authority Sale Area Map
Wisconsin Department of Natural Resources

Reynard Lake Sale
 Washburn Ranger District
 T45N R8W Sections 9 and 17
 Bayfield County
 Tract 8001-06-17







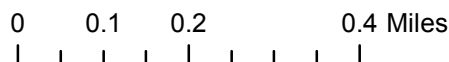

Sale boundaries are painted in Orange.

 Red Pine Row Thinning (38 acres):
 Cut all trees within every 3rd row.
 Cut row ends are marked in Blue Paint.
 Additional trees are painted Blue
 within cut rows for orientation.

 Red Pine Select Cut (43 acres):
 Cut all trees marked in Blue Paint.



Legend

-  Section Corner
-  Berms
-  Town Roads
-  Woods Roads
-  Red Pine Row Thinning
-  Red Pine Select Cut

Sale Prepared by:
 David Todus
 Sawyer County Forester



Good Neighbor Authority Timber Sale

Reynard Lake Sale

Washburn Ranger District

Chequamegon-Nicolet National Forest

Tract #. 8001-06-17

Location:

| Town | Range | Section | Description |
|------|-------|---------|----------------|
| 45N | 8W | 9 | S1/2SW |
| 45N | 8W | 17 | N1/2NE, S1/2SE |
| | | | |
| | | | |

Sale Area: 81 Acres

| SPECIES | VOLUME | Advertised Price | TOTAL |
|------------|-----------|------------------|-------------|
| Red Pine | 915 Cords | \$41.90/cord | \$38,338.50 |
| White Pine | 75 Cords | \$38.00/cord | \$2,850.00 |
| Jack Pine | 60 Cords | \$24.00/cord | \$1,440.00 |
| Mix Hdwd | 5 Cords | \$24.00/cord | \$120.00 |

- Red and White Pine volume is appraised as mixed product, and will be sold and scaled as cordwood.
- Red pine volumes are estimated 217MBF based on 8" small end DIB and 390 cords pulpwood.
- White pine volumes are estimated 25MBF based on 8" small end DIB and 15 cords pulpwood.
- Mixed Hardwood volumes are 80% red maple and 20% white birch.
- Conversion rate for Red Pine is 2.25 tons per cord.
- Conversion rate for White Pine is 2.10 tons per cord.
- Conversion rate for Jack Pine is 2.125 tons per cord.
- Conversion rate for Mixed Hardwood is 2.3 tons per cord.

Minimum Acceptable Bid: \$42,748.50

Harvest Requirements:

Red Pine Thinning: (43 acres) Cut all trees marked in Blue Paint.

Red Pine Row Thinning: (38 acres) Cut all trees within every 3rd row. Cut row ends are marked in Blue Paint. Additional trees are painted blue within cut rows for orientation.

Sale boundaries are painted in orange.

Additional Requirements:

- Sale may be cut all season, but cut pine may not be kept on site for more than 21 days from May 1st through Aug 31st.
- Biomass harvesting is restricted. Leave all tops and limbs < 4" diameter from all trees.
- All slash must be kept clear of travel ways at all times, and out of wetlands and riparian areas. Complete slash removal within 10ft adjacent to private property boundaries and snowmobile trail edges.
- Known areas with weed infestation will be flagged by sale administrator and avoided during operations.
- Sale will be mill scaled sale and billed using the mill ticket system.
- No bid bond required, a performance bond of 15% of the total sale bid value will be required. 2 year contract period.
- Reserve all snags that do not pose a safety risk.
- Equipment must be inspected by sale administrator and clean of dirt and debris before entering sale area.
- Safety signs are required on public trails and roads entering active harvest areas.

Road and Skid Trails:

- Forest plan requires that all native surfaced approaches to paved or graveled roads have 100' of gravel put down 6 inches thick and 12' wide when used during non-frozen conditions.
- All landings and skid trails will be blocked to vehicular access and possibly re-seeded at the conclusion of use if needed.
- Temporary Roads shall have the road base constructed to a width of 12 feet or narrower, and with vegetative clearing of trees and brush not to exceed a width of 25 feet. Exceptions to the 12 foot maximum width of the road base may be granted by the sale administrator. Exceptions would typically be granted for sections of temporary roads where tight turns, curves, and terrain create a need so that trucks and equipment can be operated safely.
- Road ID W513101, FR 229B, and W510254 are temporary roads and must be restored to pre-sale condition or better and closed by earthen berm 4-5ft tall. Due to excessive ATV use and "sand country" the Washburn District utilizes logging slash/stumps/debris for **300 feet beyond the berm**. GNA sales will need to be consistent with current Washburn District Forest Service practice.
- All road maintenance and rehabilitation post-harvest is the purchaser's responsibility. A sample contract including road maintenance specifications can be obtained by request. Contact County Forester David Todus at the Sawyer County Forestry Dept. at (715)634-4846 for more information.
- For Snowmobile Trail 31 only, operations are prohibited during the spring trail closure period (March 15 through April 30), on weekends or holidays (weekends are Friday 6pm through Sunday at midnight; holidays include Memorial Day, 4th of July, Labor Day, Thanksgiving, Christmas Eve, Christmas, New Year's Eve and New Year's). Snowmobile Trail 31 may be used without restriction in the summer.