

State of Wisconsin  
 Department of Natural Resources  
[dnr.wi.gov](http://dnr.wi.gov)

### Motorized Recreation Grant Application

For: (choose all that apply)

Form 8700-159 (R 03/22)

Page 1 of 5

**Due Date: April 15**

- ATV/UTV Trail Aid
- Snowmobile Trail Aid

**Notice:** Completion of this form is required under Wisconsin Statutes 23.09(26) and 23.33. Failure to complete this form will result in denial of financial assistance. Personally identifiable information found on this form is not intended to be used for any other purpose. The Department of Natural Resources (DNR) may provide this information to requesters as required by Wisconsin's Public Records law (ss. 19.31 – 19.39, Wis. Stats.).

**Instructions:** Applications may combine more than one source of funds. They may be submitted for consideration of traditional ATV, UTV, Snowmobile and Motorized Stewardship funding. Submit one copy of all forms and attachments. See Page 2 for necessary attachments. Send applications to your Community Services Specialist.

DNR Use Only	
Category	Number

**Section 1: Applicant Information**

Applicant / Organization Name			Check Recipient: Individual other than authorized individual to act on behalf of the applicant. <input checked="" type="checkbox"/> Select if the same as applicant.		
Polk County					
Individual Authorized to Act on Behalf of Applicant per Resolution			Check Recipient Name (Name to Appear on Check)		
Benjamin Elfelt			Benjamin Elfelt		
Title			Title		
Parks and Trails Coordinator			Parks and Trails Coordinator		
Address			Address		
100 Polk County Plaza			100 Polk County Plaza		
City	State	ZIP Code	City	State	ZIP Code
Balsam Lake	WI	54810	Balsam Lake	WI	54810
Telephone Number		Email Address			
(715) 485-9170		ben.elfelt@polkcountywi.gov			

**Section 2: Project Information Required for all Projects**

Project Title					Current Funded Miles	New Miles (if applicable)
Stower Trail Funding					380.9	13.24
County	Township	Range	Section	1/4 1/4	1/4	GPS Coordinates:
Polk	N	<input type="radio"/> E <input checked="" type="radio"/> W		UN <input type="checkbox"/>	UN <input type="checkbox"/>	Lat. _____ Long. _____

**Project Description Summary**

Move the 8.51 funded miles from trail 12 (just south of the Stower trail) to the Stower.  
 and  
 Add an additional 4.73 funded miles to the Stower, to allow for the full 13.24-miles of rail trail to be funded.

I certify that all maintenance land use agreements are on file.

**Estimated Cost**

Maintenance	Acquisition	Insurance	Development	Bridge Rehab.	Trail Rehab.	Total Estimated Cost
Leave Blank – DNR Use Only						

**Applicant Certification**

Printed Name of Authorized Official	Official's Title
Benjamin Elfelt	Parks and Trails Coordinator

As the applicant's authorized official, I certify that, to the best of my knowledge, the information in this application is true and correct.

  
 Signature of Authorized Official

4/7/22  
 Date Prepared

**Appendix B – Required for Trail/Qualified Trout Rehab, Reroute, or Development**

Trail Rehab     Qualified Trout     New Trail     Trail Reroute (Mandatory or Discretionary)

County Polk	Township N	Range <input type="radio"/> E <input checked="" type="radio"/> W	Section	¼ ¼ UN	¼ UN	GPS Coordinates: Lat. Long.
----------------	---------------	--	---------	-----------	---------	-----------------------------------

Funded Trail Name or Number (SNARS if applicable) 380.9	Has this trail ever received development or rehabilitation funds in the past? <input type="radio"/> Yes <input checked="" type="radio"/> No    Year: _____ \$ _____
--	--

Trail is located on: <input type="radio"/> Private property <input checked="" type="radio"/> Public property	Length of Easement or Landowner Use Agreement _____ years	Expiration Date
---	--	-----------------

Landowner Where Trail is Located State of Wisconsin	Telephone Number (715) 485-9170
--	------------------------------------

What other recreational trail uses are planned for this trail?

This is a multi-use rail trail, like the Gandy Dancer

If there are other Recreational uses planned, how much of the trail development/rehab. cost will be paid for by other users?

How many miles would be affected if this project is not funded?	Will this result in closure of a trail? <input type="radio"/> Yes <input checked="" type="radio"/> No
---	--

Is this a critical section to the overall trail system? <input checked="" type="radio"/> Yes <input type="radio"/> No	Is there a reasonable alternative?
--	------------------------------------

Does any section of this trail contain a bridge? <input type="radio"/> Yes <input checked="" type="radio"/> No	Will this bridge require rehabilitation now or in the next few years? <input type="radio"/> Yes <input checked="" type="radio"/> No	What is the weight of your puller & drag/grading equipment? _____ lbs.
---	--	---

- Yes     No    Have you contacted your local DNR Water Management Specialist (WMS) regarding a permit?
- Yes     No    Is a permit needed? (Please provide any written correspondence from WMS.)
- Yes     No    Will this project be located near or cross any intermittent or perennial waterway? Surface Water Data Viewer
- Yes     No    Will this project be located near or cross any wetland?
- Yes     No    Will this project involve land disturbance – including clearing and grubbing – of 1 acre or more of land? (Less than 4/10th mile for a typical trail) DNR Storm Water Contact List

**Trail Project Detailed Description**

Move the 8.51 funded miles from trail 12 (just south of the Stower trail) to the Stower.  
and

Add an additional 4.73 funded miles to the Stower, to allow for the full 13.24-miles of rail trail to be funded.

# New Trail Ranking and Certification Worksheet

Segment ID: STOWER

Qualification – All items in this section must be completed for valid new miles request.

Gateways questions: Provide justification for selection below.	
<input checked="" type="checkbox"/>	1. Trail provides primary access route through a county and connects with another county's trails.
<input checked="" type="checkbox"/>	2. Trail provides access from population centers to main access trail(s).
<input checked="" type="checkbox"/>	3. Trail supports a high volume of use.
<input checked="" type="checkbox"/> Maps attached	<ul style="list-style-type: none"> <li>• Provide a current county GIS map with all requested trail segments clearly marked.</li> <li>• Provide aerial &amp; topo site maps for each segment. Include Town-Range-Section.</li> </ul>
<input checked="" type="checkbox"/> I certify that this trail meets or will meet all trail requirements in chs. 23 & 350, Wis. Stats. and ch. NR 50, Wis. Admin. Code, including the 40-foot rule regarding two-way traffic at night.	
Justification – Provide explanation for gateway qualification checked (#1, 2 or 3 above).	
<p><i>Trail trail - connects to Brown County trails</i></p> <p><i>High volume of riders</i></p>	

## Ranking

	Category	Possible Points	Actual Points
1.	Trail Longevity	Max points: 3	
	Trail segment is located on public land or private land with permanent deeded easement.	3	<del>X</del>
	Trail segment on private lands with land-use agreement (LUA) of 10 years or more.	2	
	Trail segment is on private lands with LUA of 5 years or more.	1	
	LUA of less than 5 years.	0	
2.	Trail System	Max points: 3	
	Trail segment connects two or more counties or states.	3	<del>X</del>
	Trail closes a gap in an existing N-S or E-W funded trail or extends existing funded trail 10 or more miles – excludes routes.	2	2
	Trail segment is a part of the basic county trail system.	1	
	Trail is isolated.	0	
3.	The trail segment is in the following area of mean annual snowfall	Max points: 3	
	<u>Mean Snowfall Map per County</u> (Source: Midwestern Climate Center)		
	Greater than 60 inches	3	
	48 – 60 inches	2	<del>X</del>
	Less than 48 inches	1	
4.	The ratio of miles of trail to total square miles of land within the county:	Max points: 3	
	<u>Snowmobile Trail Area Ratio per County</u>		
	The ratio is within the grouping 01% - 30%	3	
	The ratio is within the grouping 31% - 40%	2	
	The ratio is within the grouping 41% - 50%	1	<del>X</del>

5.	Trail segment will be groomed with the following equipment.	Max points: 2	
	Class A-1, A-2 includes AAA and AA	2	X
	Class A-3, A-4 includes AAA and AA	1	
	Class B or C	0	
6.	County snowmobile trail coordinator priority points. <b>Note: County is allowed 2 points maximum for ALL trail segments submitted.</b>	Max points: 2	
	High priority.	2	X
	Medium priority.	1	
	No priority.	0	
7.	<b>Deductions if trail segment contains any of the following:</b>	Max deduction: -8	
	New bridge, major bridge rehab or major trail rehab	-3	
	Trail segment is parallel (within 5 miles) to another funded segment	-3	
	Trail runs to a lake/river	-2	
(Maximum Points: 16) TOTAL			<b>13</b>

Last revised: 01/10/2019

# Polk County, Wisconsin Snowmobile Trails

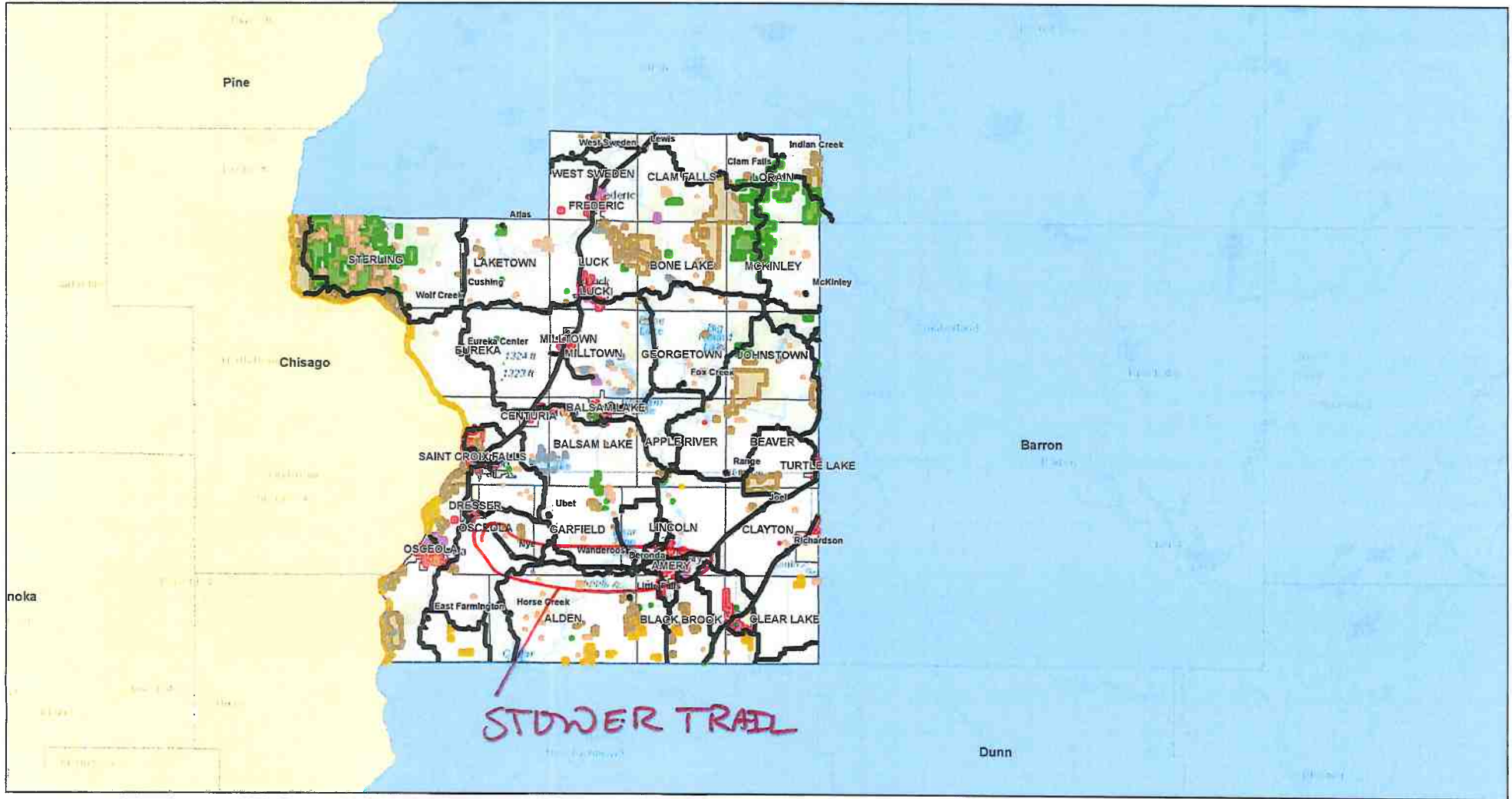

4/1/2022 1:19:50 PM

Counties

- MN
- WI
- Unincorporated Village
- CLOSED Snowmobile Trails

Snowmobile Trail

- FUNDED TRAIL
- CLUB TRAIL
- STATE TRAIL
- Public Lands - Scale Above 1:20,000
- City or Village Lands

Public Lands - Scale Below 1:19,999

- State Lands
- Town Lands
- Polk County Lands
- Federal Lands
- School Dist Lands
- Conservancy Lands
- City or Village Lands
- State Lands
- Town Lands
- Polk County Lands
- Federal Lands

School Dist Lands

- School Dist Lands
- Conservancy Lands
- Municipality
- F
- T1
- T2

1:577,791

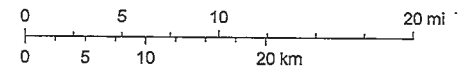

Sources: Esri, HERE, Garmin, Intermap, increment P Corp., GEBCO, USGS, FAO, NPS, NRCAN, GeoBase, IGN, Kadaster NL, Ordnance Survey, Esri Japan, METI, Esri China (Hong Kong), (c) OpenStreetMap contributors, and the GIS User Community

# Polk County, Wisconsin Snowmobile Trails

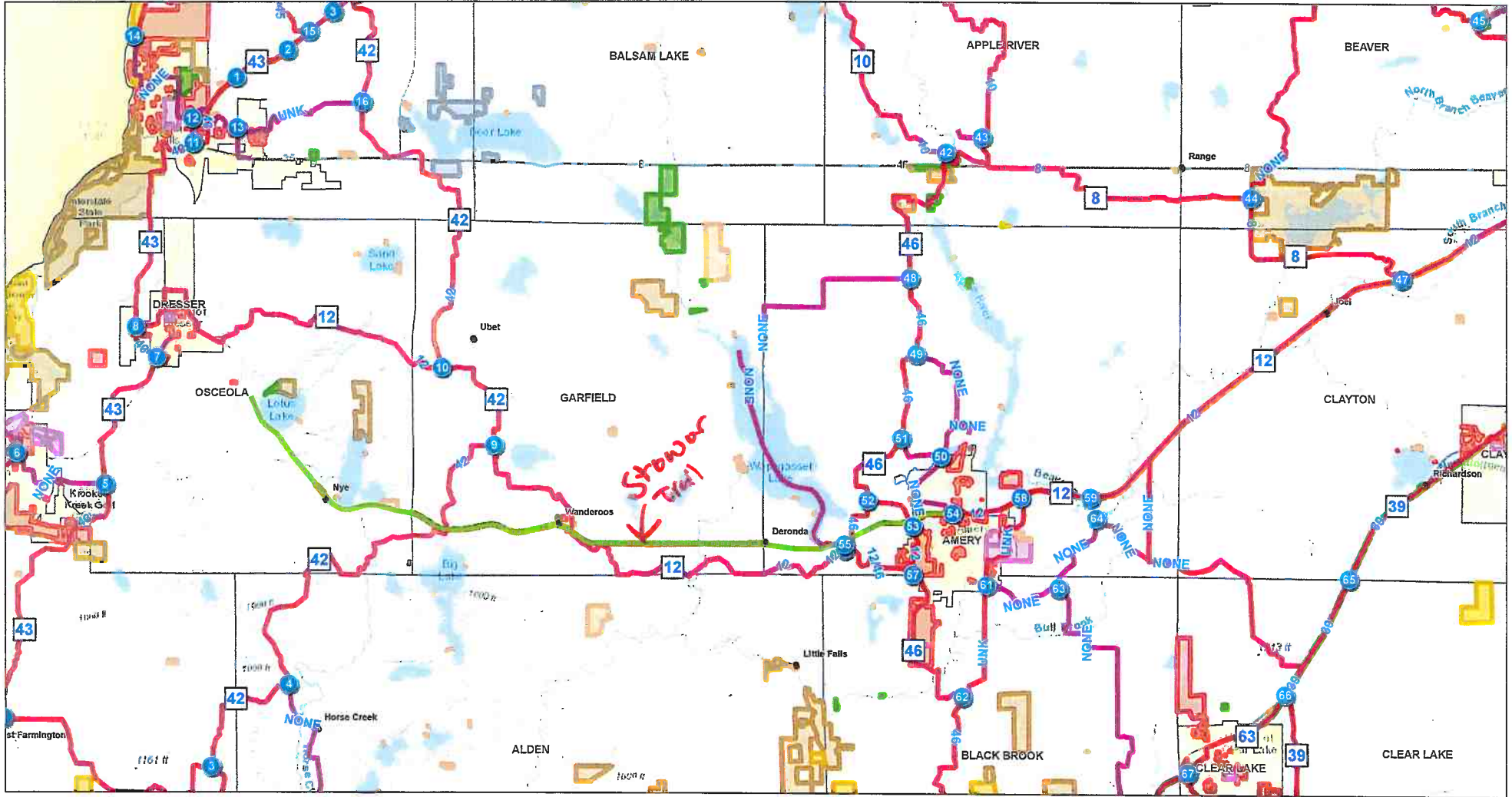

4/1/2022 1:21:39 PM

- Counties
- MN
  - Unincorporated Village
  - Trails Snowmobile Route
  - Trail Waypoint

- Snowmobile Trail
- FUNDED TRAIL
  - CLUB TRAIL
  - STATE TRAIL
- Public Lands - Scale Above 1:20,000
- City or Village Lands

- Public Lands - Scale Below 1:19,999
- State Lands
  - Town Lands
  - Polk County Lands
  - Federal Lands
  - School Dist Lands
  - Conservancy Lands

- Public Lands - Scale Below 1:19,999
- City or Village Lands
  - State Lands
  - Town Lands
  - Polk County Lands
  - Federal Lands

- School Dist Lands
- Conservancy Lands
- Municipality
- F
  - T1
  - T2

1:144,448

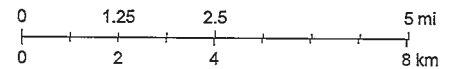

Sources: Esri, HERE, Garmin, Intermap, increment P Corp., GEBCO, USGS, FAO, NPS, NRCAN, GeoBase, IGN, Kadaster NL, Ordnance Survey, Esri Japan, METI, Esri China (Hong Kong), (c) OpenStreetMap contributors, and the GIS User Community



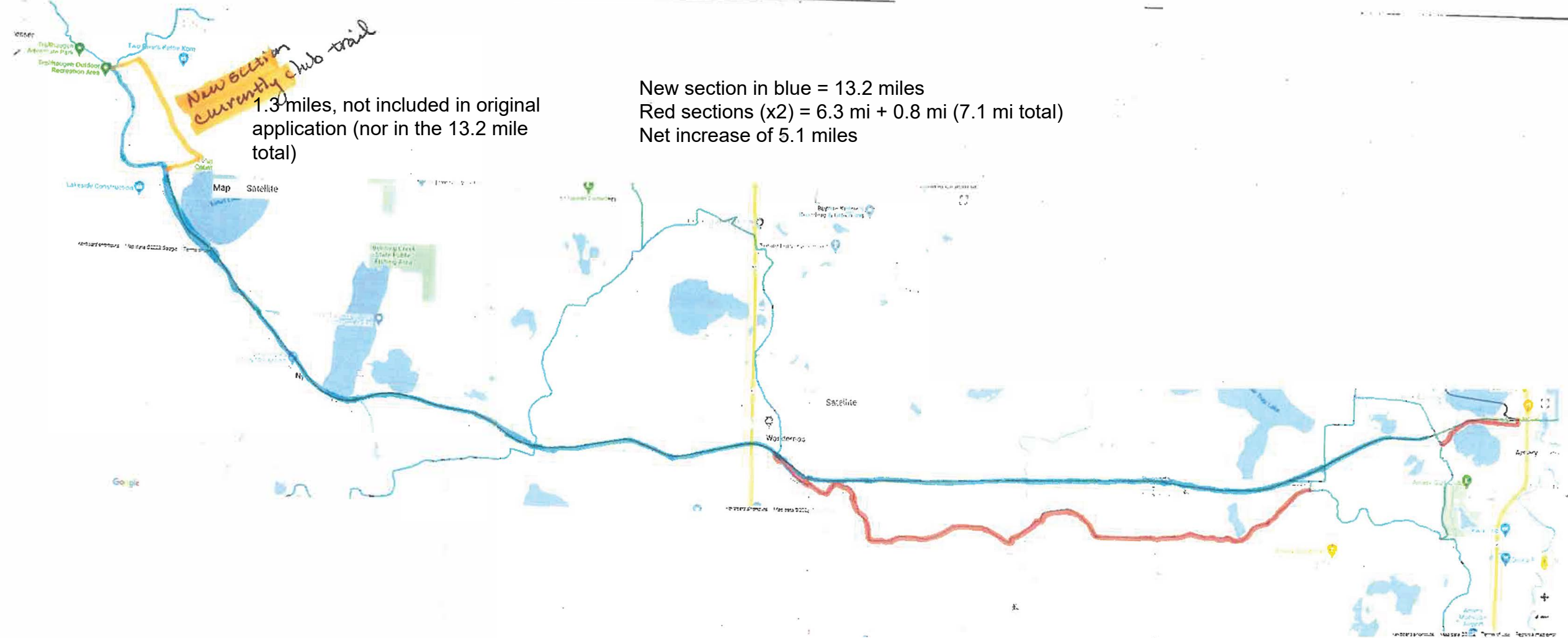

The section in blue is the new miles on the Stover Trail that should be funded. The sections in red are the pieces of Trail 12 that can be moved over onto the Stover.