

Motorized Recreation Grant Application

For: (choose all that apply)

Form 8700-159 (R 02/2024)

Due Date: April 15

ATV/UTV Trail Aid

Snowmobile Trail Aid

Notice: Completion of this form is required under Wisconsin Statutes 23.09(26) and 23.33. Failure to complete this form will result in denial of financial assistance. Personally identifiable information found on this form is not intended to be used for any other purpose. The Department of Natural Resources (DNR) may provide this information to requesters as required by Wisconsin's Public Records law (ss. 19.31 - 19.39, Wis. Stats.).

Instructions: Applications may combine more than one source of funds. They may be submitted for consideration of traditional ATV, UTV, Snowmobile and Motorized Stewardship funding. Submit one copy of all forms and attachments. See Page 2 for necessary attachments. Send applications to your Community Services Specialist.

DNR Use Only	
Category	Number

Section 1: Applicant Information

Applicant / Organization Name			Oconto County			Check Recipient: Individual other than authorized individual to act on behalf of the applicant. <input type="checkbox"/> Select if the same as applicant.		
Individual Authorized to Act on Behalf of Applicant per Resolution			Monty Brink			Check Recipient Name (Name to Appear on Check)		
Title			Forestry, Parks, Recreation Administrator			Oconto County Treasurer		
Address			301 Washington Street			Title		
City			Oconto			Treasurer		
State			WI			Address		
ZIP Code			54153			301 Washington Street		
City			Oconto			City		
State			WI			State		
ZIP Code			54153			ZIP Code		
Telephone Number			(920) 834-6995			Email Address		
						monty.brink@co.oconto.wi.us		

Section 2: Project Information Required for all Projects

Project Title						Current Funded Miles		New Miles (if applicable)	
Oconto County Riverview Trail Head Development									
County		Township	Range	Section	1/4 1/4	1/4	GPS Coordinates:		
Oconto		32 N	16	28	SE	SE	Lat. 45.21847		
							Long. -88.49609		

Project Description Summary

Oconto County has plans to construct a Park and Ride Trail-head Parking Lot with Security lighting, bathroom, pavilion, playground, ATV wash station and day use area to include grills, picnic tables, garbage cans.

I certify that all maintenance land use agreements are on file.

Estimated Cost

Maintenance	Acquisition	Insurance	Development	Bridge Rehab.	Trail Rehab.	Total Estimated Cost
			\$539,320.00			\$539,320.00
Leave Blank - DNR Use Only						

Applicant Certification

Printed Name of Authorized Official	Official's Title
Monty Brink	Forest, Parks, Recreation Administrator

As the applicant's authorized official, I certify that, to the best of my knowledge, the information in this application is true and correct.

Monty Brink
 Signature of Authorized Official

4/15/24
 Date Prepared



Building a Better World
for All of Us®

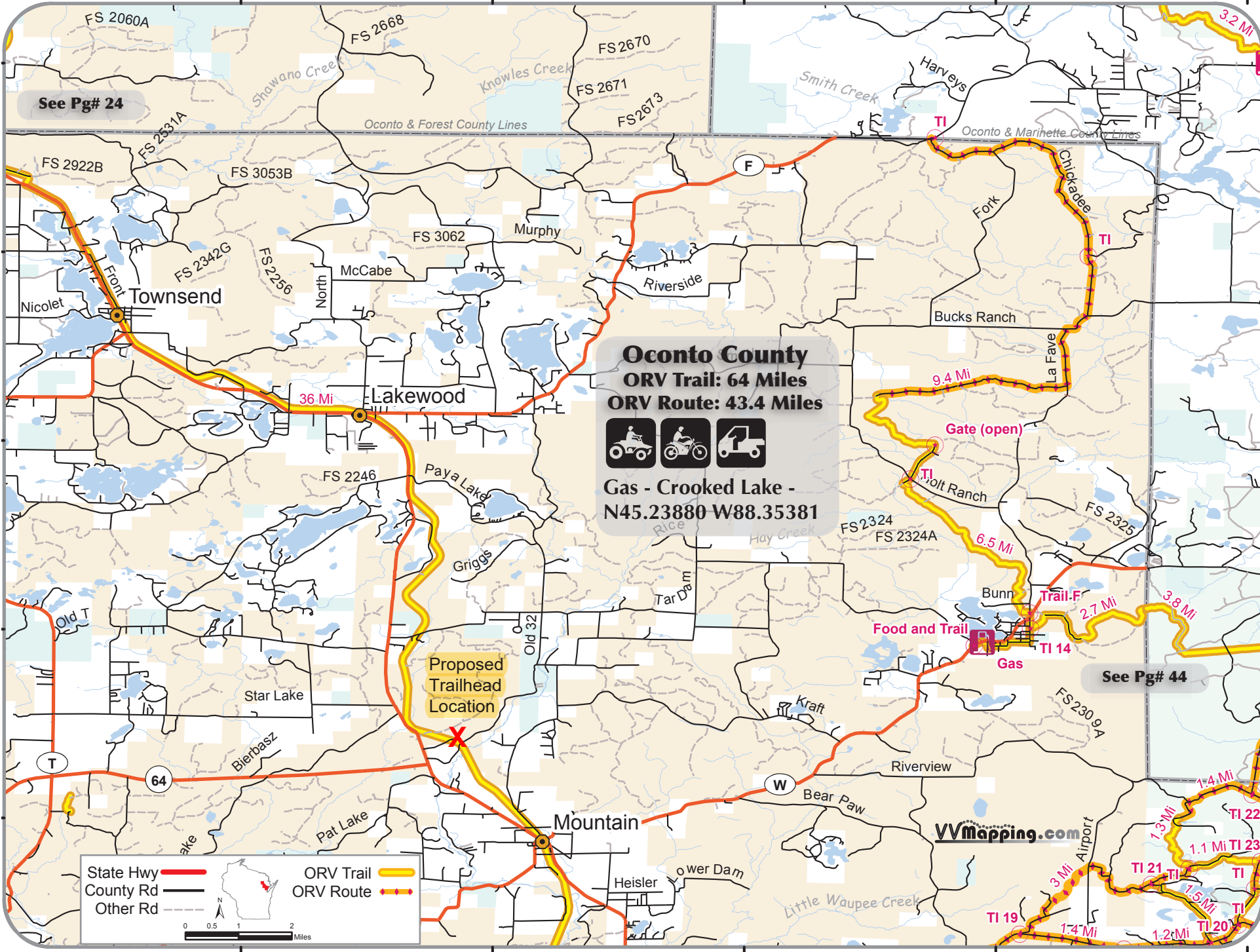





See Pg# 24

Oconto County
ORV Trail: 64 Miles
ORV Route: 43.4 Miles

Gas - Crooked Lake -
N45.23880 W88.35381

See Pg# 44

State Hwy  County Rd  Other Rd 

ORV Trail  ORV Route 

0 0.5 1 2 Miles

RIVERVIEW (W)

T.32N.-R.16E.

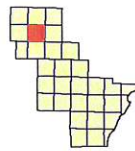

See LAKEWOOD (W) Page 66

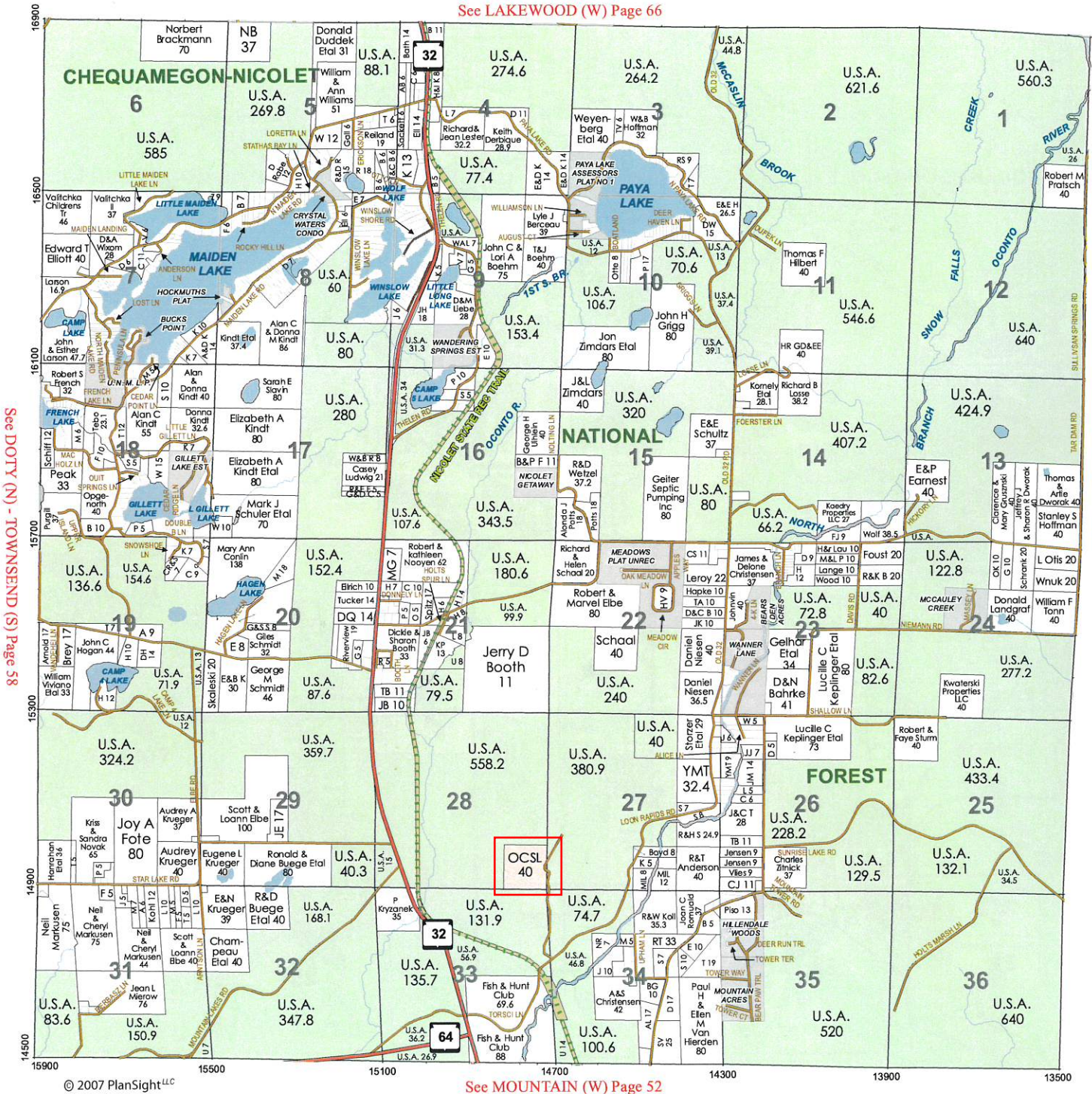

See DOTY (N) - TOWNSHIP (S) Page 58

See RIVERVIEW (E) Page 62

© 2007 PlanSight LLC

See MOUNTAIN (W) Page 52

“UP NORTH” REAL ESTATE, INC.

14140 Hwy. 32 • P.O. Box 219 • Mountain, WI 54149

Phone: (715) 276-6528

Cell: (715) 850-0897 • Fax: (715) 276-1573

www.upnorthrealestate.com

erickson@upnorthrealestate.com

Your “UP NORTH” Real Estate Connection



Don & Barb Erickson



ATV Campground Development Aerial



Legend

- Municipality
- State Boundaries
- County Boundaries
- Major Roads**
- Interstate Highway
- State Highway
- US Highway
- County and Local Roads**
- County HWY
- Local Road
- Railroads
- Tribal Lands
- Railroads
- Rivers and Streams
- Intermittent Streams
- Lakes and Open water

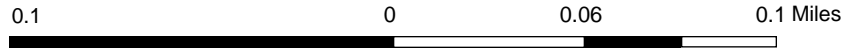

NAD_1983_HARN_Wisconsin_TM

1: 3,960

DISCLAIMER: The information shown on these maps has been obtained from various sources, and are of varying age, reliability and resolution. These maps are not intended to be used for navigation, nor are these maps an authoritative source of information about legal land ownership or public access. No warranty, expressed or implied, is made regarding accuracy, applicability for a particular use, completeness, or legality of the information depicted on this map. For more information, see the DNR Legal Notices web page: <http://dnr.wi.gov/legal/>

Notes



ATV Campground Development TOPO



- Legend**
- Municipality
 - State Boundaries
 - County Boundaries
 - Major Roads**
 - Interstate Highway
 - State Highway
 - US Highway
 - County and Local Roads**
 - County HWY
 - Local Road
 - Railroads
 - Tribal Lands
 - Rivers and Streams
 - Intermittent Streams
 - Lakes and Open water

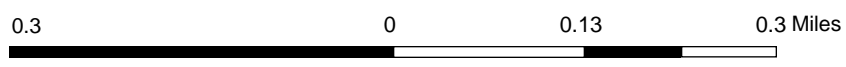
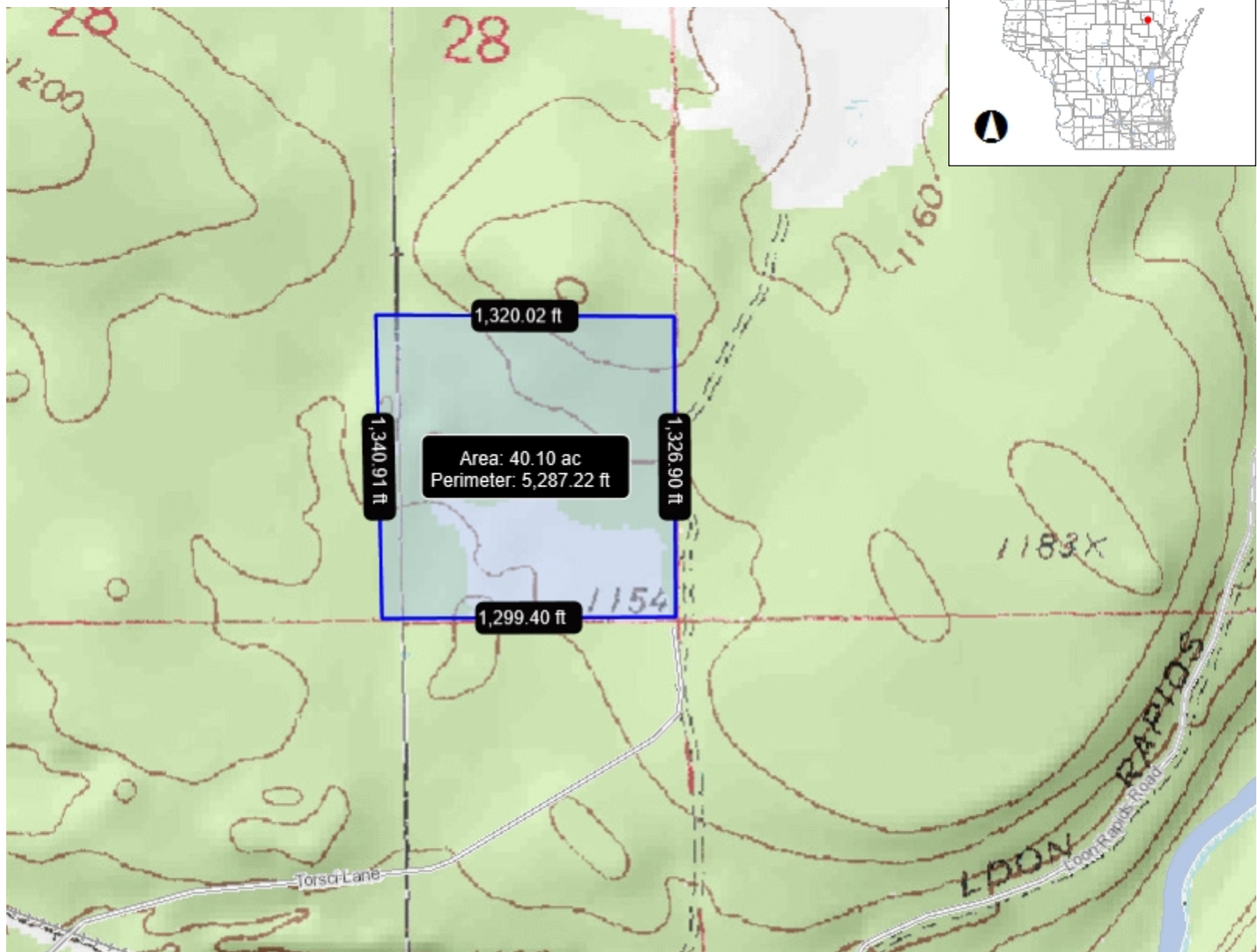

NAD_1983_HARN_Wisconsin_TM

1: 7,920

DISCLAIMER: The information shown on these maps has been obtained from various sources, and are of varying age, reliability and resolution. These maps are not intended to be used for navigation, nor are these maps an authoritative source of information about legal land ownership or public access. No warranty, expressed or implied, is made regarding accuracy, applicability for a particular use, completeness, or legality of the information depicted on this map. For more information, see the DNR Legal Notices web page: <http://dnr.wi.gov/legal/>

Notes



ATV Campground Development Wetland

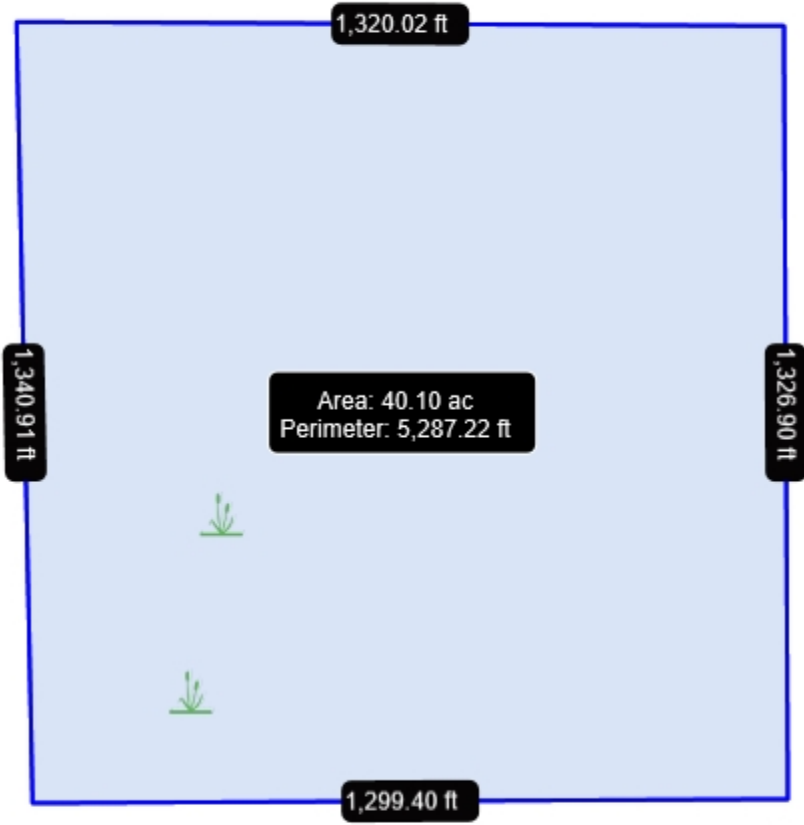

- ### Legend
- Wetland Indicators
 - Lake Class Areas
 - Riverine/ditch Class Areas
 - Wetland Class Areas
 - Wetland Class Points**
 - Dammed pond
 - Excavated pond
 - Filled/draind wetland
 - Wetland too small to delineate
 - Filled excavated pond
 - Filled Points
 - Wetland Class Areas
 - Filled Areas
 - Lake Class Areas
 - Riverine/ditch Class Areas
 - Wetland Class Areas
 - Wetland Class Points**
 - Dammed pond
 - Excavated pond
 - Filled/draind wetland
 - Wetland too small to delineate
 - Filled excavated pond
 - Filled Points
 - Wetland Class Areas
 - Filled Areas
 - Waterway and Wetland Alterations
 - Formal/Informal Actions
 - Exemption Determinations
 - Ordinary High Water Mark Determinations
 - Wetland Identifications and Confirmations
 - Navigability Determinations**
 - Yes

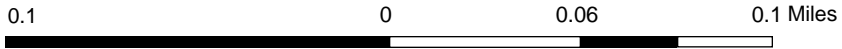

NAD_1983_HARN_Wisconsin_TM

1: 3,960

DISCLAIMER: The information shown on these maps has been obtained from various sources, and are of varying age, reliability and resolution. These maps are not intended to be used for navigation, nor are these maps an authoritative source of information about legal land ownership or public access. No warranty, expressed or implied, is made regarding accuracy, applicability for a particular use, completeness, or legality of the information depicted on this map. For more information, see the DNR Legal Notices web page: <http://dnr.wi.gov/legal/>

Notes